

CERTIFIED CORNER RECORDATION

Corner N 1/16 S17 T. 29 N. R. 27 W. P.M.M. Lincoln County

I. Record: None

II. Found: No monument or accessories found during area search.

III. Perpetuation: At the corner point, determined by survey, set a 5/8 ins. diam. steel rebor 24 ins. long 22 ins. in the ground, with a 3 1/4 ins. diam. Aluminum cap marked as shown below from which:

- A pine, 8 ins. diam., bears N. 71° E., 9.25 ft. dist., scribed N 1/16 S17 BT.
- A pine, 6 ins. diam., bears S. 28° W., 20.70 ft. dist., scribed N 1/16 S18 BT.

Painted faces and 6 in. wide red bands to all bearing trees and attached Land Survey Monument and Bearing Tree signs.

Set a steel post on line 3 ft. East of set monument with U.S.F.S Property line and Survey monument stickers.

Magnetic declination: 18° East

Equipment used: Hand compass and loggers tape

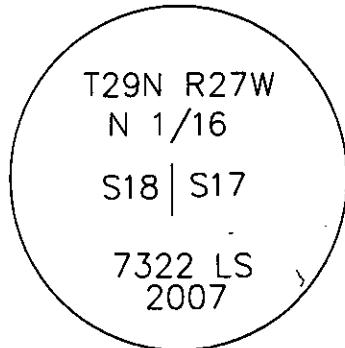

Kootenai Surveyors Inc., 314 California Av., Libby, MT. 59923 (406) 293-4354

Redeemed Big 8- PCTC

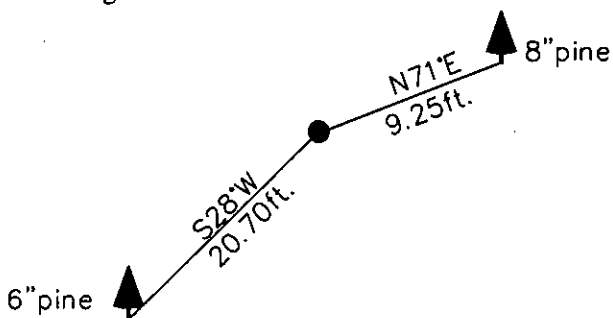

SKETCH OF CORNER

CERTIFICATION

Kelly Rooney
I certify the information shown here is true and correct.

Kelly Rooney
Signature Ground Party Chief

Alvah F. Hughes
I certify that this Corner Record correctly represents work performed by me or under my direction in compliance with the "Corner Recordation Act" (70-22-101) of the State of Montana.

Alvah F. Hughes
Signature of Surveyor & Seal

Date: 1/17/2007 Reg. No. 7322-LS

Employer: Kootenai Surveyors Inc.

Office of Clerk and Recorder, County of Lincoln This "corner

record" was filed for record 200802 BOOK: CCR CC&R'S PAGE: 11007 Pages: 1

was noted on the cross-index STATE OF MONTANA LINCOLN COUNTY RECORDED: 02/06/2007 1:02 KOI: CC&R'S

book No. _____ TAMMY D. LAUER CLERK AND RECORDER

FEE: \$0.00

BY: *Tammy D. Lauer*

TO: FILED

Cross Index No. K 05 T. 29N R. 27W P.M., MT

Sec.17

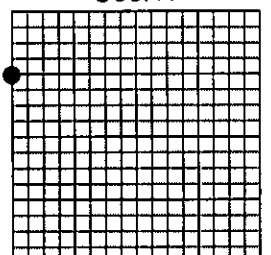

• corner this sheet

Adopted July 1, 1981, Montana Board of Professional Engineers & Land Surveyors