

CERTIFIED CORNER RECORDATION

Corner SW COR. S7 T 29 N. R. 27 W. P.M.M. Lincoln County

I. Record: 1893 original GLO survey by J. Keerl and A. Jaqueth: Set a trachite stone 20x7x5 ins.15 ins. in the ground, marked with 4 notches on the S. and 2 notches on the N. edges, from which:

A tamarck, 24 ins. diam., bears N.48° E., 66 lks. dist. (43.56 ft.) mkd. T29N R27W S7 BT.  
A tamarck, 24 ins. diam., bears S. 61° E., 60 lks. dist. (39.60 ft.) mkd. T29N R27W S18 BT.  
A pine, 32 ins. diam., bears S. 48° W., 33 lks. dist. (21.78 ft.) mkd. T29N R27W S13 BT.  
A pine, 24 ins. diam., bears N. 51° W., 49 lks. dist. (32.34 ft.) mkd. T29N R27W S12 BT.

1970 Certified Corner Rec. Bk. 1 Page 163 Lincoln County records by R. Burdick 149-S : Set a 2 ins. diam. iron pipe 24 ins. in the ground with brass cap at the exact center point from found original bearing trees, from which:

A larch, 20 ins. diam., bears S.61° E., 39.60 ft. dist. with visible scribing.  
A larch stump, 28 ins. diam., bears N.48° E., 43.56 ft. dist. with no visible scribing.

II. Found: A 2 ins. diam. iron pipe with brass cap firmly set marked as shown below from which:

A larch stump, 31 ins. diam., bears N.48° E., 43.56 ft. dist. with visible scribing.  
A larch, 25 ins. diam., bears S.61° E., 39.60 ft. dist. with healed face.

III. Perpetuation: Establish one bearing tree described below:

A pine, 8 ins. diam., bears N. 19° E., 18.17 ft. dist., mkd. T29N R27W CC S7 BT.

Painted faces and 6 in. wide red bands to all bearing trees and attached Land Survey Monument and Bearing Tree signs.

Set a steel post on line 3 ft. North of found monument.

Raise a mound of stone around found monument.

Magnetic declination: 18° East

Equipment used: Hand compass and loggers tape

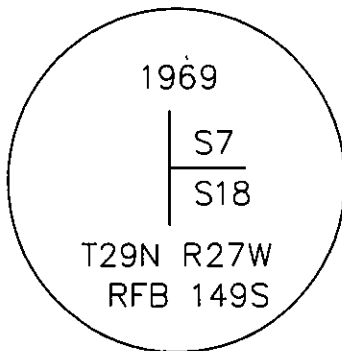

Kootenai Surveyors Inc., 314 California Av., Libby, MT. 59923 (406) 293-4354

Redeemed Big 8- PCTC

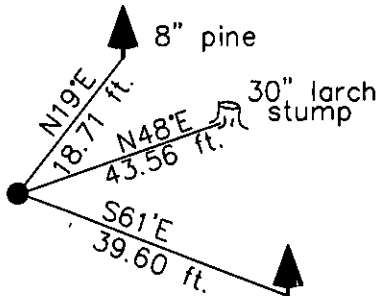

SKETCH OF CORNER

CERTIFICATION

I, Kelly Rooney  
certify the information shown herein is true and correct.  
*Kelly Rooney*  
Signature Ground Party Chief

I, Alvah F. Hughes  
certify that this Corner Record correctly represents work performed by me or under my direction in compliance with the Corner Recordation Act (70-22-101, et seq., M.C.A.)  
*Alvah F. Hughes*  
Signature of Surveyor  
Date: 12/20/2006 Reg. No. 7322-LS  
Employer: Kootenai Surveyors Inc.

Office of Clerk and Recorder, County of Lincoln This "corner

record" was filed for record c 200801 BOOK: CCR CC&R'S PAGE: 11006 Pages: 1  
was noted on the cross-index STATE OF MONTANA LINCOLN COUNTY  
book No. RECORDED: 02/06/2007 1:01 KOI: CC&R'S  
TAMMY D. LAUER CLERK AND RECORDER  
FEE: \$0.00 BY: *Tammy D. Lauer*  
TO: FILED

Cross Index No. J 01 T 29N R. 27W P.M., MT

Adopted July 1, 1981, Montana Board of Professional Engineers & Land Surveyors

Sec. 7

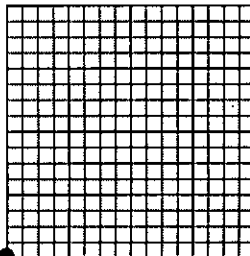

• corner this sheet