

CERTIFIED CORNER RECORDATION

Corner E 1/4 Sec. 13 T. 29N R. 26W P.M., MT Lincoln County

I. 1893 G.L.O. Original Record by P. McCardell et. al.: Set a sandstone, 12X8X6 ins., 8 ins. in the ground, for 1/4 sec. cor. mkd. "1/4" on the N. face.

Established two bearing trees:

A larch, 12 ins. diam., bears S13°E, 10 lks. dist., mkd. "1/4 S BT".

A yellow pine, 14 ins. diam., bears N38°W, 17 lks. dist., mkd. "1/4 S BT".

1932 B.L.M. Resurvey of the Horse Plains Guide Meridian by Fred L. Cumming et. al.: Intersect the old 1/4 sec. cor., which is a sandstone, firmly set, mkd. and witnessed as described in the original record, except that the N.W. tree is dead. This corner will hereafter refer to sec. 13 only. Effaced the markings from the old tree in sec. 18.

Established two new bearing trees:

A lodgepole pine, 10 ins. diam., bears S88°W, 42 lks. dist., mkd. "1/4 S13 BT".

A fir, 10 ins. diam., bears N48 3/4°W, 40 lks. dist., mkd. "1/4 S13 BT".

1982 B.L.M. Remonumentation Record by Cruz D. Almanza: The 1/4 sec. cor. of sec. 13, only, monumented with a sandstone, firmly set, mkd. as described in the original record and witnessed by the 1932 N.W. bearing tree. The S.W. bearing tree is dead. At the corner point, set an aluminum post, 30 ins. long, 2 1/2 ins. in diam., 22 ins. in the ground, with aluminum cap mkd as shown:

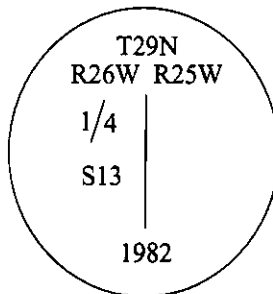

Established one new bearing tree:

A fir, 6 ins. diam., bears S68 1/4°W, 30 lks. dist., mkd. "X" "BT".

Bury the original stone alongside and raise a collar of stone, 3 ft. diam., around the aluminum post.

1983 Certified Corner Recordation by William Condrey No. 5425S. Found a 2 1/2 in. diam. aluminum post, with cap mkd. as described in the 1982 BLM record and witnessed by the N.W. bearing tree, set in 1932 and the S.W. bearing tree, set in 1982.

II. Found a 2 1/2 in. diam. aluminum pipe, protruding 10 ins. above a mound of stone, with a 3 1/4 in. diam. aluminum cap mkd. as shown above.

from which:
A burned dead fir, 7 ins. diam., bears S68°W, 30 lks. (19.8) ft. dist., mkd. with a healed face." (1982 BLM-record)

A burned fir stump, 26 ins. diam., bears N49°W, 40 lks. (26.4) ft. dist., (1932 BLM-record)

III. No suitable trees within limits, therefore, from the corner point, I set two posts:

A 6 ft. steel guard post, bears North, on property line, 3.4 ft. dist.

A 6 ft. steel guard post, bears South, on property line, 3.4 ft. dist.

Built up a mound of stone around the monument, 1.5 ft. high, 2 ins. in diam.

Attached Land Survey Monument and Property Boundary decals to the guard posts.

Magnetic Declination: 20° East.

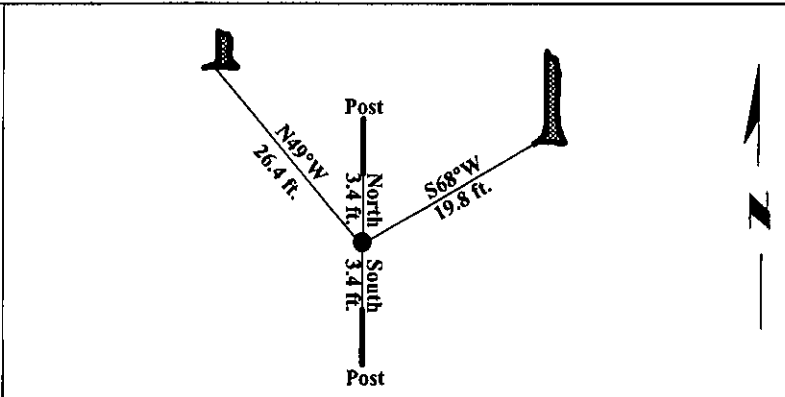
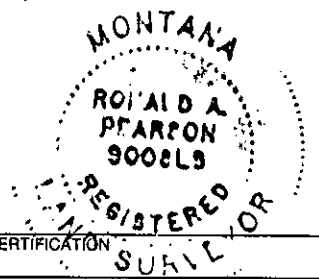

SKETCH OF CORNER

CERTIFICATION

I, Rex O. Rice
certify the information shown herein is true and correct.

I, Ronald A. Pearson
certify that this Corner Record correctly represents work performed by me or under my direction in compliance with the "Corner Recordation Act" (70-22-101, et seq., M.C.A.)

Signature of Surveyor & Seal

Date: 12/30/96

Reg. No.: 9008LS

Employer: U.S. FOREST SERVICE

Office of Clerk and Recorder, County of LINCOLN. This "corner record" was filed for record on FEB 3, 1997 was noted on the cross-index plat and is assigned page No. 9055,

in book No. _____

CORAL M. CUMMINGS

County Official

Sec. 13



• - corner this sheet