

# CERTIFIED CORNER RECORDATION

Corner 1/4 Sec. 11&12 T. 29N R. 26W P.M., MT Lincoln County

I. 1893 G.L.O. Original Record by James S. Keerl et. al.: Set a sandstone, 16X10X9 ins., 11 ins. in the ground for 1/4 sec. cor. mkd. "1/4" on the W. face.

Established two bearing trees:

- A fir, 15 ins. diam., bears N56°E, 21 lks. dist., mkd. "1/4 S BT".
- A fir, 10 ins. diam., bears N40°W, 8 lks. dist., mkd. "1/4 S BT".

1982 B.L.M. Remonumentation Record by Cruz D. Almanza: The 1/4 sec. cor. of secs. 11 and 12, monumented with a sandstone, 16x8x5 ins., firmly set, mkd. as described in the original record and witnessed by the remains of the original bearing trees. At the corner point, set an aluminum post, 30 ins. long, 2 1/2 ins. in diam., 22 ins. in the ground, with aluminum cap mkd. as shown:

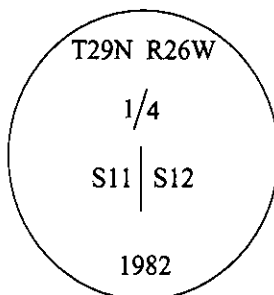

Established one new bearing tree:

- A larch, 6 ins. diam., bears N39 1/2°W, 52 lks. dist., mkd. "1/4 S11 BT".

Bury the original stone alongside and raise a collar of stone, 3 ft. diam., around the aluminum post.

1982 Certified Corner Recordation by William Condrey No. 5425S: Found a 2 1/2 in. diam. aluminum pipe, with BLM aluminum cap and witnessed by both original bearing trees. Set a fiberglass post alongside the corner.

II. Found a 2 1/2 in. diam. aluminum pipe, flush with a rock collar, with a 3 1/4 in. diam. aluminum cap mkd. as shown above. from which:

- A fir, bears N56°E, 14.3 ft. dist., (GLO-record 21 lks.-"13.8 ft.")
- A larch, bears N39 1/2°W, 34.5 ft. dist., (BLM-record)
- Both bearing trees burnt, due to fire.

III. No suitable trees within limits, therefore, from the corner point, I set two posts.

- A 6 ft. steel guard post, bears North, on property line, 2.1 ft. dist.
- A 6 ft. steel guard post, bears South, on property line, 2.3 ft. dist.

Attached Land Survey Monument and Property Boundary decals to the guard posts.

Magnetic Declination: 20° East.

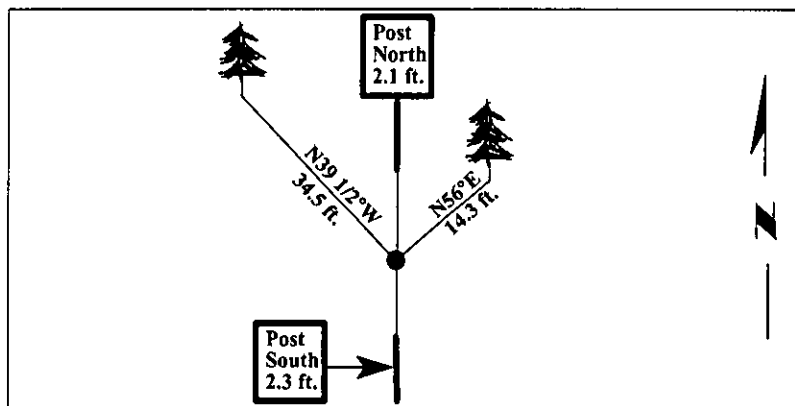
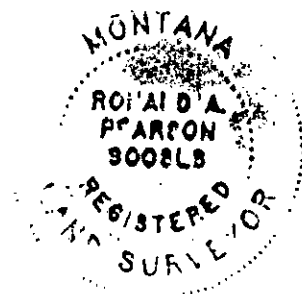

**SKETCH OF CORNER**

CERTIFICATION

I, Jeffery Hintz  
certify the information shown herein is true and correct.

---

I, Ronald A. Pearson  
certify that this Corner Record correctly represents work performed by me or under my direction in compliance with the "Corner Recordation Act" (70-22-101, et seq., M.C.A.)

*Ronald A. Pearson*  
Signature of Surveyor & Seal

Date: 12/30/96

Reg. No.: 9008LS

Employer: U.S. FOREST SERVICE

Office of Clerk and Recorder, County of LINCOLN. This "corner record" was filed for record on FEB 3, 1997 was noted on the cross-index plat and is assigned page No. 9053, in book No. \_\_\_\_\_

CORAL M. CUMMINGS  
County Official

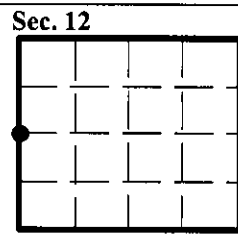

● - corner this sheet