

CERTIFIED CORNER RECORDATION

Corner 1/4 Sec. 1&12 T. 29N R. 26W P.M., MT Lincoln County

I. 1893 G.L.O. Original Record by James S. Keerl et. al.: Set a limestone, 15x10x5 ins., 10 ins. in the ground, for 1/4 sec. cor., mkd. "1/4" on the N. face.

Established two bearing trees:

A larch, 26 ins. diam., bears S10°W, 64 lks. dist., mkd. "1/4 S BT".
A fir, 12 ins. diam., bears N55°W, 7 lks. dist., mkd. "1/4 S BT".

1980 Certified Corner Recordation by Daniel C. Smiley No. 3526-ES: Found a loose stone 13x10x4 ins., mkd. "1/4" on a face, witnessed by the original S.W. bearing tree. No evidence of the N.W. bearing tree. Stone appears to have been disturbed recently and bears Northeasterly approx. 5 ft. from corner position established from original evidence. Establish the position for this coner from the GLO record bearing and distance from the foudm original 26 in. larch bearing tree. Set a aluminum pipe, 30 ins. long, 2 1/2 ins. in diam., 20 ins. in the ground, with a collar of stone, cap mkd. as shown:

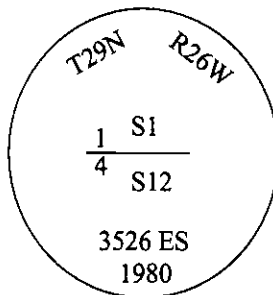

Established two new bearing trees:

A lodgepole pine, 5 ins. diam., bears N12°E, 14.1 ft. dist., mkd. "1/4 S1 RM".
A lodgepole pine, 8 ins. diam., bears N62°W, 6.0 ft. dist., with a location poster attached.

II. Found a 2 1/2 in. diam. aluminum pipe, flush with rock collar, with a 3 in. diam. aluminum cap mkd. as shown above.

from which:

A lodgepole, 5 ins. diam., bears N12°E, 14.1 ft. dist. (1980-record mkd. "1/4 S1 RM")
A lodgepole, 8 ins. diam., bears N62°W, with a location poster attached. (1980-record 6.0 ft.)

III. No suitable trees within limits, therefore, from the corner position, I set two posts.

A 6 ft. steel guard post, bears West, on property line, 4.8 ft. dist.
A 6 ft. steel guard post, bears East, on property line, 3.4 ft. dist.

Painted bearing trees and attached Land Survey Monument and Bearing Tree signs.
Attached Land Survey Monument and Property Boundary decals to the guard posts.

Magnetic Declination: 20° East.

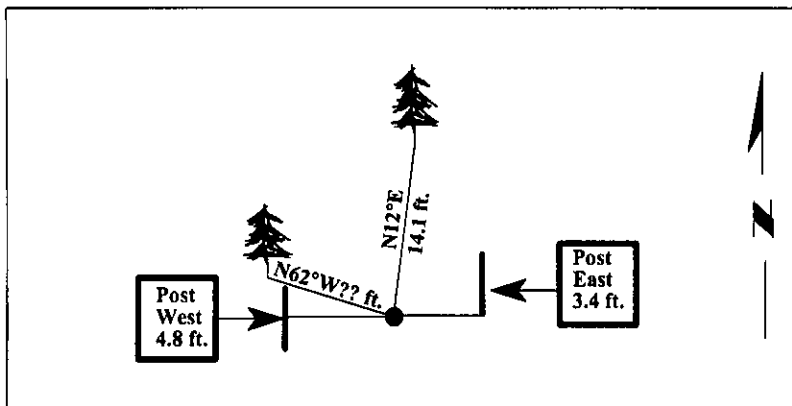

SKETCH OF CORNER

CERTIFICATION

I, Jeffery Hintz
certify the information shown herein is true and correct.

I, Ronald A. Pearson
certify that this Corner Record correctly represents work performed by me or under my direction in compliance with the "Corner Recordation Act" (70-22-101, et seq., M.C.A.)

Signature of Surveyor & Seal

Date: 12/30/96

Reg. No.: 9008LS

Employer: U.S. FOREST SERVICE

Office of Clerk and Recorder, County of LINCOLN. This "corner record" was filed for record on FEB 3, 1997 was noted on the cross-index plat and is assigned page No. 9050, in book No. CORAL M. CUMMINGS

County Official

Sec. 12

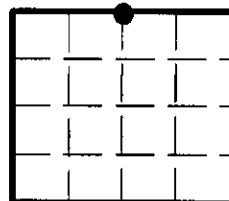

● - corner this sheet