

CERTIFIED CORNER RECORDATION

Corner	1/4	Sec. 1&2	T. 29N	R. 26W	P.M., MT	Lincoln	County
--------	-----	----------	--------	--------	----------	---------	--------

I. 1893 G.L.O. Original Record by James S. Keerl et. al.: Set a limestone, 12x8x6 ins., 8 ins. in the ground, for 1/4 sec. cor., mkd. "1/4" on the W. face.

Established two bearing trees:

A larch, 30 ins. diam., bears N44°E, 43 lks. dist., mkd. "1/4 S BT".

A fir, 8 ins. diam., bears S53°W, 27 lks. dist., mkd. "1/4 S BT".

1982 B.L.M. Remonumentation Record by Cruz D. Almanza: For the 1/4 sec. cor. of secs. 1 & 2, monumented with a limestone, 12x8x6 ins., firmly set 8 ins. in the ground, mkd. "1/4" on the W. face, witnessed by the remains of one original bearing tree. Set an alum. post, 30 ins. long, 2 1/2 ins. in diam., 22 ins. in the ground, with the aluminum cap mkd. as shown:

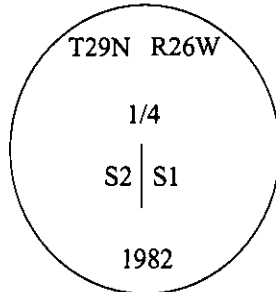

Established one new bearing tree:

A larch, 6 ins. diam., bears N60 1/2°W, 7 lks. dist., mkd. "1/4 S2 BT".

Buried original stone alongside the aluminum post and raised a 2 ft. diam. collar of stone.

1982 Certified Corner Recordation by William Condrey No. 5425S: Found an aluminum post, 2 1/2 ins. in diam., with a BLM aluminum cap, witnessed by both BLM bearing trees, mkd. as described in the 1982 BLM record. Set a fiberglass post alongside of corner.

II. Found a 2 1/2 in. diam. aluminum pipe, flush with rocks, with a 3 1/4 in. diam. aluminum cap mkd. as shown above.

from which:

A larch, 38 ins. diam., bears N44°E, 28.4 ft. dist. (GLO-record mkd. "1/4 S BT".)

A larch, 5 ins. diam., bears N60 1/2°W, 4.6 ft. dist. (BLM-record mkd. "1/4 S2 BT".)

Bearing trees burnt, due to fire.

III. No suitable trees within limits, therefore, from the corner position, I set two posts.

A 6 ft. steel guard post, bears South, on property line, 2.85 ft. dist.

A 6 ft. steel guard post, bears North, on property line, 2.7 ft. dist.

Painted bearing trees and attached Land Survey Monument and Bearing Tree signs.
Attached Land Survey Monument and Property Boundary decals to the guard posts.

Magnetic Declination: 20° East.

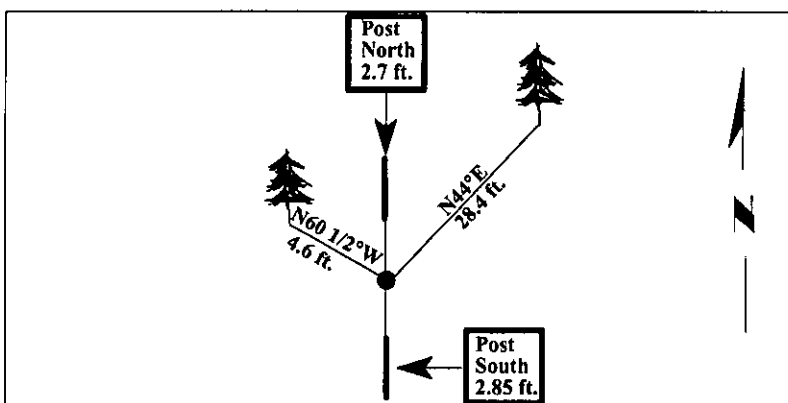

SKETCH OF CORNER

CERTIFICATION

I, Jeffery Hintz
certify the information shown herein is true and correct.

I, Ronald A. Pearson
certify that this Corner Record correctly represents work performed by me or under my direction in compliance with the "Corner Recordation Act" (70-22-101, et seq., M.C.A.)

Signature of Surveyor & Seal

Date: 12/30/96

Reg. No.: 9008LS

Employer: U.S. FOREST SERVICE

Office of Clerk and Recorder, County of LINCOLN. This "corner record" was filed for record on FEB 3 1997 was noted on the cross-index plat and is assigned page No. 9049, in book No. CORAL M. CUMMINGS

County Official [Signature]

Sec. 1

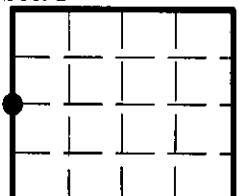

● - corner this sheet

Cross Index No. C-21 T. 29N R. 26W P.M., MT