

# CERTIFIED CORNER RECORDATION

Corner 1/4 Sec. 2&11 T. 29N R. 26W P.M., MT Lincoln County

- I. 1893 G.L.O. Original Record by James S. Keerl et. al.: Set a limestone, 16x10x6 ins., 11 ins. in the ground, for 1/4 sec. cor., mkd. "1/4" on the N. face.

Established two bearing trees:

A larch, 24 ins. diam., bears S43°E, 55 lks. dist., mkd. "1/4 S BT".

A white pine, 10 ins. diam., bears N53°W, 14 lks. dist., mkd. "1/4 S BT".

1982 B.L.M. Remonumentation Record by Cruz D. Almanza: For the 1/4 sec. cor. of secs. 2 & 11, monumented with a limestone, 16x10x6 ins., firmly set, 11 ins. in the ground, mkd. "1/4" on the N. face and witnessed by the remains of the original S.E. bearing tree. Set an aluminum post, 30 ins. long, 2 1/2 ins. in diam., 22 ins. in the ground, with aluminum cap mkd. as shown:

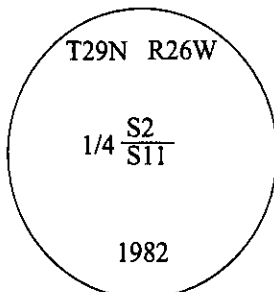

Established two new bearing trees:

A fir, 6 ins. diam., bears S60 1/4°W, 24 lks. dist., mkd. "1/4 S11 BT".

A larch, 6 ins. diam., bears N11 3/4°W, 62 lks. dist., mkd. "1/4 S2 BT".

Bury the original stone alongside the aluminum post.

1982 Certified Corner Recordation by William Condrey No. 5425S: Found aluminum post, 2 1/2 ins. in diam., with a BLM aluminum cap, witnessed by both BLM bearing trees, mkd. as described in the BLM records. Set a fiberglass post alongside of corner.

- II. Found a 2 1/2 in. diam. aluminum pipe, protruding 6 ins. above the ground, with a 3 1/4 in. diam. aluminum cap mkd. as shown above.

from which:

A fir, 6 ins. diam., bears S60°W, 16.0 ft. dist. (BLM-record mkd. "1/4 S11 BT".)

A larch, 6 ins. diam., bears N12°W, 41.0 ft. dist. (BLM-record mkd. "1/4 S2 BT".)

Bearing trees burnt, due to fire.

- III. No suitable trees within limits, therefore, from the corner position, I set two posts.

A 6 ft. steel guard post, bears East, on property line, 5.8 ft. dist.

A 6 ft. steel guard post, bears West, on property line, 4.2 ft. dist.

Painted bearing trees and attached Land Survey Monument and Bearing Tree signs.

Attached Land Survey Monument and Property Boundary decals to the guard posts.

Magnetic Declination: 20° East.

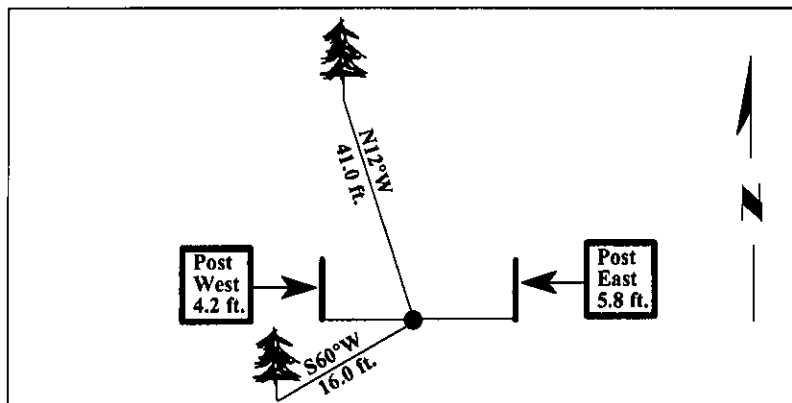

SKETCH OF CORNER

## CERTIFICATION

I, Jeffery Hintz

certify the information shown herein is true and correct.

I, Ronald A. Pearson

certify that this Corner Record correctly represents work performed by me or under my direction in compliance with the "Corner Recordation Act" (70-22-101, et seq., M.C.A.)

Signature of Surveyor & Seal

Date: 12/30/96

Reg. No.: 9008LS

Employer: U.S. FOREST SERVICE

Sec. 11

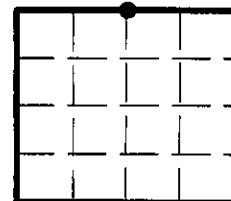

• - corner this sheet

Office of Clerk and Recorder, County of LINCOLN. This "corner record" was filed for record

on FEB 3, 1997 was noted on the cross-index plat and is assigned page No. 9048,

in book No. \_\_\_\_\_

CORAL M. CUMMINGS

County Official

Cross Index No.

E-19

T.

29N

R.

26W

P.M., MT