

## INSTRUCTIONS

1. Original and/or subsequent record used to evaluate the corner position.
2. Description of evidence found, note discrepancies in the record, state method of establishing lost or obliterated corners.
3. Description of monument and accessories set to perpetuate the corner position.
4. Sketch or corner, show all pertinent data which can best be shown in a sketch example, corner marking, topography ties, position of accessories, etc.
5. Certification must be signed and sealed by Registered Land Surveyor in State of Montana.
6. Fill in Cross Index & Section Diagram at bottom of sheet.

## CERTIFIED CORNER RECORDATION

Corner W.C. to NW Cor. S14 T. 29N. R. 26W P.M.M. Lincoln County

- I. Original Record 1893 - Set a sandstone 14x12x10 ins. 10 ins. in the ground for Corner to Sections 10, 11, 14 & 15 marked with 4 notches on S and 2 notches on E edges from which: An alder 6 ins. diam. bears N17½°E, 22 lks. dist. marked T29N R26W S11 BT. A fir 12 ins. diam. bears S48°E, 69 lks. dist. marked T29N R26W S14 BT. A spruce 6 ins. diam. bears S80°N, 34 lks. dist. marked T29N R26W S15 BT. An alder 6 ins. diam. bears N39°W, 17 lks. dist. marked T29N R26W S10 BT.
- II. No trace of original marked stone found. Found remains of a rotted tree and stump which appears to be the S15 BT. Creek channel is as described in original notes. Re-establish cor. position from calls to creek and this checks with rotted BT. I accept this position for the true corner and because it falls in edge of Little Wolf Cr., I set a witness corner as follows:
- III. Set an alum. pipe 30" long, 2½" diam., 24" in ground, with 3" Alum. cap marked as shown below from which: A 10" spruce bears N43°E a dist. of 10.9 ft. marked X BT. A 10" spruce, bears N10°W a dist. of 57.0 ft. marked X BT. A 10" spruce, bears S80°W a dist. of 31.0 ft. marked X BT. A 18" spruce, bears S3°W a dist. of 8.1 ft. marked X BT.
- Placed signs, painted BT's and set carsonite post near corner.

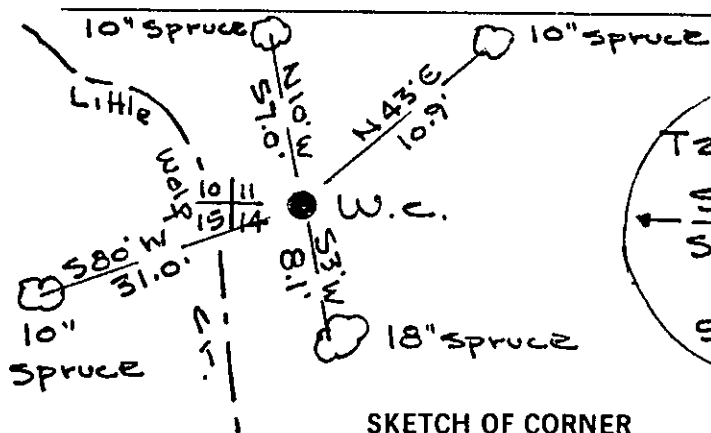
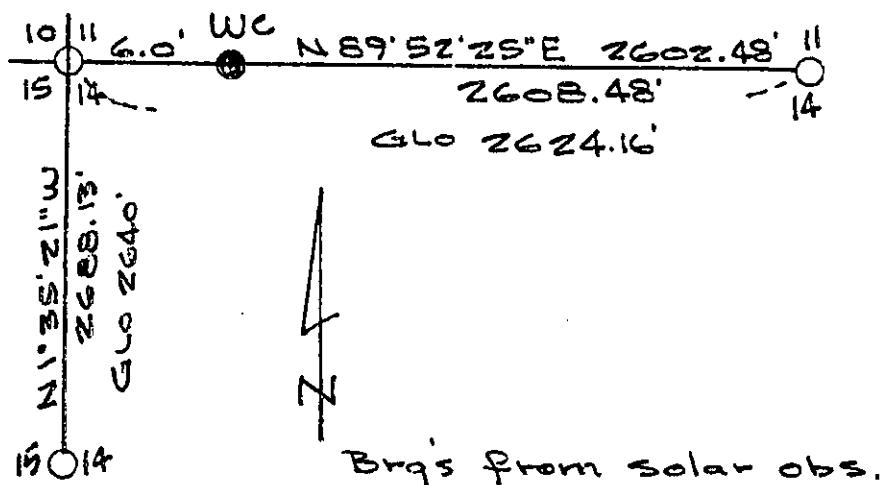

SKETCH OF CORNER

## CERTIFICATION

I, \_\_\_\_\_  
certify the information shown hereby is true and correct.

Signature Ground Party Chief

William Condrey

I, \_\_\_\_\_  
certify that this Corner Record correctly represents work performed by me or under my direction in compliance with the "Corner Recordation Act" (70-22-10), et seq., M.D.A.

Signature of Surveyor & Seal

Date: 6-27-83 Reg. No. 5425 S

Employer: Associated Surveys, Inc.

Office of Clerk and Recorder, County of Lincoln. This "corner record" was filed for record on the August 25th day of 1983 was noted on the cross-index plat and is assigned page No. 2303, in book No. \_\_\_\_\_

Janet B. Siegel by Betty L. Conner  
County Official deputy

Cross Index No. J 17 T. 29N. R. 26W. P.M.M.

Sec. 14

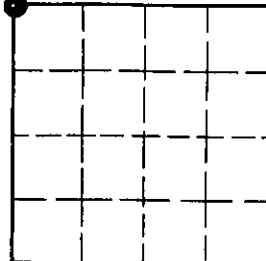

• - corner this sheet