

PLSS CORNER RECORDATION

CORNER CN1/16 CORNER SEC. 4 T. 29N, R. 26W, P.M.M., LINCOLN COUNTY

RECORD: NONE

FOUND: NOTHING

PERPETUATION: SET A 5/8"x24" REBAR WITH YELLOW PLASTIC CAP STAMPED AS SHOWN, FROM WHICH;
6" FIR BEARS N24°E 3.60' SCRIBED RM.
SET STEEL POST 1 FOOT EAST OF CORNER.

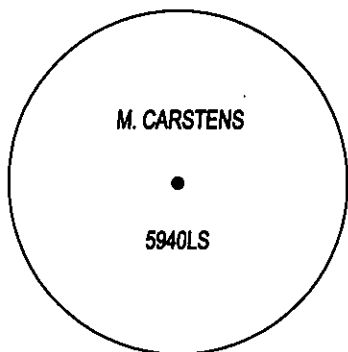
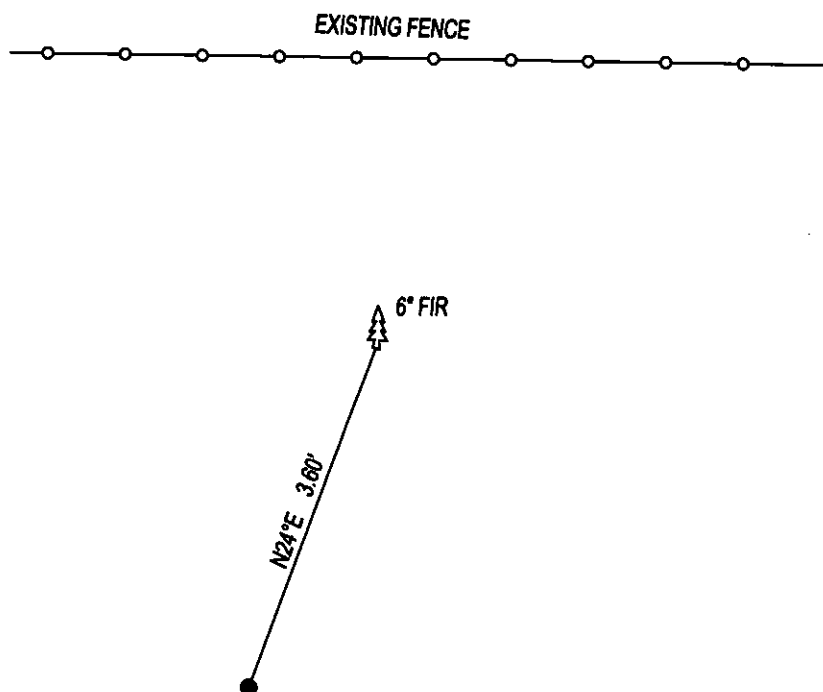

SKETCH OF CORNER

CERTIFICATION

I, DAN CROFT
CERTIFY THE INFORMATION SHOWN HEREIN IS TRUE AND CORRECT.

SIGNATURE GROUND PARTY CHIEF

I, MARC J. CARSTENS

CERTIFY THAT THIS CORNER RECORD CORRECTLY REPRESENTS WORK
PERFORMED BY ME OR UNDER MY DIRECTION IN COMPLIANCE WITH THE
"CORNER RECORDATION ACT" (70-22-101, ET SEQ., M.C.A.)

SIGNATURE OF SURVEYOR & SEAL

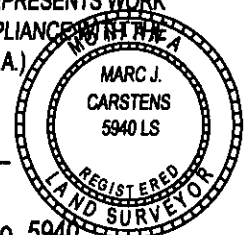

12-18-2014

LIC. No. 5940

DATE

CARSTENS SURVEYING

EMPLOYER

OFFICE OF CLERK AND RECORDER, COUNTY
_____ WAS NOTED ON _____

COUNTY OFFICIAL

CROSS INDEX NO. B-11 T. 29N, R. 26W, P.M.M.

ADOPTED NOVEMBER 7, 2012, MONTANA BOARD OF PROFESSIONAL ENGINEERS & LAND SURVEYORS

255154 BOOK: CCR CC&R'S PAGE: 12172 Pages: 1

STATE OF MONTANA LINCOLN COUNTY

RECORDED: 12/19/2014 9:50 KOI: CC&R'S

TAMMY D. LAUER CLERK AND RECORDER

FEE: \$0.00

BY:

FOR: CARSTENS LAND SURVEYING P.O. BOX 1374, POLSON, MONTANA

SEC. 4

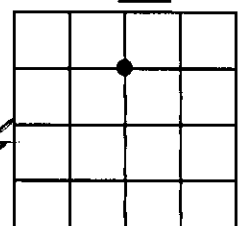

● CORNER THIS SHEET