

PLSS CORNER RECORDATION

CORNER N1/16 CORNER SEC. 4&3 T. 29N, R. 26W, P.M.M., LINCOLN COUNTY

RECORD: NONE

FOUND: NOTHING

PERPETUATION: SET A 5/8"x24" REBAR WITH YELLOW PLASTIC CAP STAMPED AS SHOWN, FROM WHICH;
NEW BT, 7" LODGEPOLE BEARS S62°E 8.0' SCRIBED RM.
SET STEEL POST 1 FOOT SOUTH, PAINTED RED BAND ON BT'S.
ALL BEARING TREES HAVE BT TAGS ATTACHED.

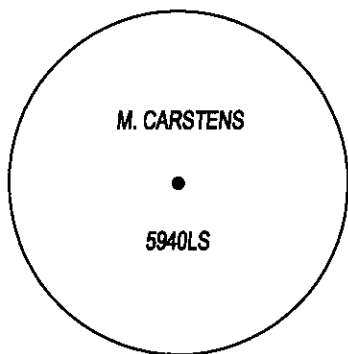
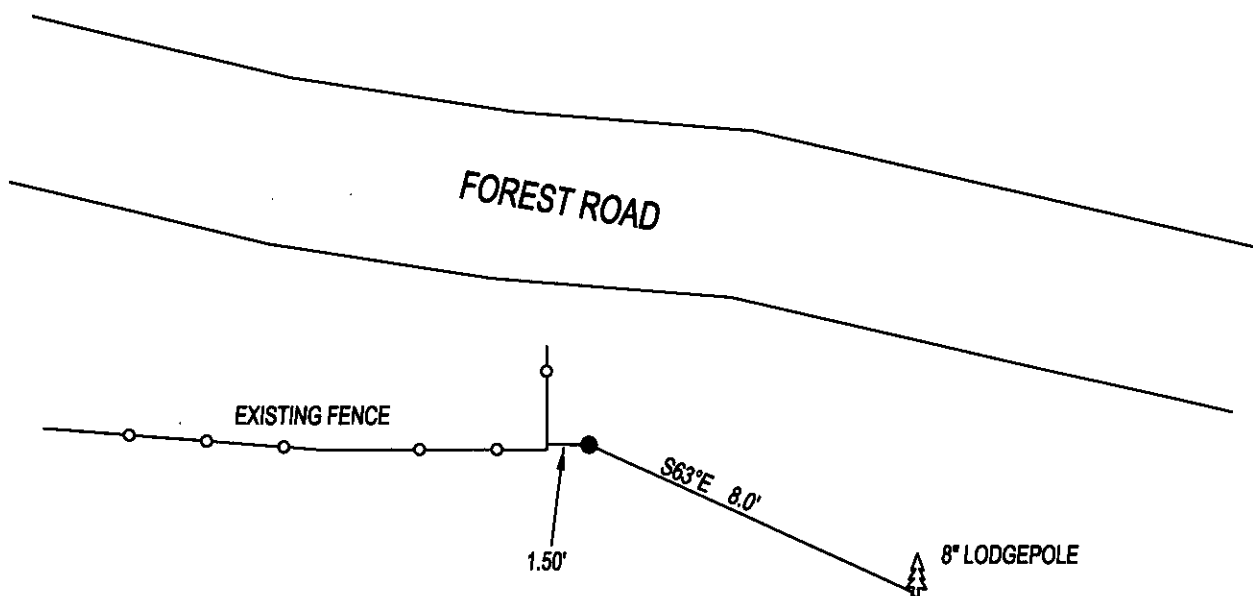

SKETCH OF CORNER

CERTIFICATION

I, DAN CROFT
CERTIFY THE INFORMATION SHOWN HEREIN IS TRUE AND CORRECT.

SIGNATURE GROUND PARTY CHIEF

I, MARC J. CARSTENS

CERTIFY THAT THIS CORNER RECORD CORRECTLY REPRESENTS WORK
PERFORMED BY ME OR UNDER MY DIRECTION IN COMPLIANCE WITH THE
"CORNER RECORDATION ACT" (70-22-101, ET SEQ., M.C.A.)

[Signature]
SIGNATURE OF SURVEYOR & SEAL

12-18-2014

DATE

CARSTENS SURVEYING

EMPLOYER

LIC. No. 5940

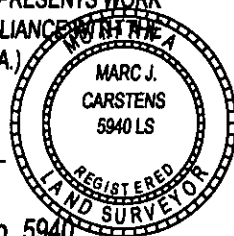

OFFICE OF CLERK AND RECORDER, COUNTY

_____ WAS NOTED

COUNTY OFFICIAL

CROSS INDEX NO. B-13 T. 29N, R. 26W, P.M.M.

ADOPTED NOVEMBER 7, 2012, MONTANA BOARD OF PROFESSIONAL ENGINEERS & LAND SURVEYORS

255150 BOOK: CCR CC&R'S PAGE: 12168 Pages: 1

STATE OF MONTANA LINCOLN COUNTY

RECORDED: 12/19/2014 9:30 KOI: CC&R'S

TAMMY D. LAUER CLERK AND RECORDER

FEE: \$0.00

BY: [Signature]

FOR: CARSTENS LAND SURVEYING P.O. BOX 1374, POLSON, MONTANA

SEC. 4

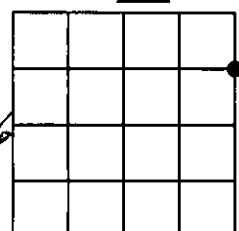

● CORNER THIS SHEET