

CERTIFIED CORNER RECORDATION

Corner S1/4 CORNER SEC.31 T. 29N R. 26W P.M.M. County LINCOLN

FOUND: 3 1/4" ALUM CAP STAMPED AS SHOWN, FROM WHICH:
12" FIR BEARS N36°W 4.0' SCRIBE OVERGROWN.
18" FIR BEARS S17°W 48.20' SCRIBE OVERGROWN.

MAINTENANCE: REMOVED BLOWDOWNS AND BRUSH FROM CORNER AREA.
ATTACHED BT TAGS AND PAINTED A RED 6" BAND AND SCRIBE RED

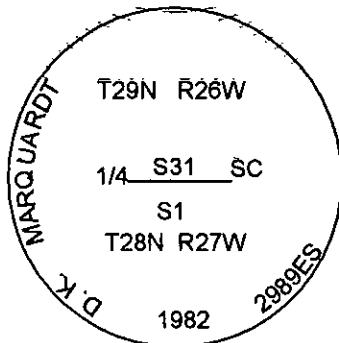
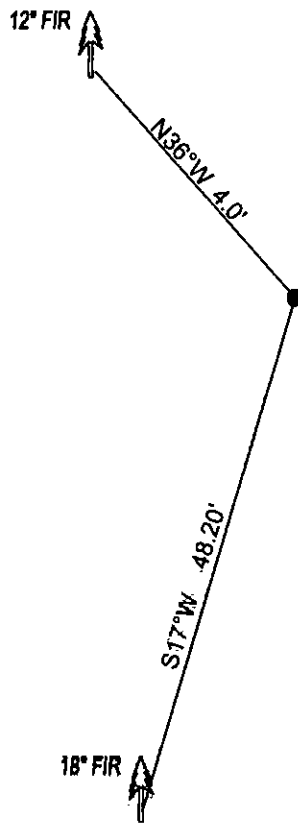

SKETCH OF CORNER

CERTIFICATION

I, DAN CROFT

certify the information shown herein is true and correct.

Signature Ground Party Chief

I, MARC J. CARSTENS

certify that this Corner Record correctly represents work performed by me or under my direction in compliance with the "Corner Recordation Act" (7P-22-101, et seq., M.C.A.)

[Signature]
Signature of Surveyor & Seal

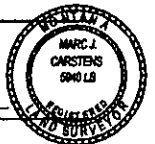

Date: 10-2010 Reg. No. 5940 LS

Employer: CARSTENS LAND SURVEYING

Office of Clerk and Recorder, County of LINCOLN This "corner

record" was filed for record on 229157 BOOK: CCR CC&R'S PAGE: 11553 Pages: 2

was noted on the cross-index plat STATE OF MONTANA LINCOLN COUNTY
RECORDED: 10/21/2010 12:16 KOI: CCR'S

book No. TAMMY D. LAUER CLERK AND RECORDER

FEE: \$0.00 BY: [Signature]
TO: CARSTENS LAND SURVEYING P.O. BOX 1374, POLSON, MONTANA

Cross Index No. Z3 T. 29N R. 26W PMM

Adopted July 1, 1981, Montana Board of Professional Engineers & Land Surveyors

Sec. 31

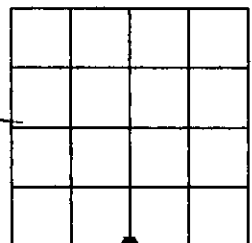

• corner this sheet