

CERTIFIED CORNER RECORDATION

Corner E1/4 CORNER SEC.32 T. 29N R. 26W P.M.M. County LINCOLN

FOUND: 3 1/4" B.L.M. BRASS CAP STAMPED AS SHOWN, FROM WHICH:
34" TAMARACK STUMP 7 FFET HIGH BEARS S59°E 22.0' SCRIBED 1/4 S BT.

MAINTENANCE: REMOVED SMALL TREES FROM CORNER AREA.
NEW BT
11" FIR BEARS S68°W 10.60' SCRIBED 1/4 RM.

ATTACHED BT TAGS AND PAINTED A RED 6" BAND AND SCRIBE RED
SET 5 FOOT STEEL POST 2 FEET NORTH OF CORNER.

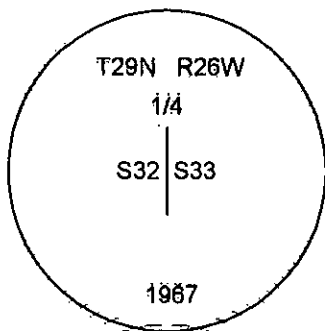
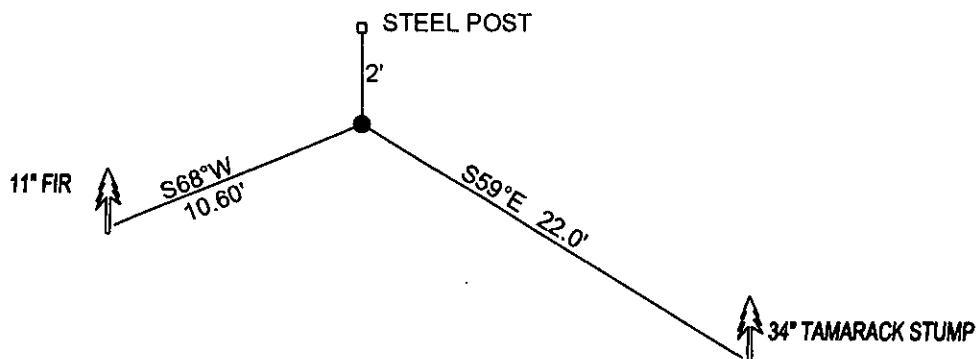

SKETCH OF CORNER

CERTIFICATION

I, DAN CROFT
certify the information shown herein is true and correct.

Signature Ground Party Chief
I, MARC J. CARSTENS
certify that this Corner Record correctly represents work performed by me or under my direction in compliance with the "Corner Recordation Act" (70-22-101, et seq., M.C.A.)
[Signature]
Signature of Surveyor & Seal



Date: 10-2010 Reg. No. 5840 LS
Employer: CARSTENS LAND SURVEYING

Office of Clerk and Recorder, County of LINCOLN . This "corner

record" was filed for record on 229165 BOOK: CCR CC&R'S PAGE: 11551 Pages: 1

was noted on the cross-index plat and STATE OF MONTANA LINCOLN COUNTY
RECORDED: 10/21/2010 12:14 KOI: CC&R'S

book No. TAMMY D. LAUER CLERK AND RECORDER
FEE: \$0.00 BY: [Signature]

TO: CARSTENS LAND SURVEYING P.O. BOX 1374, POLSON, MONTANA

Cross Index No. X-9 T. 29N R. 26W PMM

Adopted July 1, 1981, Montana Board of Professional Engineers & Land Surveyors

Sec. 32

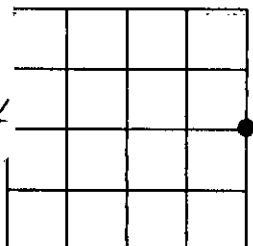

• corner this sheet