

- INSTRUCTIONS
1. Original and or substituted record used to evaluate the corner position.
 2. Description of evidence and note discrepancies in the record, state method of establishing lost or obliterated corners.
 3. Description of monument and accessories set to perpetuate the corner position.
 4. Sketch of corner, show all pertinent data which can best be shown in a sketch, example, corner marking, topography ties, position of accessories, etc.
 5. Certification must be signed and sealed by Land Surveyor registered in the State of Montana.
 6. Fill in Cross Index & Section Diagram at bottom of sheet.

CERTIFIED CORNER RECORDATION

Corner T. T29&30N R. R25&26W P.M.M. County Lincoln
Flathead

RECORD 1 G.L.O. Survey by Keerl and Jaqueth, 1893.

RECORD 2 G.L.O. Resurvey by Fred L. Cumming, 1932.

"Intersect the old cor. of Tps. 29 and 30N. Rgs. 25 and 26W., which is a wooden post, 4 ins. sq., 1 1/2 ft. above ground, firmly set, marked as described in the official record, with but one of the old bearing trees still standing. Alongside old cor.

Set an iron post, 3 ft. long, 3 ins. diam., 28 ins. in the ground, for cor. of tps. 29 and 30 N. Rgs. 25 and 26 W., with brass cap marked

T30N
R26W R25W
S36 S31
S1 S6
T29N
1932

from which

A fir, 14 ins. diam., bears N.30 3/4°E., 52 lks. dist., marked T 30 N R 25 W S31 BT.

A balsam, 8 ins. diam., (old tree) bears S.18°E., 13 lks. dist., marked T 29 N R 25 W S6 BT.

A spruce, 5 ins. diam., bears S.16 1/2°W., 31 lks. dist., marked T 29 N R 26 W S1 BT.

A fir, 12 ins. diam., bears N.38°W., 90 lks. dist., marked T 30 N R 26 S36 BT."

FOUND A firmly set, 3 ins. diam., iron pipe, showing 11 ins. above ground with 3 1/2 ins. brass cap marked as shown:

From which,

An 8 ft. high x 14 ins. diam. subalpine fir snag bears N.30 3/4°E., 52.6 lks. dist., scribed "T30N R25W S3 BT".

A live, 24 ins. diam. subalpine fir with mostly overgrown blaze bears S.18°E., 13.4 lks. dist., scribed "2NR2WS6BT".

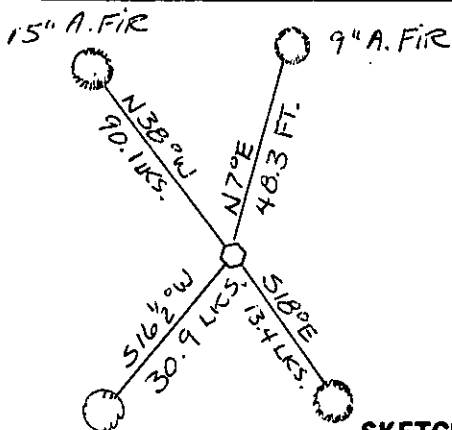

SKETCH OF CORNER

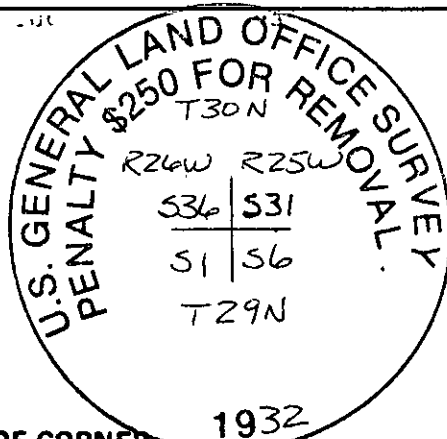

CERTIFICATION

I, Ron Krueger
certify the information shown herein is true and correct.
Ron Krueger
Signature Ground Party Chief
I, James L. Carter
certify that this Corner Record correctly represents work performed by me or under my direction in compliance with the "Corner Recordation Act" (70-22-101, et seq., M.C.A.)
James L. Carter
Signature of Surveyor & Seal
Date 12/13/85 Reg. No. 1972S
Employer: Flathead National Forest

Office of Clerk and Recorder, County of Lincoln. This "corner record" was filed for record on Dec 16, 1985 was noted on the cross-index plat and is assigned page No. 3200 in book No.

Janet BF Supt by Bill Buckhoff
County Official

A-1

29N. 25W.

Cross Index No. T. R. PMM

Adopted July 1, 1981, Montana Board of Professional Engineers & Land Surveyors

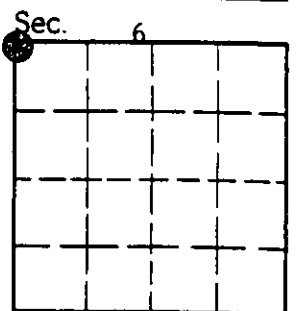

• - corner this sheet

INSTRUCTIONS TO SURVEYORS FOR COMPLETION OF CERTIFIED CORNER RECORDATION FORMS

I. ORIGINAL AND/OR SUBSEQUENT RECORD:

This item should describe or quote those portions of the original or subsequent record which were used in evaluating the corner position. The original record will usually be the General Land Office field notes. Subsequent record can come from several sources: Previously filed corner records, maps and plats, private and public records, etc. Some of the subsequent record, even though not in the public record, but known to have validity by the surveyor, may be quoted and appropriately noted.

The record data helps support the reestablished corner position because it clearly shows what history the surveyor based his corner position on. In some cases, however, the record may be unknown or not pertinent. A statement to that effect should appear on the corner record.

II. DESCRIPTION OF EVIDENCE FOUND OR METHOD OF LOCATING CORNER POSITION:

This item will describe the original or subsequent record evidence found. If portions of the found evidence cannot be reconciled with the record, then the disregarded record should be noted, and, if possible, an opinion as to its cause narrated.

If no physical evidence of the original or subsequent monuments and accessories can be found, then the method used to reestablish the lost or obliterated corner (single proportion, fence intersection, parol evidence, terrain calls, centerline of road, etc.) shall be indicated.

III. DESCRIPTION OF MONUMENTS AND ACCESSORIES SET TO PERPETUATE THE CORNER POSITION:

This item should list all details about the corner and its location which will help exclusively identify the corner position; including size and type of monument, how marked if not shown in sketch, and distinguishing topographic calls which help locate the corner. In many cases, instructions on how to find the corner should be included.

References or ties to other corners are optional and may be drawn on the face or back of the corner record form, or references to Certificate of Survey may be made. Separate drawings may be attached to the corner form.

If state plane coordinate values for the corner position are shown, then the control upon which they are based should be indicated.

IV. SKETCH OF CORNER:

This item will usually show how a found or set corner is marked and may also show topography or accessory monuments found or set and their relation to the corner. There is no stipulated format; the sketch could be transcribed field note entries.

V. CERTIFICATION:

The name and signature of the ground party chief is optional.

The Surveyor who performed or directed the field work which is depicted on the "Certified Corner Record" shall sign and affix his seal in the Certification.

The employer blank is optional but useful in tracking down original field note data or adjacent record if, in the future, questions arise about the corner.

VI.

The Cross Index at the bottom of the page should be completed by the Surveyor. Only the single Township Index where the corner is filed shall be completed.

The lower righthand corner is a corner location diagram and should have the pertinent section filled in at the top and a closed circle indicating the appropriate corner position in the section filled in. This is intended to be an aid in searching the "Record" once it has been filed.

A live, 12 ins. diam. spruce bears S.16 1/2°W., 30.9
lks. dist., scribed "T29N R26W S1 BT".

A live, 15 ins. diam. subalpine fir bears N.38°W., 90.1
lks. dist., scribed "T30N R26W S36 BT".

SET

I leave G.L.O. iron pipe with brass cap as is, and establish
the following new bearing tree

An alpine fir, 9 inches dbh, bears N.7°E., 48.3 feet
distant, blazed and scribed "T30N R25W S31 BT."

A spruce, 4 inches dbh, with a location poster
attached, bears S.44°W., a distance of 4.3 feet.

Measurements were made with a Silva Ranger hand compass
(declination 19°E.) and a steel tape.

We attached "BT" and "LAND SURVEY MONUMENT" signs to the
BT's.