

# CERTIFIED CORNER RECORDATION

Corner 1/4 Sec. 33&34 T. 28N R. 33W P.M., MT Sanders County

- I. 1908 G.L.O. Original Record by Edwin R. McLain: Set a slate stone, 14x8x5 ins., 10 ins. in the ground for 1/4 sec. cor. mkd. "1/4" on the W. face. Established two bearing trees.
- II. Found a stone, 8x4 ins., 7 ins., above the ground, mkd. "1/4" on the W. face.  
from which:  
A fir snag, 15 ins. diam., bears S35°E, 13.2 ft. dist., with visible scribe. (GLO-record)  
No evidence of the other bearing tree found.
- III. At the position of the found stone, set in its place, an aluminum pipe, 30 ins. long, 2 1/2 in. diam., 22 ins. in the ground, with a 3 1/4 in. diam. aluminum cap, mkd. as shown:

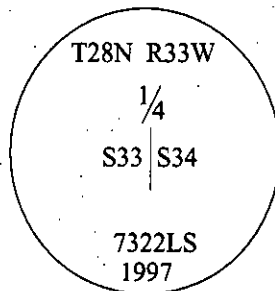

Established two bearing trees:

- A fir, 10 ins. diam., bears N61°E, 22.1 ft. dist., mkd. "1/4 S34 BT".
- A fir, 15 ins. diam., bears N12°W, 11.3 ft. dist., mkd. "1/4 S33 BT".

Buried the original stone alongside the alumunim pipe.

Painted bearing trees and attached Land Survey Monument and Bearing Tree signs.

Magnetic Declination: 20° East.

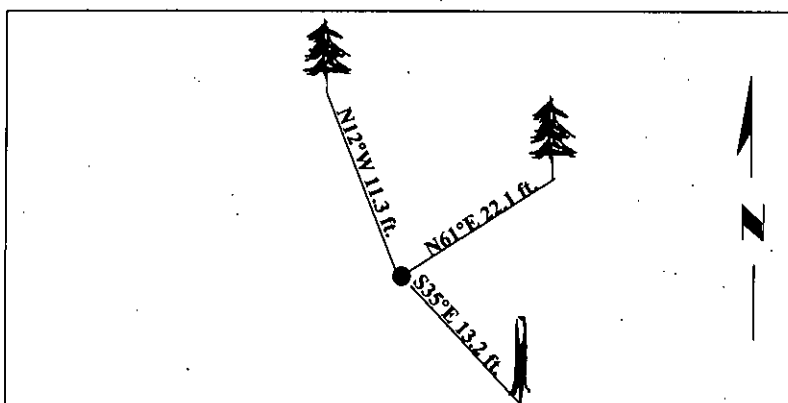

SKETCH OF CORNER

CERTIFICATION	
I, <b>Mark Federman</b>	certify the information shown herein is true and correct.
I, <b>Alvah F. Hughes</b>	certify that this Corner Record correctly represents work performed by me or under my direction in compliance with the "Corner Recordation Act" (70-22-101, et seq., M.C.A.)
<i>Alvah F. Hughes</i>	Signature of Surveyor & Seal
Date: <b>05/29/97</b>	
Reg. No.: <b>7322LS</b>	
Employer: <b>U.S. FOREST SERVICE</b>	

Office of Clerk and Recorder, County of **LINCOLN**. This "corner record" was filed for record on **JULY 31, 1997**, was noted on the cross-index plat and is assigned page No. **9815**, in book No. **CORAL M. CUMMINGS** *By DLB*

County Official

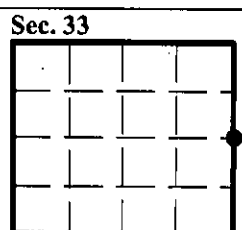

• - corner this sheet

Cross Index No. X-13 T. 28N R. 33W P.M., MT