

# CROSS INDEX PLAT

T.....28..... R.....30..... MER.

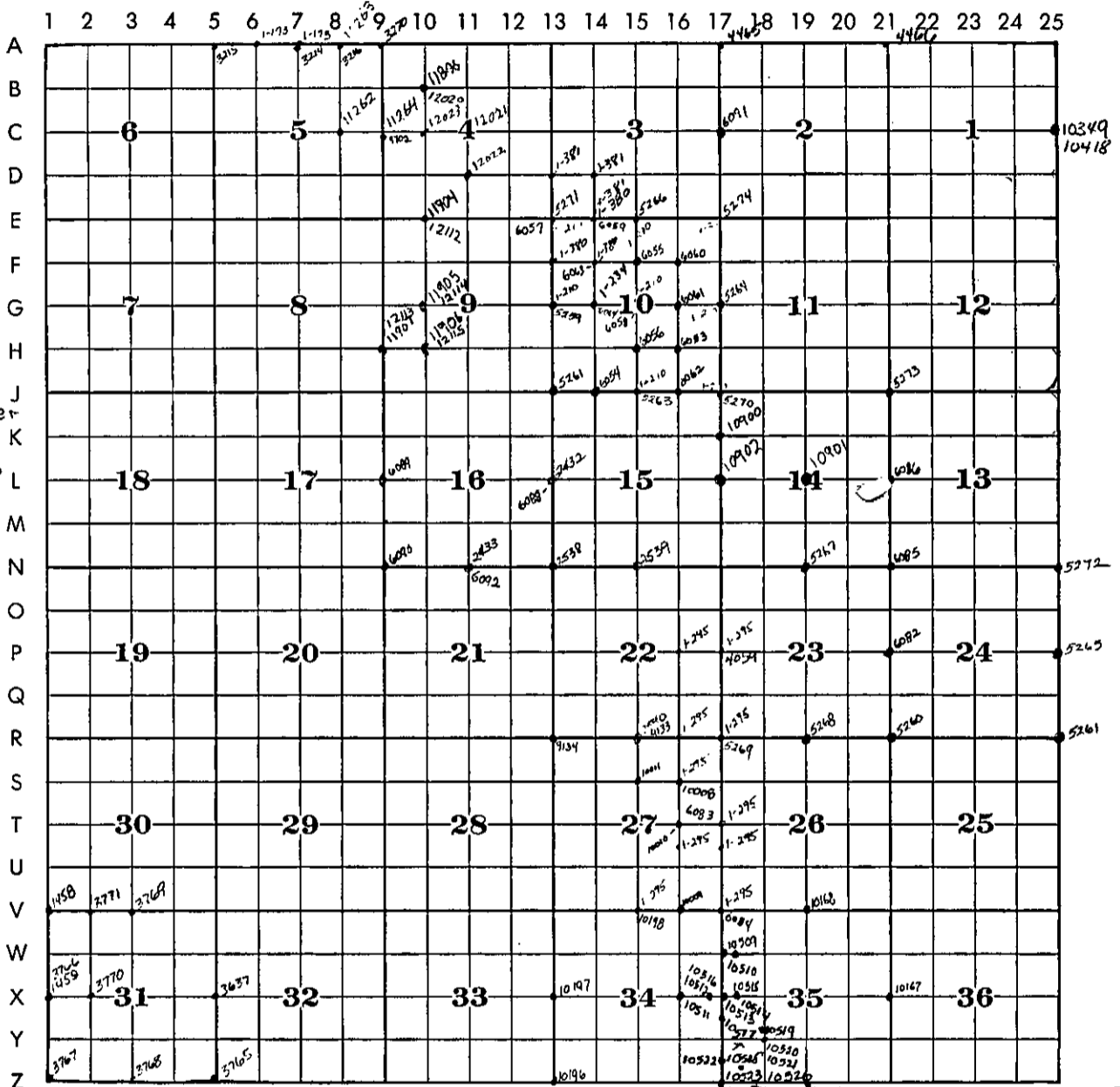

COMET Placer  
MS # 10377  
Cor # 1 - 11096  
Cor # 2 - 11098  
Cor # 3 - 11095  
Cor # 4 - 11094

Hogum Placer  
MS # 10377  
Cor # 6 - 11097  
Cor # 7 - 11098

### LEGEND

- Corners filed under this cross index plat.
- ⊕ Certificates filed in adjoining township as indicated by solid guadrant(s).

STA 232 MT Cor #1 - 10398  
STA 232 MT Cor #2 - 10399  
STA 232 MT Cor #3 - 10400  
STA 232 MT Cor #4 - 10401  
STA 232 MT Cor #5 - 10402

Each corner certificate is identified by an alphabetical-numerical coordinate number which is derived from the system shown on the township diagram. For example, the quarter-corner between Section 5 and 6 is identified as Corner C-5.

Corners such as meander corners or subdivision corners which are not located at intersecting lines on the above diagram will be identified by reference to the nearest applicable coordinate lines, thus:  
AB-1; M-1-2; VW-19-20.

Corners common to adjoining townships will be identified by coordinates of the townships in which the certificates are to be filed.

Within each township record, the certificates will be filed in alphabetical-numerical sequence.