

CERTIFIED CORNER RECORDATION

Corner WC 1/4 Sec. 4 & 5 T. 28 N R. 30 W P.M., MT Lincoln County

I. 1900 G.L.O. original record by Burton S. Adams: (39.60 ch.) As the point for the 1/4 sec. cor. falls in the creek, at this point I set a limestone 15 X 12 X 4 ins., 10 ins. in the ground, for witness cor. to 1/4 sec. cor., marked WC 1/4 on W face, from which:

A cedar, 14 ins. diam., bears N 14°45'E, 19 lks dist., mkd. WC 1/4 S4 BT.
A fir, 6 ins. diam., bears S 39°45'W, 6 lks. dist., mkd. WC 1/4 S5 BT.

1964 B.L.M. Remonumentation record by Richard L. Larimer et al: The witness 1/4 sec. cor. of secs. 4 and 5, as determined from one of the original bearing trees.

At the corner point:

Set an iron post, 30 ins. long, 2 1/2 ins. diam., 20 ins. in the ground, to bedrock, and in a mound of stone, 6 ft. in diam., to top, with brass cap mkd.:

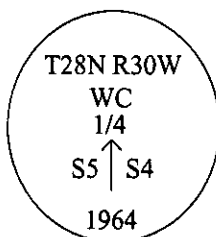

from which:
The original bearing tree:

A cedar, 20 ins. diam., bears N 14°E, 19 lks dist., mkd. WC 1/4 S4 BT. (Record)

The new bearing tree:

A cedar, 12 ins. diam., bears S 41°W, 56 lks. dist., mkd. WC 1/4 S5 BT.

II. Found a 2 1/2 in. diam. iron pipe, 2 ins. above a mound of stone, firmly set, with a 3 1/4 ins. diam. B.L.M. brass cap, marked as shown above:

from which:

A cedar, 20 ins. diam., bears N 15°E, 12.5 ft. (19 lks.) dist., with 1/4 S 4 BT visible.
A cedar, 14 ins. diam., bears S 41°W, 37.0 ft. (56 lks.) dist., mkd. WC 1/4 S 5 BT.

III. Painted bearing trees and attached Land Survey Monument and Bearing Tree signs.

Magnetic Declination: 20° East.

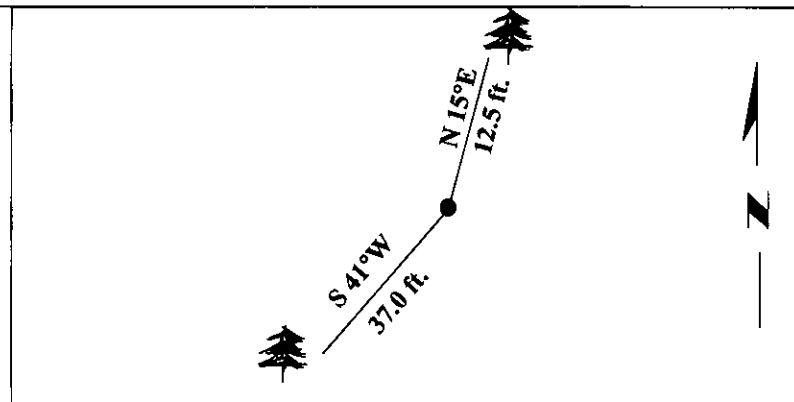

SKETCH OF CORNER

CERTIFICATION	
I. <u>Rex Owen Rice</u>	certify the information shown herein is true and correct.
Signature Ground Party Chief	
I. <u>Alvah F. Hughes</u>	certify that this Corner Record correctly represents work performed by me or under my direction in compliance with the "Corner Recordation Act" (70-22-101, et seq., M.C.A.)
Signature of Surveyor & Seal	
Date: <u>4/11/96</u>	Reg. No.: <u>7322LS</u>
Employer: <u>U.S. FOREST SERVICE</u>	

Office of Clerk and Recorder, County of LINCOLN. This "corner record" was filed for record on JULY 29, 1997 was noted on the cross-index plat and is assigned page No. 9702 in book No. CORAL M. CUMMINGS By DeB

County Official

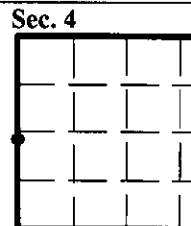

• - corner this sheet