

CERTIFIED CORNER RECORDATION

Corner 1/4 Sec. 22 & 27 T. 28N R. 30W P.M., MT Lincoln County

- I. 1900 G.L.O. original record by Burton S. Adams: Set a slate stone, 18x10x4 ins., 12 ins. in the ground, mkd. "1/4" on the N. face, from which:
 A fir, 4 ins. diam., bears S2°45'W, 63 lks. dist., scribed "1/4 S27 BT".
 A fir, 16 ins. diam., bears N14°15'W, 86 lks. dist., scribed "1/4 S22 BT".

1969 B.L.M. record by Roy G. Leedy: The 1/4 corner of secs. 22 and 27, as determined from the remains of the original bearing trees:
 A stump, bears S2 3/4°W, 65 lks. dist., scribed "1/4 S27 BT".
 A stump hole, bears N14 1/4°W, 86 lks. dist.

At the corner point, set an iron post, 30 ins. long, 2 1/2 ins. diam., 24 ins. in the ground., with brass cap mkd.:

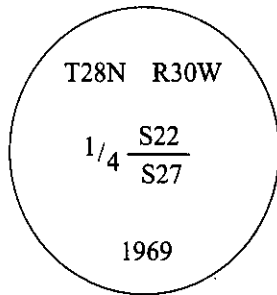

from which two new bearing trees were established:
 A fir, 16 ins. diam., bears N38°E, 56 lks. dist., scribed "1/4 S22 BT".
 A fir, 16 ins. diam., bears S3°W, 70 lks. dist., scribed "1/4 S27 BT".
 Raised a collar of stone, 2 ft. diam., around the iron post.

1984 CCR by Thomas C. Hill: Found a 2 1/2 ins. diam. iron pipe, with BLM brass cap, 7 ins. above ground with a small collar of stone around pipe, mkd. as shown, from which:
 A Douglas fir, 18 ins. diam., bears N39°E, 37.4 ft. dist., with a healed face. (BLM).
 A Douglas fir, 16 ins. diam., bears S4°W, 46.8 ft. dist., with a healed face. (BLM).

- II. Found a 2 1/2 in. diam. iron pipe, firmly set, with a 3 1/4 in. diam. brass cap, 8 ins. above ground, mkd. as shown above, from which:
 A fir stump, bears N39°E, 36.8 ft. (56 lks.) dist., with visible scribing.
 A stump, bears S3°W, 41.3 ft. (63 lks.) dist., with visible scribing. (GLO).
 A fir, 19 ins. diam., bears S4°W, 46.8 ft. (71 lks.) dist., with healed face.

- III. Established one new bearing tree:
 A fir, 12 ins. diam., bears N60°E, 37.2 ft. dist., scribed "1/4 S22 BT".

Painted bearing trees and attached Land Survey Monument and Bearing Tree signs.

Magnetic Declination: 20° East

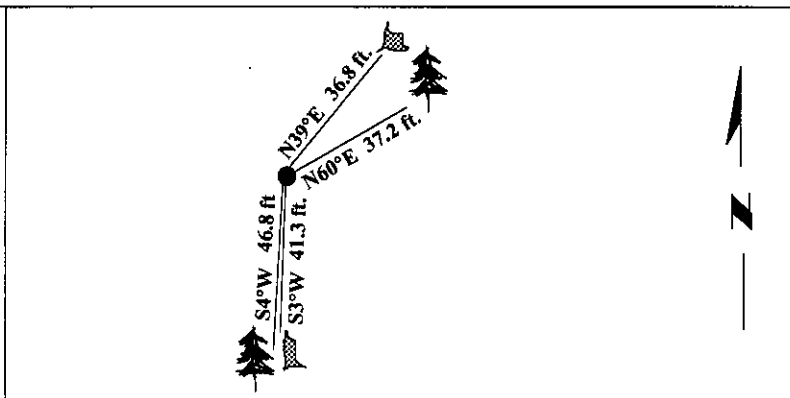

SKETCH OF CORNER

CERTIFICATION
I, <u>Mark Federman</u> certify the information shown herein is true and correct.
<i>Mark Federman</i>
I, <u>Alvah F. Hughes</u> certify that this Corner Record correctly represents work performed by me or under my direction in compliance with the "Corner Recordation Act" (70-22-101, et seq., M.C.A.).
<i>Alvah F. Hughes</i> Signature of Surveyor & Seal
Date: <u>11/26/96</u>
Reg. No.: <u>7322LS</u>
Employer: <u>U.S. FOREST SERVICE</u>

Office of Clerk and Recorder, County of LINCOLN. This "corner record" was filed for record on FEB 3, 1997 and was noted on the cross-index plat and is assigned page No. 9133, in book No. _____.

CORAL M. CUMMINGS
County Official *by CB*

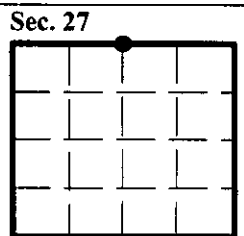

• - corner this sheet