

# CERTIFIED CORNER RECORDATION

CORNER CS1/16 SEC. 4 T. 28N, R. 30W, P.M.M., LINCOLN COUNTY

RECORD: NONE

FOUND: NOTHING

PERPETUATION: SET 5/8"x24" REBAR WITH YPC AT CORNER POSITION, FROM WHICH:  
6" FIR BEARS N27°E, 17.0' SCRIBED RM.  
SET 5 FOOT STEEL POSTS 1 FOOT NORTH AND 1 FOOT EAST OF CORNER.

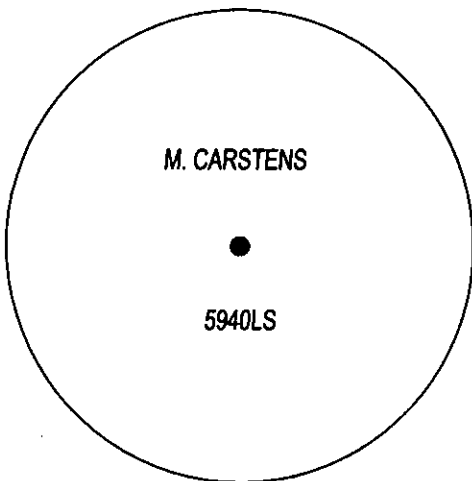
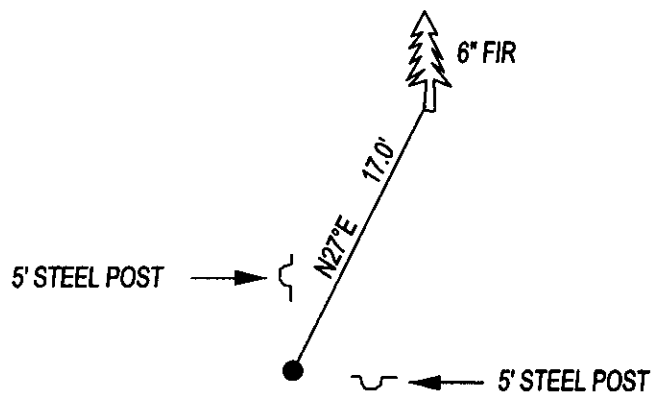

SKETCH OF CORNER

## CERTIFICATION

I, DAN CROFT  
CERTIFY THE INFORMATION SHOWN HEREIN IS TRUE AND CORRECT.

SIGNATURE GROUND PARTY CHIEF

I, MARC J. CARSTENS  
CERTIFY THAT THIS CORNER RECORD CORRECTLY REPRESENTS WORK  
PERFORMED BY ME OR UNDER MY DIRECTION IN COMPLIANCE WITH THE  
"CORNER RECORDATION ACT" (70-22-101, ET SEQ., M.C.A.)

SIGNATURE OF SURVEYOR & SEAL

03-08-13

DATE

CARSTENS SURVEYING  
EMPLOYER

5940LS  
REG. NO.

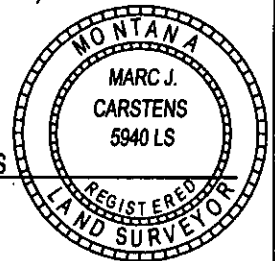

OFFICE OF CLERK AND RECORDER COUNTY OF LINCOLN  
THIS 243978 BOOK: CCR CC&R'S PAGE: 12022 Pages: 1  
STATE OF MONTANA LINCOLN COUNTY  
RECORDED: 03/12/2013 11:00 KOI: CC&R'S  
AND TAMMY D. LAUER CLERK AND RECORDER  
FEE: \$0.00 BY: Deanna Dennis deputy  
COL FOR: CARSTENS LAND SURVEYING P.O. BOX 1374, POLSON, MONTANA

CROSS INDEX NO. D-11 T. 28N, R. 30W, P.M.M.

ADOPTED JULY 1, 1981, MONTANA BOARD OF PROFESSIONAL ENGINEERS & LAND SURVEYORS

SEC. 4

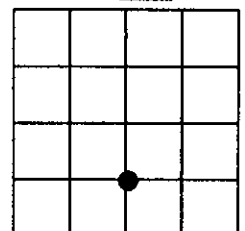

● CORNER THIS SHEET