

CERTIFIED CORNER RECORDATION

Corner S 1/16 S9 T 28 N. R. 30 W. P.M.M. Lincoln County

I. Record: 1900 Subdivision of Fractional Township 28 North, Range 30 West by
Burton S. Adams.
2010 Certificate of Survey No.4060 Lincoln County Records, by Steven A. Boyer 9750LS.

II. Found: A field search found no monuments

III. Perpetuation: At the corner point, determined by survey, set a 5/8 ins. diam.
steel rebar 24 ins. long, 23 ins. in the ground, with a 3 1/4 ins. diam.
Aluminum cap marked as shown below from which:

A Douglas Fir, 28 ins. diam., bears N57°E, 31.20 ft. dist., scribed S 1/16 S9 BT.

A Douglas fir, 11 ins. diam., bears S84°W, 23.75 ft. dist., scribed S 1/16 S8 BT

Painted faces and 6 in. wide red bands to all bearing trees and attached Land
Survey Monument and Bearing Tree signs.

Set 6 ft. long steel posts with attached Survey Monument and Property Line stickers
on line 3 ft. East and 3 Ft. South.

Magnetic declination: 18° East

Equipment used: Hand compass and loggers tape

NOTE: Refer to Certificate of Survey No. 4060
Lincoln County Records for additional survey
information.

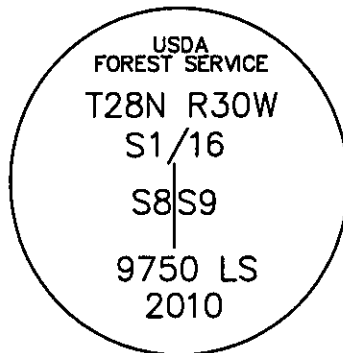

Kootenai Surveyors Inc., 314 California Av., Libby, MT. 59923 (406) 293-4354

PCTC CRAZYMAN

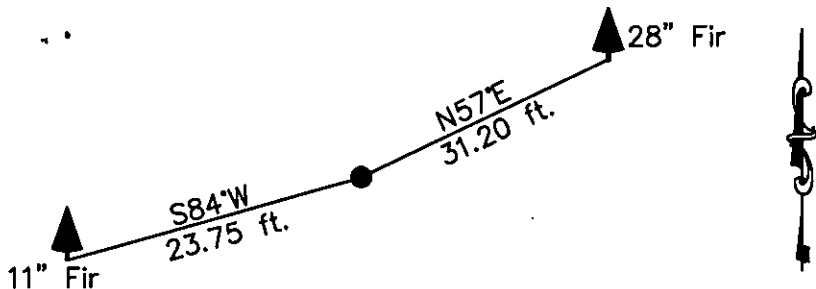

SKETCH OF CORNER

CERTIFICATION

I, Levi Powell
certify the information shown herein is true and correct.

Levi Powell
Signature Ground Party

I, Steven A. Boyer
certify that this Corner Record correctly represents work
performed by me or under my direction in compliance with
the "Corner Recordation Act" (10-22-101, et seq., M.C.A.)

Steven A. Boyer
Signature of Surveyor & Seal

Date: 04/15/2011 Reg. No. 9750LS

Employer: Kootenai Surveyors Inc.

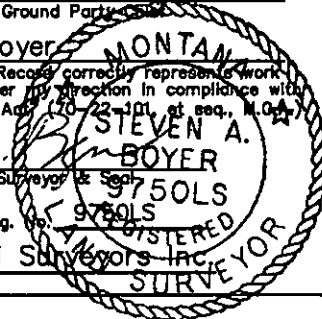

Office of Clerk and Recorder, County of Lincoln This "corner

record" was filed for record on _____

was noted on the cr. 234331 BOOK: CCR CC&R'S PAGE: 11907 Pages: 1

book No. STATE OF MONTANA LINCOLN COUNTY

RECORDED: 08/23/2011 3:45 KOI: CC&R'S

TAMMY D. LAUER CLERK AND RECORDER

FEE: \$0.00

BY: *Levi Powell*

TO: FILED

Cross Index No. H 09 T. 28N R. 30W P.M., MT

Adopted July 1, 1981, Montana Board of Professional Engineers & Land Surveyors

Sec. 9

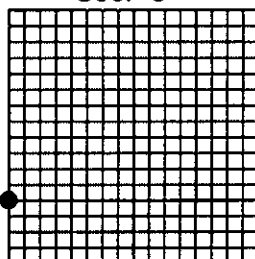

• corner this sheet