

CERTIFIED CORNER RECORDATION

Corner E1/16 SECTION 5 T28N R. 30W P.M.M. County LINCOLN

G.L.O. RECORD: NONE

FOUND: 3 1/4" ALUM CAP, STAMPED AS SHOWN, FROM WHICH:

12" FIR BEARS S30°W 9.50' WITH OVERGROWN SCRIBE.
 14" FIR BEARS S13°E, 19.0' WITH OVERGROWN SCRIBE

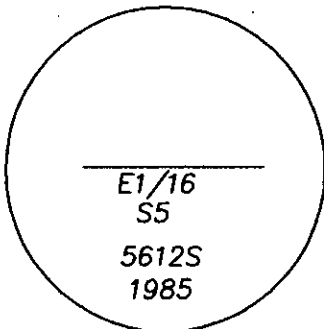
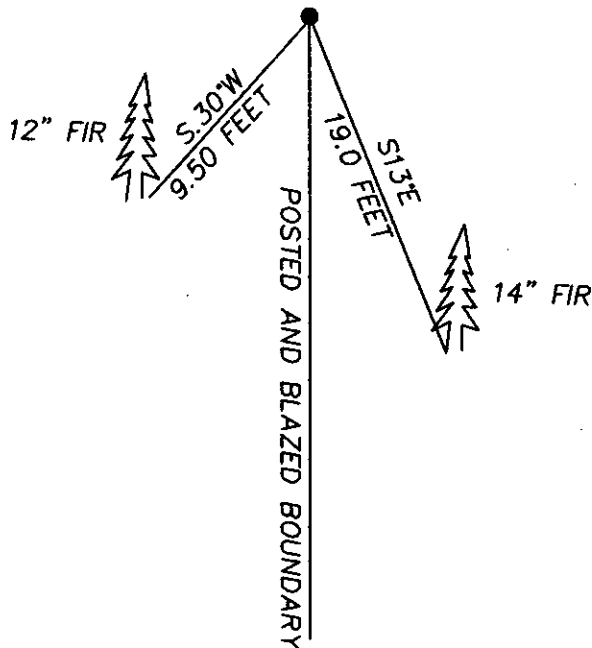

SKETCH OF CORNER

CERTIFICATION

I, DAN CROFT
 certify the information shown herein is true and correct.

Dan Croft
 Signature Ground Party Chief

I, MARC J. CARSTENS
 certify that this Corner Record correctly represents work performed by me or under my direction in compliance with the "Corner Recordation Act" (70-22-01, & seq., M.C.A.)

Marc J. Carstens
 Signature of Surveyor & Seal

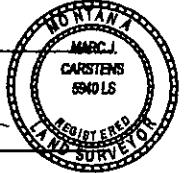

Date: 8-5-08 Reg. No. 5940-LS

Employer: CARSTENS LAND SURVEYING

Office of Clerk and Recorder, County of LINCOLN This "corner

record" was filed for record o 213632 BOOK: CCR CC&R'S PAGE: 11263 Pages: 1
 was noted on the cross-index STATE OF MONTANA LINCOLN COUNTY
 book No. _____ RECORDED: 08/12/2008 10:05 KOI: CC&R'S
 TAMMY D. LAUER CLERK AND RECORDER
 FEE: \$0.00 BY: *Tammy D. Lauer*
 TO: CARSTENS LAND SURVEYING P.O. BOX 1374, POLSON, MONTANA
 Cross Index No. A-8 T25N R. 23W P.M.M.
 28 30

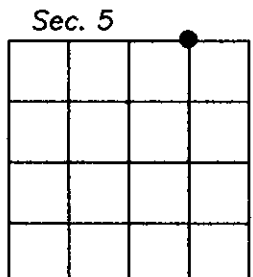

● corner this sheet

SECTION 5 T28N R30W

