

CERTIFIED CORNER RECORDATION

Corner CE1/16 SECTION 5 T28N R. 30W P.M.M. County LINCOLN

G.L.O. RECORD: NONE

SET: 3 1/4" ALUM CAP 24" IN TO THE GROUND, STAMPED AS SHOWN, FROM WHICH:

NEW BT:
A 16" FIR BEARS N52°E, 11.80 FEET SCRIBED 1/16 BT

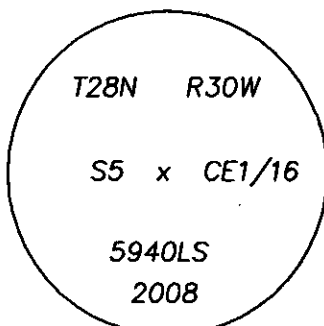
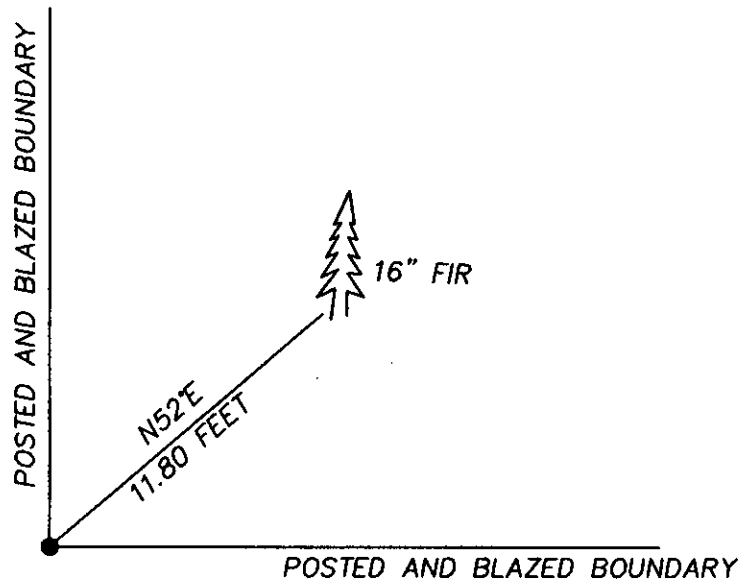

SKETCH OF CORNER

CERTIFICATION

DAN CROFT

certify the information shown herein is true and correct.

[Signature]

Signature Ground Party Chief

MARC J. CARSTENS

certify that this Corner Record correctly represents work performed by me or under my direction in compliance with the "Corner Recordation Act" (70-22-101, et seq., M.C.A.)

[Signature]

Signature of Surveyor & Seal

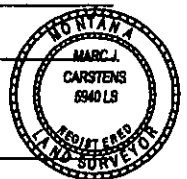

Date: 8-5-08 Reg. No. 5940-LS

Employer: CARSTENS LAND SURVEYING

Office of Clerk and Recorder, County of LINCOLN This "corner

record" was filed for record on

was noted on the cross-index plat and

book No. _____

213631 BOOK: CCR CC&R'S PAGE: 11262 Pages: 1 Sec. 5

STATE OF MONTANA LINCOLN COUNTY

RECORDED: 08/12/2008 10:00 KOI: CC&R'S

TAMMY D. LAUER CLERK AND RECORDER

FEE: \$0.00

BY: [Signature]

TO: CARSTENS LAND SURVEYING P.O. BOX 1374, POLSON, MONTANA

Cross Index No. C-8 T28N R. 30W P.M.M.

Adopted July 1, 1981, Montana Board of Professional Engineers & Land Surveyors

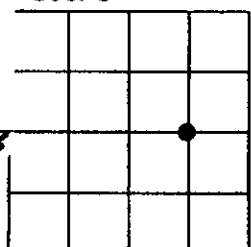

• corner this sheet

SECTION 5 T28N R30W

