

CERTIFIED CORNER RECORDATION

Corner Cor.4 Comet Placer T 28 N. R. 30 W. P.M.M. LINCOLN County
MS 10377

I. Record: 1922 Mineral survey by W. Pennington: Set a post 5 ins. square, 4 1/2ft. long 1 1/2 ft. deep with mound of stone, from which:

- A tamarack, 18 ins. diam., bears N.42°E., 23.50 ft. dist., scribed BT C-4 10377.
- A spruce, 12 ins. diam., bears N.44°W., 9.00 ft. dist., scribed BT C-4 10377.

II. Found: Search area for corner 4 Comet Placer falls along a steep washed out bank of Libby Cr. No corner or accessories were recovered.

III. Perpetuation: At the position from survey, using a Grant Boundary method, set a aluminum pipe 2 1/2 ins. diam. 30 ins. long 24 ins. in the ground, with a 3 1/4 in. diam. aluminum cap marked as shown below from which :

- A hemlock, 14 ins. diam., bears S. 61°E., 7.40 ft. dist., scribed WC 4-C 10377 BT.
- A fir, 8 ins. diam., bears S. 63°W., 5.00 ft. dist., scribed WC 4-C 10377 BT.

Painted faces and 6 in. wide red bands around BT's and attached Bearing Tree and Land Survey Monument signs.

Set a steel post 2 ft. East of set monument, with attached Land Survey and Property line stickers.

Magnetic declination: 18° East

Equipment used: Hand compass and loggers tape

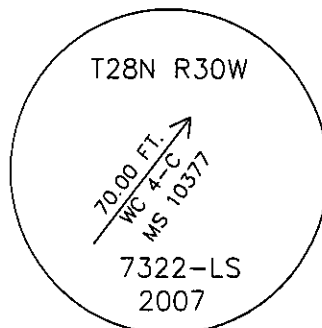

Kootenai Surveyors Inc., 314 California Av., Libby, MT. 59923 (406) 293-4354

COMET PLACER- PCTC

CERTIFICATION

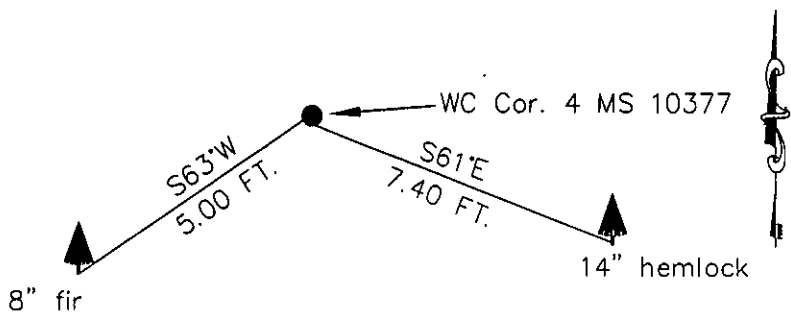

SKETCH OF CORNER

I, Levi Powell
 certify the information shown herein is true and correct.
Levi Powell
 Signature of Record Party Chief

I, Alvah F. Hughes
 certify that this Corner Record correctly represents work performed by me or under my direction in compliance with the Corner Recordation Act (70-22-101) et seq., M.C.A.
Alvah F. Hughes
 Signature of Surveyor/Seal

Date: 8/16/2007 Reg. No. 7322-LSND

Employer: Kootenai Surveyors Inc.

Office of Clerk and Recorder, County of Lincoln. This "corner record" was filed for record on _____

Sec. 18

205546 BOOK: CCR CC&R'S PAGE: 11094 Pages: 1
 was noted on the cross-index STATE OF MONTANA LINCOLN COUNTY
 book No. _____ RECORDED: 08/24/2007 8:39 KOI: CC&R'S

TAMMY D. LAUER CLERK AND RECORDER
 FEE: \$0.00 BY: *Tammy D. Lauer*
 TO: AL HUGHES-SURVEYOR P.O. BOX 393, LIBBY MT 59923

Cross Index No. _____ T. 28N. R. 30W. P.M., MT

Adopted July 1, 1981, Montana Board of Professional Engineers & Land Surveyors

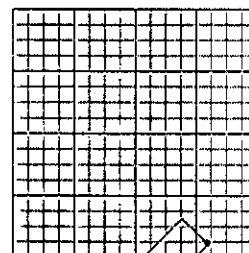

• corner this sheet