

- CERTIFIED CORNER RECORDATION -

Corner **STA 232 MT** Sec. **27** T. **28** N. R. **30** W. P.M., MT Lincoln County
 Cor. **2**

- I. Creating original tract, no prior history.
- II. Creating original tract, no evidence to be found.
- III. Set by survey, an aluminum rod, 30 ins. long, 3/4 in. diam., flush with the ground, with a 3 1/4 ins. diam. aluminum cap, mkd. as shown.

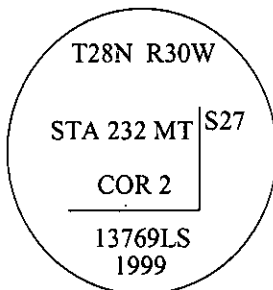

from which:

A fir, 6 ins. diam. bears S44°E, 5.4 ft. dist., scribed "COR 2 STA 232 BT".
 A larch, 15 ins. diam. bears S13°W, 17.5 ft. dist., scribed "COR 2 STA 232 BT".

A 6 foot galvanized steel guard post, bearing S83°W, 2.3 feet dist., with Land Survey Monument and Property Boundary decals affixed.
 A 6 foot galvanized steel guard post, bearing N09°W, 2.4 feet dist., with Property Boundary decals affixed.

*See Survey titled "Certificate of Survey, Otte, S.T.A. 232 MT", filed at Lincoln County Courthouse.

Magnetic Declination: 20° East

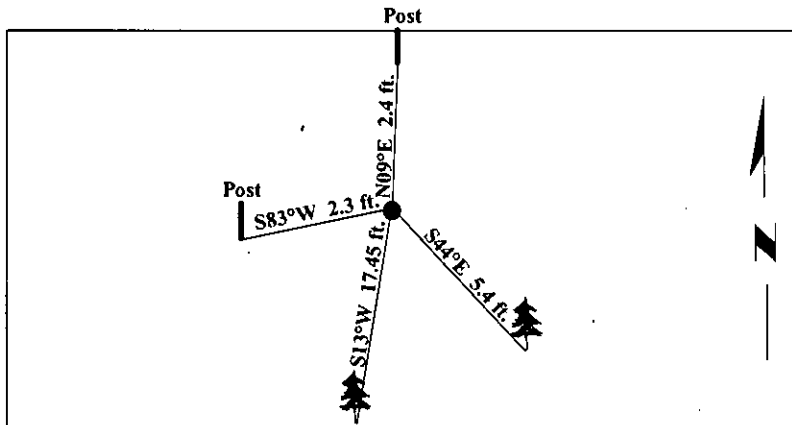

SKETCH OF CORNER

CERTIFICATION

I, Rex O. Rice
 certify the information shown herein is true and correct.

Rex O. Rice

I, Roger O. Green
 certify that this Corner Record correctly represents work performed by me or under my direction in compliance with the "Corner Recordation Act" (70-22-101, et seq., M.C.A.)

Roger O. Green
 Signature of Surveyor & Seal

Date: 8/23/99

Reg. No.: 13769LS

Employer: U.S. FOREST SERVICE

Office of Clerk and Recorder, County of Lincoln. This "corner record" was filed for record on 10/27/99 and was noted on the cross-index plat and is assigned page No. 10399 in book No. _____.

Coral M. Cummins By P/B
 County Official

Sec. 27

● - corner this sheet

Cross Index No. STA 232 MT Cor. 2 Sec. 27 T. 28 N. R. 30 W. P.M., MT