

CERTIFIED CORNER RECORDATION

Corner CN 1/16 Sec. 27 T. 28N R. 30W P.M., MT Lincoln County

- I. No previous history.
- II. No evidence found.
- III. Set by survey, a 30 ins. long x 3/4 in. diam. driveable aluminum rod, 22 ins. in the ground, with a 3 1/4 in. diam. aluminum cap mkd. as shown.

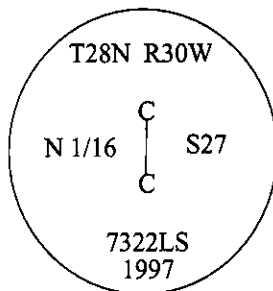

Established two bearing trees:

- A fir, 10 ins. diam., bears S21°E, 6.8 ft. dist., mkd. "CN 1/16 S27 BT".
- A fir, 8 ins. diam., bears S40°W, 16.3 ft. dist., mkd. "CN 1/16 S27 BT".

Painted bearing trees and attached Land Survey Monument and Bearing Tree signs.

Magnetic Declination: 20° East.

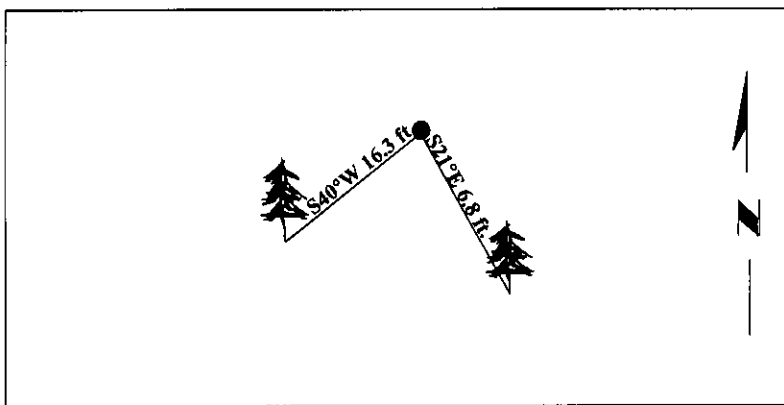

SKETCH OF CORNER

CERTIFICATION
I, <u>Thomas Hommel</u> certify the information shown herein is true and correct.
I, <u>Alvah F. Hughes</u> certify that this Corner Record correctly represents work performed by me or under my direction in compliance with the "Corner Recordation Act", (70-22-101, et seq., M.C.A.)
Signature of Surveyor & Seal
Date: <u>10/02/97</u>
Reg. No.: <u>7322LS</u>
Employer: <u>U.S. FOREST SERVICE</u>

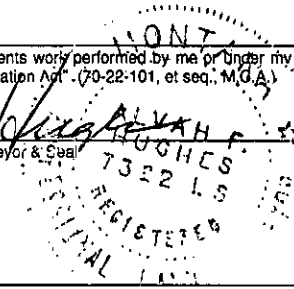

Office of Clerk and Recorder, County of Lincoln. This "corner record" was filed for record on 12-26-97 was noted on the cross-index plat and is assigned page No. 10011 in book No. _____

Coral M. Cummings
County Official

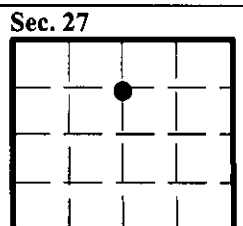

● - corner this sheet