

CERTIFIED CORNER RECORDATION

Corner E 1/16 Secs. 27 & 34 T. 28N R. 30W P.M., MT Lincoln County

- I. No previous history.
- II. No evidence found.
- III. Set by survey, a 30 ins. long x 3/4 in. diam. driveable aluminum rod, 23 ins. in the ground, with a 3 1/4 in. diam. aluminum cap mkd. as shown.

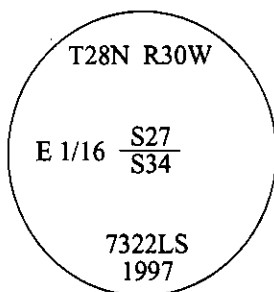

Established two bearing trees:

- A fir, 12 ins. diam., bears N08°E, 7.0 ft. dist., mkd. "E 1/16 S27 BT".
- A fir, 15 ins. diam., bears S25°W, 16.5 ft. dist., mkd. "E 1/16 S34 BT".

Painted bearing trees and attached Land Survey Monument and Bearing Tree signs.

Magnetic Declination: 20° East.

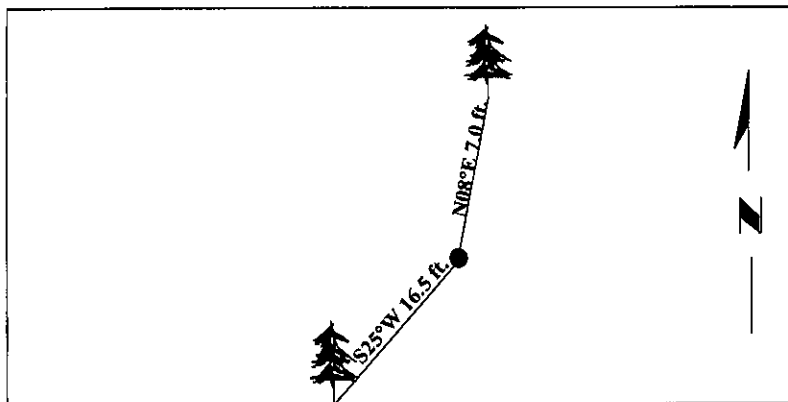

SKETCH OF CORNER

CERTIFICATION

I, Thomas Hommel
certify the information shown herein is true and correct.

I, Alvah F. Hughes
certify that this Corner Record correctly represents work performed by me or under my direction in compliance with the "Corner Recordation Act", (70-22-101, et seq., M.C.A.)

Signature of Surveyor & Seal: Alvah F. Hughes

Date: 10/02/97

Reg. No.: 7322LS

Employer: U.S. FOREST SERVICE

ALVAH F. HUGHES
7322 LS
REGISTERED
LAND SURVEYOR

Office of Clerk and Recorder, County of Lincoln. This "corner record" was filed for record on 12-26-97 was noted on the cross-index plat and is assigned page No. 10009 in book No. _____

Coral M. Cummings By DLB
County Official

