

INSTRUCTIONS

1. Original and/or subsequent record used to evaluate the corner position.
2. Description of evidence found, note discrepancies in the record, state method of establishing lost or obliterated corners.
3. Description of monument and accessories set to perpetuate the corner position.
4. Sketch of corner, show all pertinent data which can best be shown in a sketch example, corner marking, topography ties, position of accessories, etc.
5. Certification must be signed and sealed by Land Surveyor registered in the State of Montana.
6. Fill in Cross Index & Section Diagram at bottom of sheet.

CERTIFIED CORNER RECORDATION

Corner 1/4 of Secs. 35 & 36 T. 28 N. R. 29 W. P.M.M. Lincoln County

I. 1903, G.L.O. original record by Fred I. Hubbard:

1970, B.L.M. remonumentation record by Joseph E. French: "The 1/4 sec. cor. of secs. 35 and 36, monumented with a quartzite stone, 12 x 8 x 8 ins., firmly set, mkd. 1/4 on the W. face, and witnessed by the remains of the original bearing trees:

A larch, 18 ins. diam., bears S45° E, 39 lks. dist., mkd. 1/4 S36 BT.

A dead larch, 12 ins. diam., bears N53° W, 14 lks. dist., mkd. 1/4 S35 BT.

At the corner point, set an iron post, 30 ins. long, 2 1/2 ins. diam., 24 ins. in the ground, with brass cap mkd.

T28N R29W

1/4

S35 | S36

1970

from which a new bearing tree:

A fir, 8 ins. diam., bears S82° W, 23 lks. dist., mkd. 1/4 S35 BT.

Bury the original stone alongside the iron post."

II. Found, a set 2 1/2 in. dia. iron pipe, 9 ins. out of the ground with 3 1/4 in. dia., B.L.M. brass cap, marked as shown:

T23N R29W

1/4

S35 | S36

1970

from which

A larch snag, 15 ins. dia., bears S42° E, 25.9 ft. (39.2 lks.) dist., all scribe visible (G.L.O. rcd.)

A fir (top broken off), 8 ins. dia., bears S82° W, 15.6 ft. (23.6 lks.) dist., partial scribe visible (B.L.M. rcd.)

A larch snag, 8 ins. dia., bears N50° W, 9.3 ft. (14 lks.) dist., partial scribe visible (G.L.O. rcd.)

III. Established two new bearing trees:

A larch, 15 ins. dia., bears S56° E, 37.4 ft. dist., scribed 1/4 S36 BT.

A douglas fir, 6 ins. dia., bears S31° W, 10.1 ft. dist., scribed 1/4 S35 BT.

Painted red bands around the bearing trees and attached Land Survey Monument and Bearing Tree signs where needed.

Set a 6 ft. galvanized steel guard post with Land Survey Marker and Property Boundary decals, South, 3 ft.

Magnetic Declination: 20° 30' East

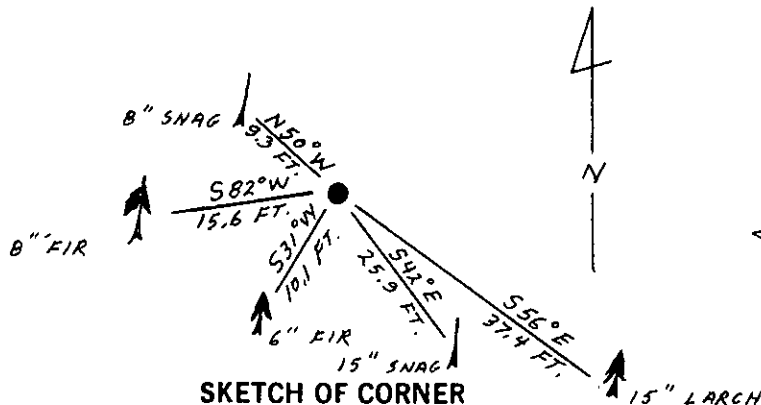

CERTIFICATION

I, Gary C. Crismon

certify the information shown herein is true and correct.

Gary C. Crismon
Signature Ground Party Chief

I, Ronald A. Pearson
certify that this Corner Record correctly represents a survey performed by me or under my direction in compliance with the "Corner Recordation Act" (70-22-101 et seq., M.C.A.)

Ronald A. Pearson
Signature of Surveyor & Seal

Date: 12/20/89 Reg. No. 9008 LS

Employer: U.S. FOREST SERVICE

Office of Clerk and Recorder, County of Lincoln. This "corner

record" was filed for record on Jan 9, 1990

was noted on the cross-index plat and is assigned page No. 4203, in

book No. _____

Janet E. Sugil by Eric Sackoff
County Official

Cross Index No. X-21 T. 28 N R. 29 W P.M.M.

Adopted July 1, 1981, Montana Board of Professional Engineers & Land Surveyors

Sec. 35

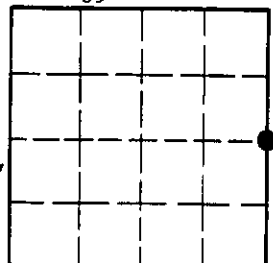

• - corner this sheet