

INSTRUCTIONS

1. Original and/or subsequent record used to evaluate the corner position.
2. Description of evidence found, note discrepancies in the record, state method of establishing lost or obliterated corners.
3. Description of monument and accessories set to perpetuate the corner position.
4. Sketch of corner, show all pertinent data which can best be shown in a sketch example, corner marking, topography ties, position of accessories, etc.
5. Certification must be signed and sealed by Land Surveyor registered in the State of Montana.
6. Fill in Cross Index & Section Diagram at bottom of sheet.

CERTIFIED CORNER RECORDATION

Corner of Secs. 25, 26, 35 & 36 T. 28 N., R. 29 W., P.M.M. Lincoln County
 I. 1903, G.L.O. original record by Fred I. Hubbard:

1964, B.L.M. Remonumentation, record by Richard L. Larimer et al: "The cor. of secs. 25, 26, 35 and 36, monumented with a granite, 16 x 12 x 7 ins., loosely set and mkd. with 1 groove on the E. and S. faces, and witnessed by three of the original bearing trees. At the corner point, set an iron post, 30 ins. long, 2 1/2 ins. diam., 27 ins in the ground, with brass cap mkd.

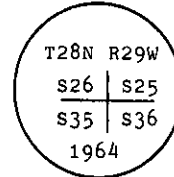

from which

The original bearing trees:

- A pine, 29 ins. diam., bears S80° E, 38 lks. dist., mkd. with a overgrown blaze (record).
- A larch, 26 ins. diam., bears S31 1/2° W, 69 lks. dist., mkd. with an overgrown blaze (record).
- A pine, 30 ins. diam., bears N81° W, 29 lks. dist., mkd. with an overgrown blaze (record).

The new bearing trees:

- A fir, 7 ins. diam., bears N47 1/2° E, 24 lks. dist., mkd. T28N R29W S25 BT.
- A larch, 5 ins. diam., bears S41° E, 27 lks. dist., mkd. T28N R29W S36 BT.
- A fir, 9 ins. diam., bears S58 1/2° W, 39 lks. dist., mkd. T28N R29W S35 BT.
- A fir, 7 ins. diam., bears N64° W, 62 lks. dist., mkd. T28N R29W S26 BT.

Bury the original stone alongside of the iron post.

II. Found, a set 2 1/2 in. dia. iron pipe, 8 ins. out of ground with a 3 1/4 in. dia., B.L.M. brass cap, marked as shown above, from which

- A log with roots, 20 ins. dia., bears N30° E, 43 ft. (65.1 lks.) dist., all scribe visible. (could have been moved by a dozer, G.L.O. rcd. N28° E, 68 lks.)
- A douglas fir, 12 ins. dia., bears N50° E, 15.9 ft. (24 lks.) dist., scribe overgrown. (B.L.M. rcd.)
- A ponderosa pine, 27 ins. dia., bears S80° E, 25.4 ft. (38.5 lks.) dist., partial scribe visible. (G.L.O. rcd.)
- A larch, 8 ins. dia., bears S40° E, 17.8 ft. (27.0 lks.) dist., scribe overgrown. (B.L.M. rcd.)
- A larch, 24 ins. dia., bears S31° W, 45.5 ft. (68.9 lks.) dist., scribe visible. (G.L.O. rcd.)
- A douglas fir, 12 ins. dia., bears S58° W, 25.5 ft. (38.6 lks.) dist., scribe overgrown. (B.L.M. rcd.)
- A ponderosa pine, 33 ins. dia., bears N82° W, 18.6 ft. (28.2 lks.) dist., no visible scribe. (G.L.O. rcd.)
- A douglas fir, 14 ins. dia., bears N62° W, 40.7 ft. (61.7 lks.) dist., scribe overgrown. (B.L.M. rcd.)

III. Painted red bands around the bearing trees and attached Land Survey Monument and Bearing Tree signs where needed. Set a 6 ft. galvanized steel guard post with Land Survey Marker and Property Boundary decals, South, 3 ft.

Magnetic Declination: 20° 30' East

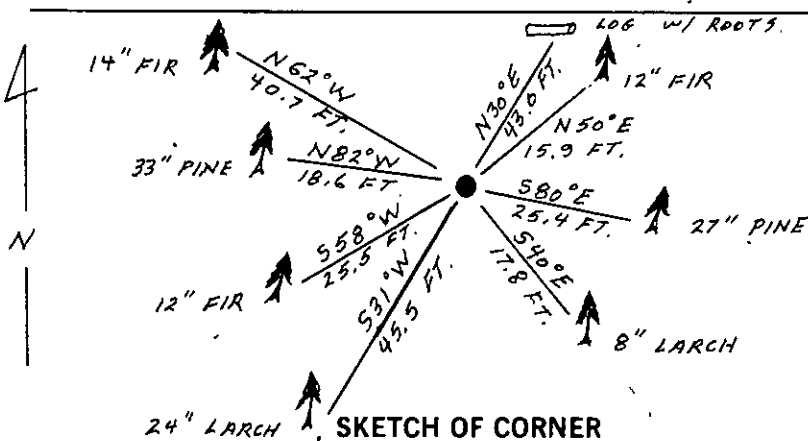

CERTIFICATION

1. Gary C. Crismon
 certify the information shown herein is true and correct.

Gary C. Crismon
 Signature Ground Party Chief

2. Ronald A. Pearson
 certify that this Corner Record correctly represents work performed by me or under my direction in compliance with the "Corner Recordation Act" (70-22-101, et seq., M.C.A.)

Ronald A. Pearson
 Signature of Surveyor & Seal

Date: 12/20/89 Reg. No. 9008 LS
 Employer: U.S. FOREST SERVICE

Office of Clerk and Recorder, County of Lincoln. This "corner record" was filed for record on Jan 9, 1990 was noted on the cross-index plat and is assigned page No. 4202 in book No. _____

Janet B. Sigel by Bill Deakoff
 County Official

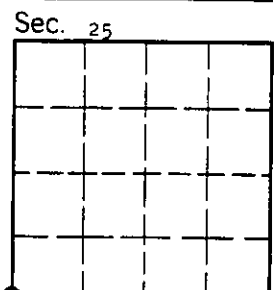

Cross Index No. V-21 T. 28 N R. 29 W P.M.M.

• - corner this sheet