

INSTRUCTIONS

1. Original and/or subsequent record used to evaluate the corner position.
2. Description of evidence found, note discrepancies in the record, state method of establishing lost or obliterated corners.
3. Description of monument and accessories set to perpetuate the corner position.
4. Sketch of corner, show all pertinent data which can best be shown in a sketch example, corner marking, topography ties, position of accessories, etc.
5. Certification must be signed and sealed by Land Surveyor registered in the State of Montana.
6. Fill in Cross Index & Section Diagram at bottom of sheet.

CERTIFIED CORNER RECORDATION

Corner of Secs. 35 & 36 only T. 28 N., R. 29 W., P.M.M. Lincoln County
 I. 1902, G.L.O. original record by Burton S. Adams et al:

1968, B.L.M. remonumentation record by Woodrow E. Damm et al: "The cor. of secs. 35 and 36, on the S. bdy. of the tp., monumented with a limestone, 15 x 10 x 6 ins., firmly set, mkd. with 1 notch on the E. and 5 notches on the W. edges, and witnessed by the remains of the original bearing trees. At the corner point, set an iron post, 30 ins. long, 2 1/2 ins. diam., 24 ins. in the ground, with brass cap mkd.

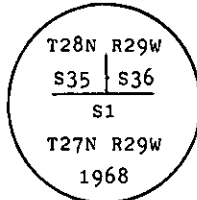

from which

The original bearing trees:

- A snag, 5 ins. diam., bears N59 1/4° E, 7 lks. dist., mkd. T28N R29W S36 BT. (record)
- A pine, 7 ins. diam., bears S12 1/2° E, 31 lks. dist., mkd. T27N R29W S1 BT.
- A pine, 6 ins. diam., bears S39 1/2° W, 31 lks. dist., mkd. T27N R29W S2 BT. (record)
- A stump hole, bears N62° W, 19 lks. dist., with a fallen log mkd. T28N R29W S35 BT. (Record)

The new bearing trees:

- A fir, 9 ins. diam., bears N49 1/2° E, 13 lks. dist., mkd. T28N R29W S36 BT.
- A larch, 9 ins. diam., bears N51° W, 51 lks. dist., mkd. T28N R29W S35 BT.

Bury the original stone alongside the iron post."

II. Found, a set 2 1/2 in. dia. iron pipe, 6 ins. out of ground, with a 3 1/4 in. dia., B.L.M. brass cap marked as shown above, from which

- A douglas fir, 11 ins. dia., bears N48° E, 9.8 ft. (14.8 lks., rcd: 13 lks.) dist., scribe overgrown. (BLM rcd.)
- A dead lodgepole pine, 7 ins. dia., bears S14° E, 20.3 ft. (30.8 lks.) dist., all scribe visible. (GLO rcd)
- A larch, 9 ins. dia., bears N48° W, 33.8 ft. (51.2 lks.) dist., all scribe visible. (BLM rcd.)
- A root hole with log, bears S38° W, 17.0 ft. (25.8 lks., rcd: 31 lks.) dist., all scribe visible on log. (GLO rcd.)

III. Established one new bearing tree:

- A douglas fir, 11 ins. dia., bears S30° E, 15.4 ft. dist., scribed T27N R29W S1 BT.

Painted red bands around the bearing trees and attached Land Survey Monument and Bearing Tree signs where needed. Set a 6 ft. galvanized steel guard post with Land Survey Marker and Property Boundary decals, north, 1.8 ft.

Magnetic Declination: 20° 30' East

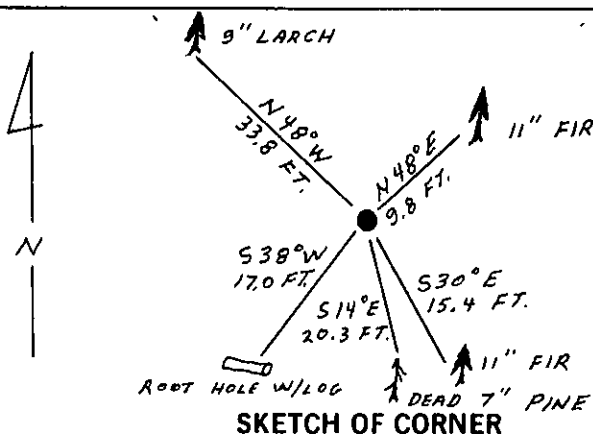

SKETCH OF CORNER

CERTIFICATION

I, Gary C. Crismon

certify the information shown herein is true and correct.
 Gary C. Crismon
 Signature Ground Party Chief

I, Ronald A. Pearson

certify that this Corner Record correctly represents work performed by me or under my direction in compliance with the "Corner Recordation Act" (70-22-101, et seq., M.C.A.)

Ronald A. Pearson
 Signature of Surveyor & Seal

Date: 12/21/89 Reg. No. 9008 LS

Employer: U.S. FOREST SERVICE

Office of Clerk and Recorder, County of Lincoln. This "corner record" was filed for record on Jan 9, 1990 was noted on the cross-index plat and is assigned page No. 4200 in book No. _____

Cross Index No. Z-21 T. 28 N. R. 29 W. PMM

Adopted July 1, 1981, Montana Board of Professional Engineers & Land Surveyors

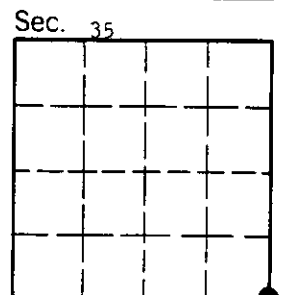

• - corner this sheet