

CERTIFIED CORNER RECORDATION

Corner 1/4 CORNER SECTIONS 17 AND 18T, 28N R. 29W P.M.M. County LINCOLN

FOUND: 3 1/2" BRASS CAP MONUMENT BY BLM, DEPT. OF INTERIOR
 FOUND 24" PINE THAT BEARS N53 1/2°W, 15.84'
 FOUND 16" FIR THAT BEARS N77 3/4°E, 23.1'

MAINTENANCE: SET A 5 FOOT STEEL POST 1 FEET SOUTH OF MONUMENT
 PAINTED FACE AND A BAND AROUND THE TREES

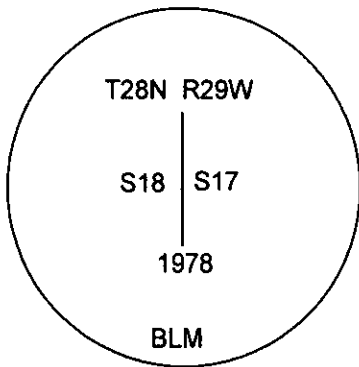
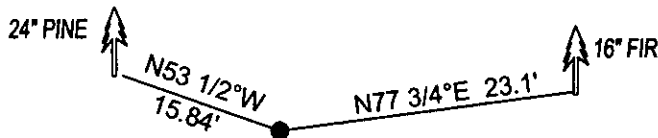

SKETCH OF CORNER

CERTIFICATION

I, STEPHEN DAY
 certify the information shown herein is true and correct.

Signature Ground Party Chief

I, MARC J. CARSTENS
 certify that this Corner Record correctly represents work performed by me or under my direction in compliance with the "Corner Recordation Act" (10-22-101, et seq., M.C.A.)

Marc J. Carstens
 Signature of Surveyor & Seal



Date: 07-2012 Reg. No. 5940 LS
 Employer: CARSTENS LAND SURVEYING

Office of Clerk and Recorder, County of LINCOLN. This "corner

record" was filed for record on 239728 BOOK: CCR CC&R'S PAGE: 11980 Pages: 1
 STATE OF MONTANA LINCOLN COUNTY

was noted on the cross-index plate RECORDED: 07/16/2012 10:52 KOI: CC&R'S

book No. _____ TAMMY D. LAUER CLERK AND RECORDER

FEE: \$0.00 BY: *Tammy D. Lauer*
 FOR: CARSTENS LAND SURVEYING P.O. BOX 1374, POLSON, MONTANA

Cross Index No. L-5 T. 28N R. 29W PMM

Adopted July 1, 1981, Montana Board of Professional Engineers & Land Surveyors

Sec. 17

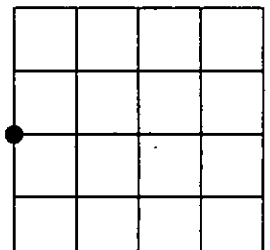

• corner this sheet