

CERTIFIED CORNER RECORDATION

Corner SECTION CORNER 7, 8, 17, 18 T. 28N R. 29W P.M.M. County LINCOLN

FOUND: 3 1/2" BRASS CAP MONUMENT BY BLM, DEPT. OF INTERIOR
FOUND 8" FIR THAT BEARS S78°W, 14.9'

MAINTENANCE: SET A 5 FOOT STEEL POST 1 FEET SOUTH OF MONUMENT
NEW BEARING TREES:
12" FIR BEARS S35°E, 23.0'.
10" FIR BEARS N56°E, 28.8'.
9" LODGEPOLE BEARS N62°W, 17.2'.
PAINTED FACE AND BAND AROUND TREES WITH RED PAINT

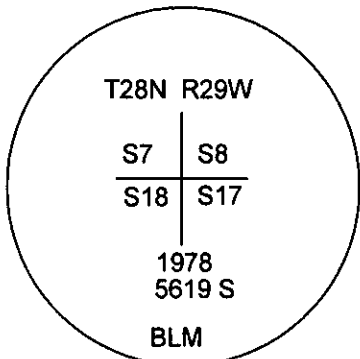
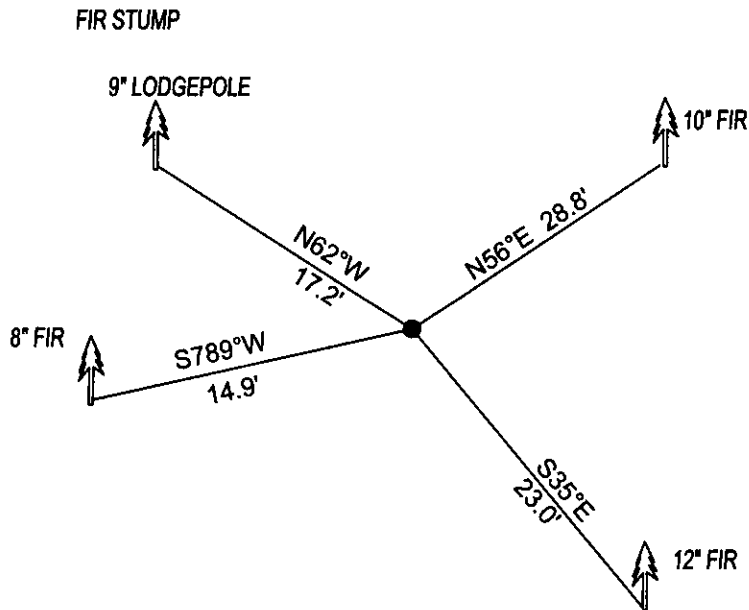

SKETCH OF CORNER

CERTIFICATION

I, STEPHEN DAY
certify the information shown herein is true and correct.

Signature Ground Party Chief

I, MARC J. CARSTENS
certify that this Corner Record correctly represents work performed by me or under my direction in compliance with the Corner Recordation Act (7-22-101, et seq., M.C.A.)

Signature of Surveyor & Seal

Date: 07-2012 Reg. No. 5940 LS

Employer: CARSTENS LAND SURVEYING



Office of Clerk and Recorder, County of LINCOLN . This "corner

record" was filed for record 239726 BOOK: CCR CC&R'S PAGE: 11978 Pages: 1

was noted on the cross-RECORDED: 07/16/2012 10:50 KOI: CC&R'S

book No. _____ FEE: \$0.00 BY Heannie Benner Deputy
FOR: CARSTENS LAND SURVEYING P.O. BOX 1374, POLSON, MONTANA

Cross Index No. J-5 T. 28N R. 29W PMM

Adopted July 1, 1981, Montana Board of Professional Engineers & Land Surveyors

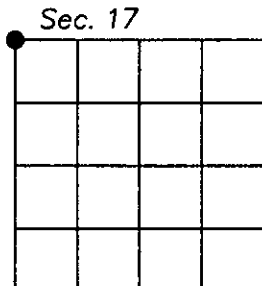

• corner this sheet