

# CERTIFIED CORNER RECORDATION

Corner SW CORNER SEC.9 T. 28N R. 29W P.M.M. County LINCOLN

FOUND: 3 1/4" ALUM CAP STAMPED AS SHOWN, FROM WHICH:  
 15° FIR BEARS N57°E 19.50' SCRIBE OVERGROWN.  
 8° FIR BEARS S27°E 7.20' WITH SOME SCRIBE.  
 10° FIR BEARS S26°E 9.70' WITH OVERGROWN SCRIBE.  
 17° FIR BEARS S6°W 25.50' WITH OVERGROWN SCRIBE.  
 33° FIR BEARS N44°W 44.00' WITH OVERGROWN SCRIBE.

MAINTENANCE: REMOVED BRUSH FROM CORNER AREA. SET 5 FOOT STEEL POST NORTH OF CORNER  
 ATTACHED BY TAGS AND PAINTED A RED 6" BAND AND SCRIBE RED

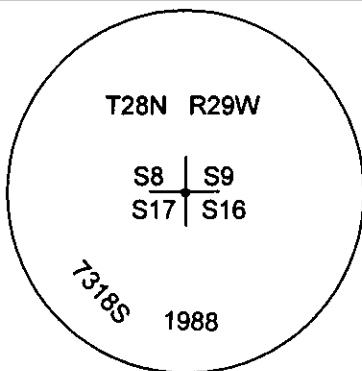
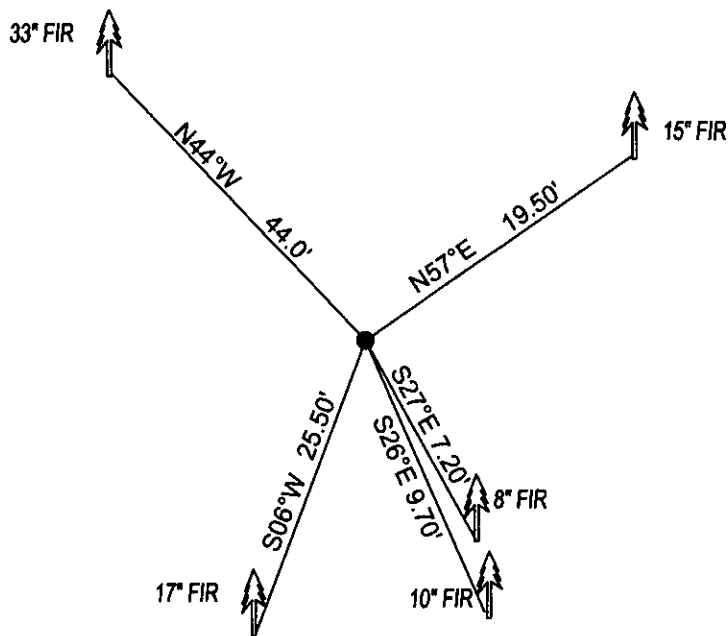

SKETCH OF CORNER

CERTIFICATION

I, DAN CROFT  
 certify the information shown herein is true and correct.

Signature Ground Party Chief

I, MARC J. CARSTENS  
 certify that this Corner Record correctly represents work performed by me or under my direction in compliance with the "Corner Recordation Act" (70-22-101, et seq., M.C.A.)

Signature of Surveyor & Seal

Date: 10-2011 Reg. No. 5940 LS  
 Employer: CARSTENS LAND SURVEYING

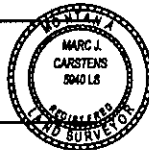

Office of Clerk and Recorder, County of LINCOLN. This "corner

record" was filed for record on  
 was noted on the cross-index |  
 book No. \_\_\_\_\_

235737 BOOK: CCR CC&R'S PAGE: 11921 Pages: 1  
 STATE OF MONTANA LINCOLN COUNTY  
 RECORDED: 11/02/2011 10:50 KOI: CC&R'S  
 TAMMY D. LAUER CLERK AND RECORDER  
 FEE: \$0.00 BY: *Tammy D. Lauer Deputy*  
 TO: CARSTENS LAND SURVEYING P.O. BOX 1374, POLSON, MONTANA  
 Cross Index No. J-9 T. 28N R. 29W PMM

Sec. 9

• corner this sheet