

CERTIFIED CORNER RECORDATION

Corner Sections 6, 7 T. 28 N., R. 29 W., P.M.M. Lincoln County

Record :

1900 original GLO notes by Burton S. Adams.
Set a granite stone 22" x 8" x 6", 16 inches in the ground;
established 4 Bearing Trees.

1916 retracement of the West boundary of T28N R 29W, PMM, by
Armstrong.

"I made the cor. of Sec. 1 and 12 only by cutting the marking from
the bearing Trees in Sec. 6 and 7."

Found Evidence :

Found the stone set by Adams and the stump with BT. Stone broken off
and the notches clearly visible.

Perpetuation :

Established the following new Bearing Trees for Sec. 6 and 7 only:

A Douglas Fir, 12 inches diam. DBH, bears N 68° E 13.90 feet,
scribed T28N R29W S6 BT.

A Douglas Fir, 9.5 inches diam. DBH, bears S 20° E 17.4 feet,
scribed T28N R29W S7 BT.

Set a 3 1/4 inch diam. alum. cap attached to a 2 1/2 inch diam. alum.
pipe, 30 inches long, 26 inches in the ground. Rock pile around
monument with the broken stone alongside.

Painted red bands around Bearing Trees and attached Bearing Tree
and Land Survey Monument signs.

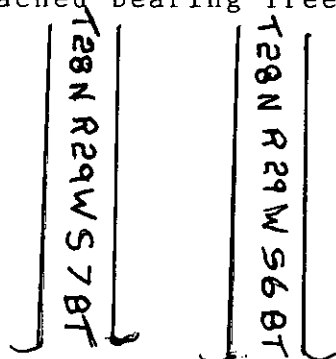
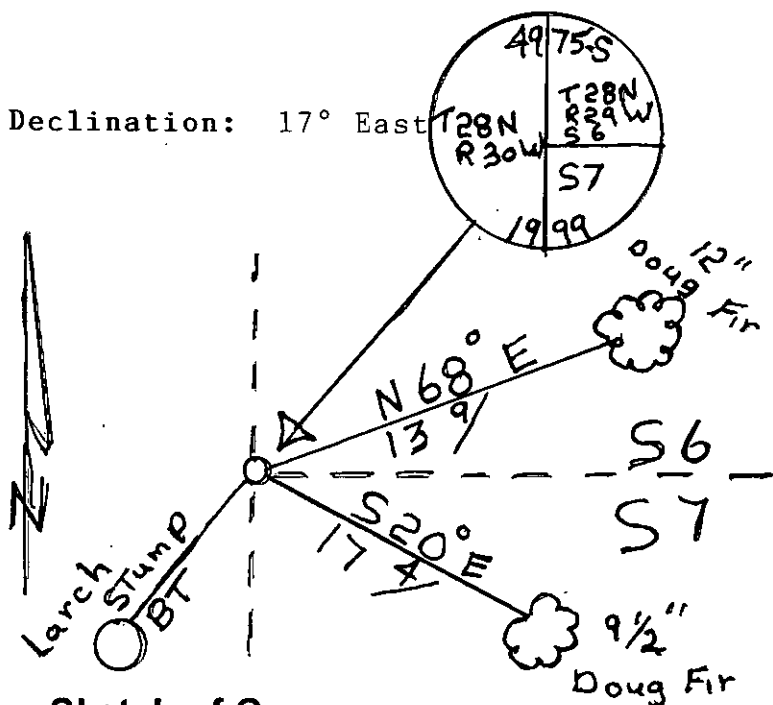

CERTIFICATION
I, George Clark
certify the information shown herein is true and correct
Signature of Ground Party Chief
I, Kenneth E. Davis
certify that this Corner Record correctly represents work performed by
me under my direction in compliance with the "Corner Recordation
Act"
KENNETH E. DAVIS
Surveyor & Seal
Date of Survey 4975 S
Employed by SURVEYING, Inc.

Section

Office of Clerk and Recorder, County of Lincoln
This "corner record" was filed for record on 2/28/2000
was noted on the cross-index plat and is assigned page No. 10421
in book No. Coral M. Cummins By RB
County Official

