

CERTIFIED CORNER RECORDATION

CORNER W1/4 SEC. 24 T. 28N, R. 28W, P.M.M., LINCOLN COUNTY

FOUND: 3 1/4" BLM ALUM CAP STAMPED AS SHOWN, FROM WHICH;
25" FIR BEARS S65°E 43.60' SCRIBE OVERGROWN.
11" WHITE FIR BEARS N82°W 51.50' SCRIBED 1/4 S23 BT.

MAINTENANCE: SET A 5 FOOT STEEL POST'S 1 FOOT EAST AND 1 FOOT SOUTH OF CORNER.
ATTACHED BEARING TREE TAG'S AND PAINTED RED BANDS ON BEARING TREES.

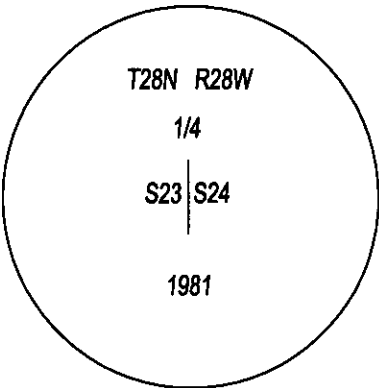
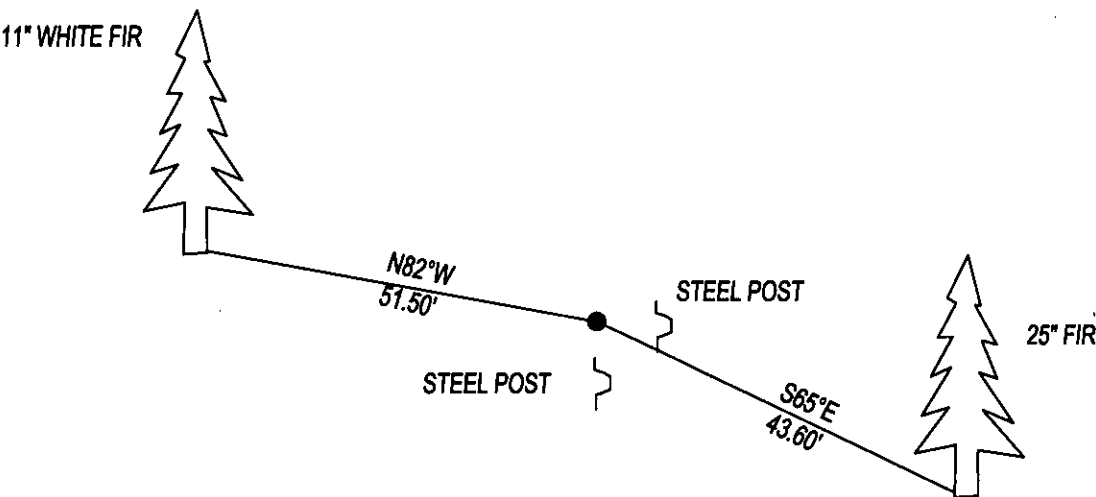

SKETCH OF CORNER

CERTIFICATION
I, DAN CROFT
CERTIFY THE INFORMATION SHOWN HEREIN IS TRUE AND CORRECT.

SIGNATURE GROUND PARTY CHIEF
I, MARC J. CARSTENS
CERTIFY THAT THIS CORNER RECORD CORRECTLY REPRESENTS WORK
PERFORMED BY ME OR UNDER MY DIRECTION IN COMPLIANCE WITH THE
"CORNER RECORDATION ACT" (70-22-101, ET SEQ., M.C.A.)

[Signature]
SIGNATURE OF SURVEYOR & SEAL
10-15-2014
DATE
CARSTENS SURVEYING
EMPLOYER

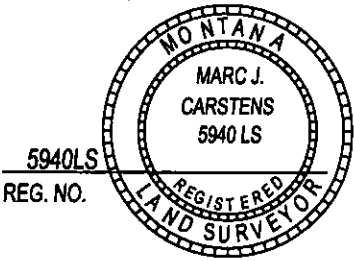

OFFICE OF CLERK AND RECORDER, COUNTY C
THIS "CORNER RECORD" WAS FILED FOR REC
AND IS ASSIGNED PAGE NO. _____, IN BO

254134 BOOK: CCR CC&R'S PAGE: 12142 Pages: 1
STATE OF MONTANA LINCOLN COUNTY
RECORDED: 10/28/2014 10:36 KOI: CC&R'S
TAMMY D. LAUER CLERK AND RECORDER
FEE: \$0.00 BY: [Signature]
FOR: CARSTENS LAND SURVEYING P.O. BOX 1374, POLSON, MONTANA

COUNTY OFFICIAL
CROSS INDEX NO. P-21 T. 28N, R. 28W, P.M.M.
ADOPTED JULY 1, 1981, MONTANA BOARD OF PROFESSIONAL ENGINEERS & LAND SURVEYORS

