

CERTIFIED CORNER RECORDATION

CORNER N1/4 SEC. 24 T. 28N R. 28W P.M.M., LINCOLN COUNTY

FOUND: 3 1/4" BLM ALUM CAP STAMPED AS SHOWN, FROM WHICH;  
17" TAMARACK SNAG BEARS N81°E 55.50' WITH VISIBLE SCRIBE.  
17" FIR BEARS N08°E 22.40' SCRIBE OVERGROWN.  
12" FIR BEARS S58°W 25.10' SCRIBE OVERGROWN.

MAINTENANCE: STACKED A COLLAR OF STONE AROUND CORNER.  
ATTACHED BEARING TREE TAG'S AND PAINTED RED BANDS ON BEARING TREES.

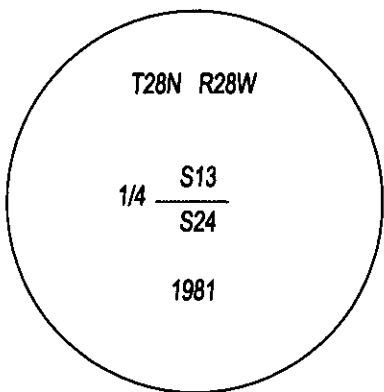
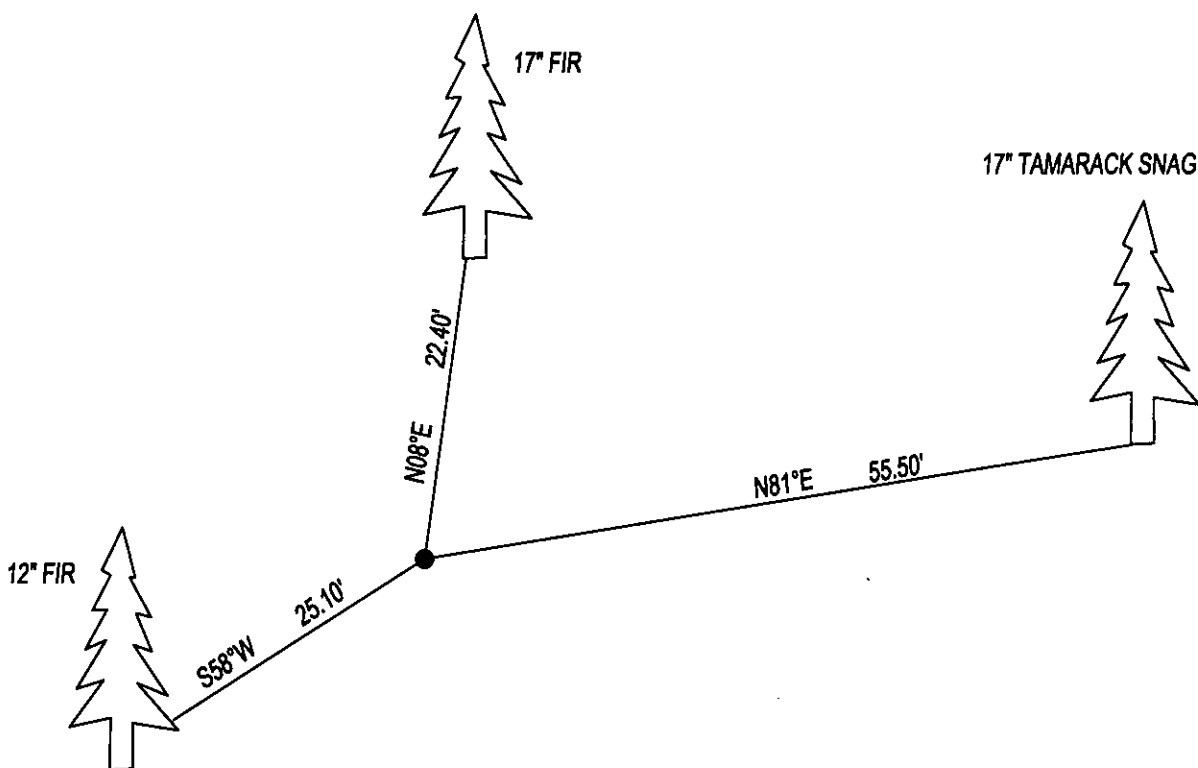

SKETCH OF CORNER

CERTIFICATION

I, DAN CROFT  
CERTIFY THE INFORMATION SHOWN HEREIN IS TRUE AND CORRECT.

SIGNATURE GROUND PARTY CHIEF

I, MARC J. CARSTENS  
CERTIFY THAT THIS CORNER RECORD CORRECTLY REPRESENTS WORK  
PERFORMED BY ME OR UNDER MY DIRECTION IN COMPLIANCE WITH THE  
"CORNER RECORDATION ACT" (70-22-101, ET SEQ., M.C.A.)

[Signature]  
SIGNATURE OF SURVEYOR & SEAL

10-15-2014  
DATE  
CARSTENS SURVEYING  
EMPLOYER

5940LS  
REG. NO.

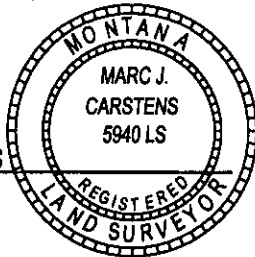

OFFICE OF CLERK AND RECORDER, COUNTY OF  
THIS "CORNER RECORD" WAS FILED FOR RECO  
AND IS ASSIGNED PAGE NO. \_\_\_\_\_, IN BOX \_\_\_\_\_

COUNTY OFFICIAL

CROSS INDEX NO. N-23 T. 28N R. 28W P.M.M.

ADOPTED JULY 1, 1981, MONTANA BOARD OF PROFESSIONAL ENGINEERS & LAND SURVEYORS

254133 BOOK: CCR CC&R'S PAGE: 12141 Pages: 1  
STATE OF MONTANA LINCOLN COUNTY  
RECORDED: 10/28/2014 10:35 KOI: CC&R'S  
TAMMY D. LAUER CLERK AND RECORDER  
FEE: \$0.00 BY: [Signature]  
FOR: CARSTENS LAND SURVEYING P.O. BOX 1374, POLSON, MONTANA

SEC. 24

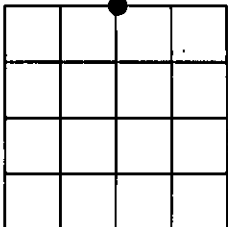

● CORNER THIS SHEET