

CERTIFIED CORNER RECORDATION

CORNER S1/16 SECTION 6 T. 28N R. 28W P.M.M., LINCOLN COUNTY

RECORD : NONE

FOUND: "T" BAR, FROM WHICH;
12" LARCH BEARS S47°E 11.50' WITH LOCATION POSTER.
9" LARCH BEARS S68°W 6.80' WITH LOCATION POSTER.

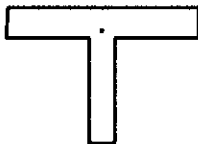
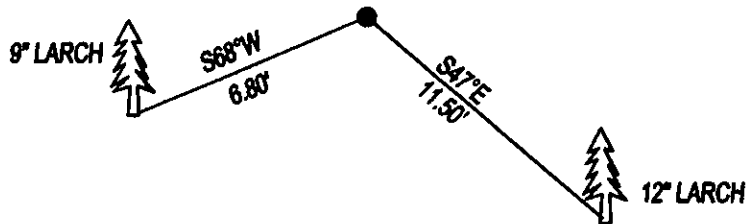

SKETCH OF CORNER

CERTIFICATION

I, DAN CROFT
CERTIFY THE INFORMATION SHOWN HEREIN IS TRUE AND CORRECT.

SIGNATURE GROUND PARTY CHIEF

I, MARC J. CARSTENS

CERTIFY THAT THIS CORNER RECORD CORRECTLY REPRESENTS WORK
PERFORMED BY ME OR UNDER MY DIRECTION IN COMPLIANCE WITH THE
"CORNER RECORDATION ACT" (70-22-101, ET SEQ., M.C.A.)

SIGNATURE OF SURVEYOR & SEAL

06-14-12

DATE

CARSTENS SURVEYING
EMPLOYER

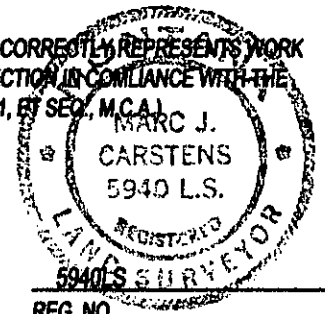

REG. NO.

OFFICE OF CLERK AND RECORDER, COUNTY
THIS "CORNER RECORD" WAS FILED FOR RE
WAS NOTED ON
AND IS ASSIGNED PAGE NO. _____, IN 1

239367 BOOK: CCR CC&R'S PAGE: 11971 Pages: 1

STATE OF MONTANA LINCOLN COUNTY

RECORDED: 06/25/2012 10:02 KOI: CC&R'S

TAMMY D. LAUER CLERK AND RECORDER

FEE: \$0.00

BY: 

FOR: CARSTENS SURVEYING

COUNTY OFFICIAL

CROSS INDEX NO. D-5 T. 28N R. 28W P.M.M.

ADOPTED JULY 1, 1981, MONTANA BOARD OF PROFESSIONAL ENGINEERS & LAND SURVEYORS

SEC. 6

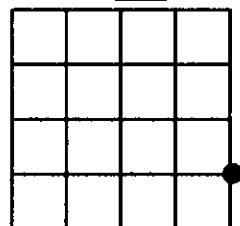

● CORNER THIS SHEET