

CERTIFIED CORNER RECORDATION

Corner 413 1/4 Cor. S 910 T. 28 N., R. 28 W., P.M.M. Lincoln County

Record :

1902 GLO Township Subdivision by B. Adams

80.00 chs. "Set a Limestone, 20x14x10 ins. 15 ins. in the ground, for cor. of Secs. 3, 4, 9 and 10, marked with 5 notches on S. and 3 notches on E. edges, from which:

- A pine, 12 ins. diam., bears N 60° E, 85 lks. dist., marked T28N, R28W S3 BT.
- A fir, 10 ins. diam., bears S 66° E, 38 lks. dist., marked T28N, R28W S10 BT.
- A fir, 12 ins. diam., bears S 24° W, 61 lks. dist., marked T28N, R28W S9 BT.
- A pine, 8 ins. diam., bears N 13° W, 5 lks. dist., marked T28N, R28W S4 BT.

Found Evidence :

The corner for Secs. 3, 4, 9 and 10 monumented with a limestone 18x12x6 ins., firmly set 10 ins. in the ground, marked with 5 notches on S. and 3 notches on E. edges, from which:

- A Ponderosa Pine, 14 ins. diam., bears N 15° W, 3.00 ft. dist. (record N 13° W, 3.30 ft.), with visible scribing.
- A Ponderosa Pine, 17 1/4 ins. diam., bears N 61° E 52.60 ft. dist. (record N 60° E, 56.10 ft.) with visible scribing.
- A Douglas Fir snag with root crown bears S 65° E, 24.00 ft. dist. (record S 66° E, 25.08 ft.) with visible scribing.
- A Douglas Fir snag with stump hole bears S 27° W, 39.50 ft. dist. (record S 24° W 40.26 ft.) with visible scribing.

Perpetuation :

At the found stone monument position, we replaced it with a 2 1/2 inch diam. alum. pipe, 30 ins. long, 20 ins. in the ground, with a 3 1/4 inch dia. alum. cap marked as shown below, from which:

- A Douglas Fir 4 1/2 in. diam. bears S 50° W, 17.90 ft. dist., scribed ("X" BT).
- A Douglas Fir 6 1/4 in. diam. bears S 73° E, 19.80 ft. dist., scribed (T28N, R28W S10 BT).

Paint scribed faces red with 6 inch wide bands around all Bearing Trees.
Attached Bearing Tree and Attention Land Survey Monument signs to all Bearing Trees.
Set a steel post 6 ft. long, 2 ft. in the ground, S 3.00 ft. dist., with attached Property and Land Survey Monument decals.
Raise a collar of stone 2 ft. diam., 1 ft. high, around set monument.
Bury the original stone alongside the set alum. monument.

Declination: 18° East

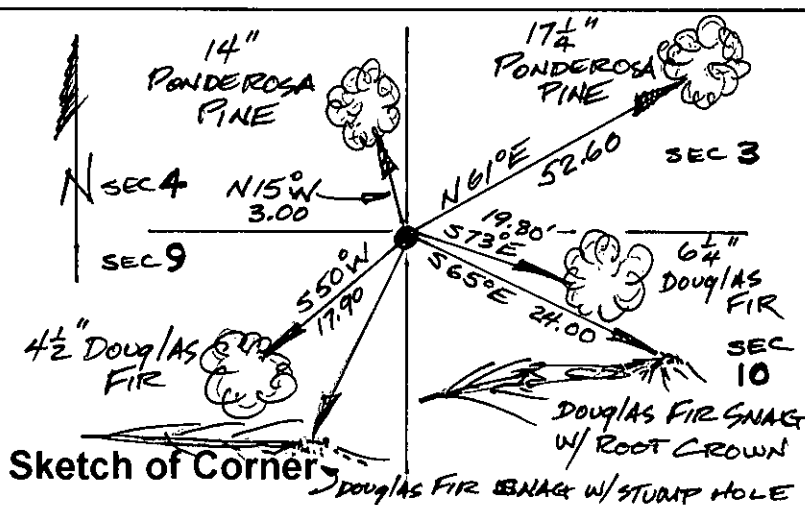

CERTIFICATION
I, John Damon
certify the information shown herein is true and correct
John Damon
Signature of Ground Party Chief
I, Kenneth E. Davis
certify that this Corner Record case was performed by me or under my direction in compliance with the "Corner Recordation Act" (78-2-101, et seq., M.C.A.)
Kenneth E. Davis
Signature of Surveyor & Seal
Date: _____ Reg. No. 4975 S
Employer: Davis Surveying, Inc.

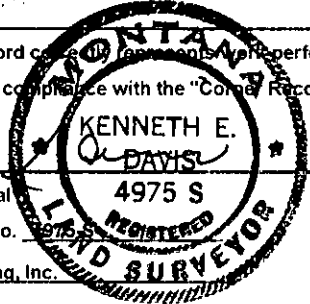

Office of Clerk and Recorder, County of Lincoln
This "corner record" was filed for record on 8-3-98
was noted on the cross-index plat and is assigned page No. 10145
in book No. _____
Coral M. Cummings
County Official

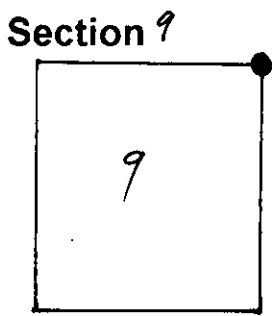

Cross Index No. 413 Sec. Cor. 910 T. 28 N., R. 28 W., PMM • THIS COR