

CERTIFIED CORNER RECORDATION

Corner	Sec. Cor	Sec.	NW S34	T.	28N	R.	27W	P.M., MT	Lincoln Flathead	County County
--------	----------	------	--------	----	-----	----	-----	----------	---------------------	------------------

- I. 1891 G.L.O. Original Record by Newton Orr: Set a post, 4 ft. long, 4 ins. square, 24 ins. in the ground for cor. to secs. 27, 28, 33, & 34, mkd. "T28N S27" on NE; "R27W S34" on SE; "S33" on SW, and "S28" on NW faces, with 1 notch on S. and 3 notches on E. edges. Established four bearing trees.
- II. No evidence found of original post, found one original bearing tree and one root crown,
from which:
- A larch root crown, bears N83°E, 40.9 ft. dist., no visible marks. (record-N78°E)
A larch, 14 ins. diam., bears S48°W, 16.5 ft. dist. "33" visible. (record-S41°W)
- III. By distance-distance intersect, using record distances from the original found bearing trees, set a 30 in. long, 3/4 in. diam. aluminum rod, with a 3 1/4 in. diam. aluminum cap, 24 ins. in the ground, mkd. as shown:

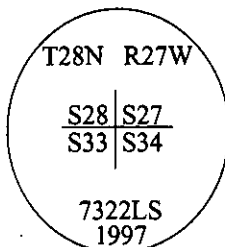

Established three new bearing trees:

- A larch, 7 ins. diam., bears N40°E, 68.20 ft. dist., mkd. "T28N R27W S27 BT".
A larch, 19 ins. diam., bears S83°E, 17.60 ft. dist., mkd. "T28N R27W S34 BT".
A larch, 8 ins. diam., bears N02°W, 48.1 ft. dist., mkd. "T28N R27W S28 BT".

Painted bearing trees and attached Land Survey Monument and Bearing Tree signs.

Magnetic Declination: 20° East.

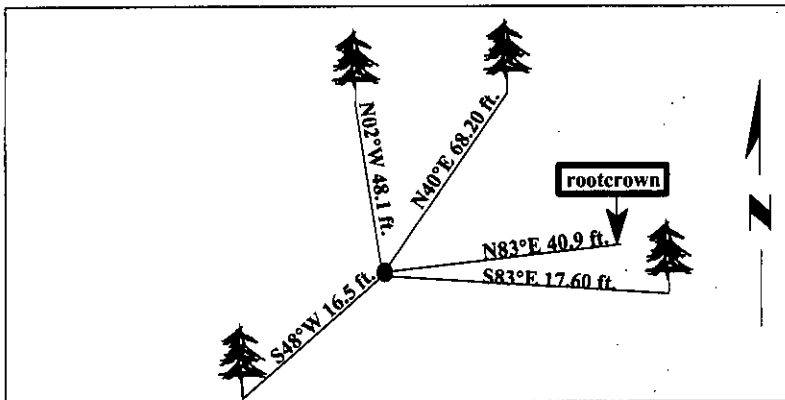

SKETCH OF CORNER

CERTIFICATION	
I. <u>Thomas M. Hommel</u>	certify the information shown herein is true and correct.
I. <u>Alvah F. Hughes</u>	certify that this Corner Record correctly represents work performed by me or under my direction in compliance with the "Corner Recordation Act" (70-22101, et seq., M.C.A.)
Date: <u>12/05/97</u>	Signature of Surveyor & Seal
Reg. No.: <u>7322LS</u>	
Employer: <u>U.S. FOREST SERVICE</u>	

Office of Clerk and Recorder, County of Lincoln. This "corner record" was filed for record on 12-26-97 and was noted on the cross-index plat and is assigned page No. 9998 in book No. _____.

County Official

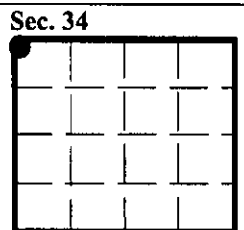

● - corner this sheet