

CERTIFIED CORNER RECORDATION

Corner N 1/16 Secs. 33&34 T. 28N R. 27W P.M., MT Lincoln Flathead County

- I. No history found.
- II. No evidence found.
- III. At the corner point, as determined by survey, set a 30 ins. long, 3/4 in. diam. aluminum rod, 22 ins. in the ground, with a 3 1/4 in. diam. aluminum cap, mkd. as shown.

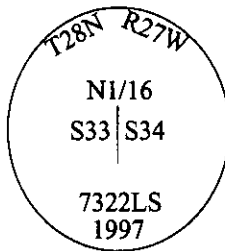

Established two new bearing trees:

- A fir, 6 ins. diam., bears N12°E, 18.5 ft. dist., mkd. "X" "BT".
- A larch, 11 ins. diam., bears N70°W, 47.6 ft. dist., mkd. "N1/16 S33 BT".

Set a 6 ft. galvanized steel guard post, bears East, 3.0 ft. dist., with Land Survey Monument and Property Boundary decals attached.
Painted bearing trees and attached Land Survey Monument and Bearing Tree signs.

Magnetic Declination: 20° East.

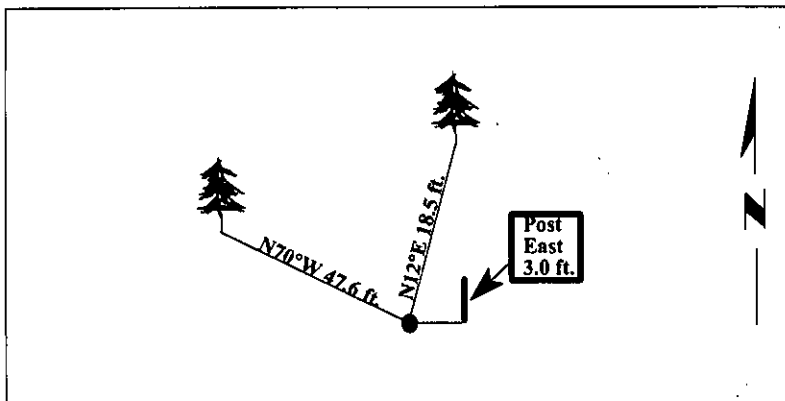

SKETCH OF CORNER

CERTIFICATION

I, Mark Federman
certify the information shown herein is true and correct.

I, Alvah F. Hughes
certify that this Corner Record correctly represents work performed by me or under my direction in compliance with the "Corner Recordation Act" (70-22-101, et seq., M.C.A.)

Alvah F. Hughes
Signature of Surveyor & Seal

Date: 12/05/97

Reg. No.: 7322LS

Employer: U.S. FOREST SERVICE

Office of Clerk and Recorder, County of Lincoln. This "corner record" was filed for record on 12-26-97 and was noted on the cross-index plat and is assigned page No. 999.7 in book No. _____

Carol M. Cummings By REB
County Official

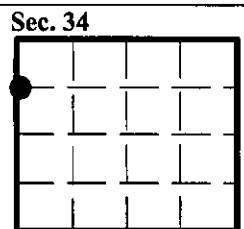

● - corner this sheet