

CERTIFIED CORNER RECORDATION

Corner SW CORNER SEC.28 T. 28N R. 27W P.M.M. County LINCOLN

RECORD G.L.O. : SET A LIMESTONE 15x8x8, 10" INTO THE GROUND WITH 1 NOTCH ON SOUTH AND 4 ON EAST, FROM WHICH:

12" TAMARACK BEARS N76°E 21.78' SCRIBED T28N R27W S28 BT..
12" TAMARACK BEARS S77°E 28.38' SCRIBED T28N R27W S33 BT..
12" TAMARACK BEARS S28°W 66.00' SCRIBED T28N R27W S32 BT..
7" FIR BEARS N32°W 116.16' SCRIBED T28N R27W S29 BT..

FOUND : B.L.M. 3 1/4" ALUM CAP STAMPED AS SHOWN, FROM WHICH:

22" TAMARACK BEARS N76°E 21.80' SCRIBE OVERGROWN.
17" TAMARACK BEARS S77°E 28.30' SCRIBED T28N R27W S33 BT..
8" FIR BEARS S59°E 26.40' SCRIBE OVERGROWN.
20" TAMARACK BEARS S16°W 66.20' SCRIBE OVERGROWN.
19" FIR BEARS N32°W 116.50' SCRIBE OVERGROWN.

MAINTENANCE:

PAINTED BT'S WITH A RED 6" BAND AND SCRIBE RED

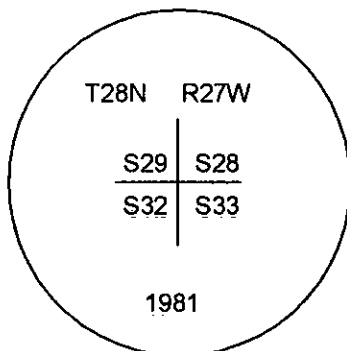
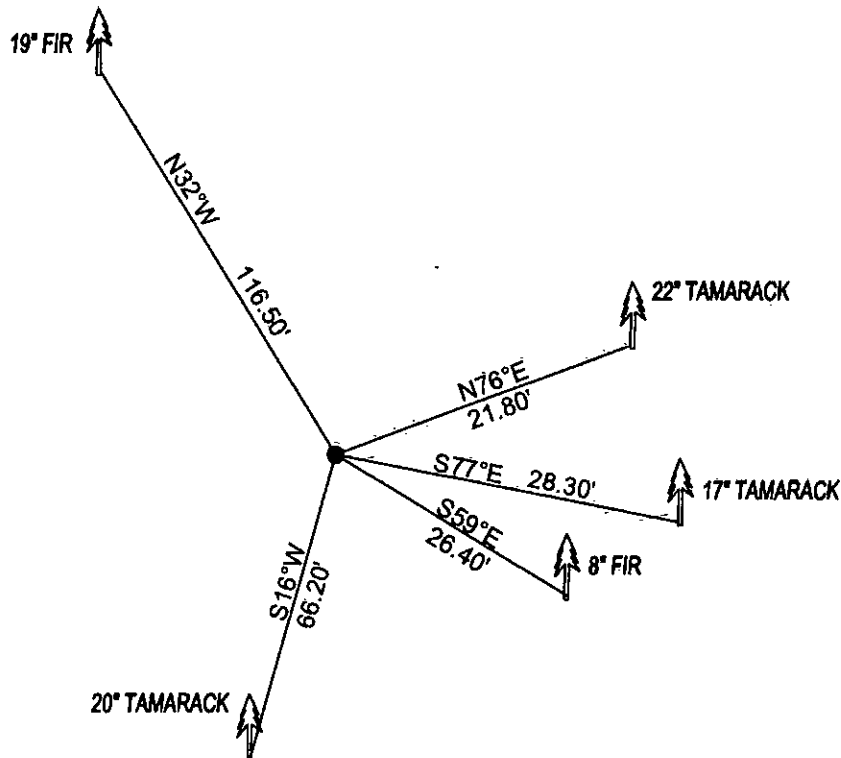

SKETCH OF CORNER

CERTIFICATION

I, DAN CROFT
certify the information shown herein is true and correct.

Signature Ground Party Chief

I, MARC J. CARSTENS
certify that this Corner Record correctly represents work
performed by me or under my direction in compliance with
the "Corner Recordation Act" (70-22-101 et seq., M.C.A.)

[Signature]
Signature of Surveyor & Seal



Date: 12-2010 Reg. No. 5940 LS

Employer: CARSTENS LAND SURVEYING

Office of Clerk and Recorder, County of LINCOLN This "corner

record" was filed for record on 230619 BOOK: CCR CC&R'S PAGE: 11745 Pages: 1

was noted on the cross-index plat: STATE OF MONTANA LINCOLN COUNTY
RECORDED: 01/05/2011 3:37 KOI: CC&R'S

book No. TAMMY D. LAUER CLERK AND RECORDER

FEE: \$0.00 BY: [Signature]
TO: CARSTENS LAND SURVEYING P.O. BOX 1374, POLSON, MONTANA

Cross Index No. V-09 T. 28N R. 27W PMM

Adopted July 1, 1981, Montana Board of Professional Engineers & Land Surveyors

Sec. 28

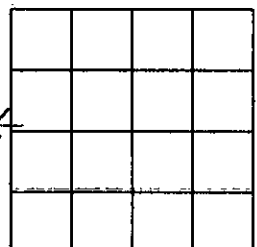

• corner this sheet