

CERTIFIED CORNER RECORDATION

Corner W1/4 CORNER SEC.28 T. 28N R. 27W P.M.M. County LINCOLN

RECORD G.L.O. : SET A WOOD POST 3 FEET LONG 3" SQ., WITH 1/4 S ON WEST FACE, FROM WHICH:
PITS 18x18x12 5 1/2' NORTH AND SOUTH OF CORNER.

FOUND : 5/8" REBAR WITH NO CAP, FROM WHICH:
5" PINE BEARS S55°E 8.30' WITH LOCATION POSTER ATTACHED..

MAINTENANCE:
PAINTED BT'S WITH A RED 6" BAND AND SCRIBE RED
SET 5 FOOT STEEL POST 2 FEET SOUTH FROM CORNER.

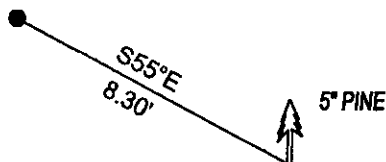

CERTIFICATION

DAN CROFT

certify the information shown herein is true and correct.

Signature Ground Party Chief

MARC J. CARSTENS

certify that this Corner Record correctly represents work performed by me or under my direction in compliance with the "Corner Recordation Act" (70-22-101, et seq., M.C.A.)

Marc J. Carstens
Signature of Surveyor & Seal



Date: 12-2010 Reg. No. 5940 LS

Employer: CARSTENS LAND SURVEYING

SKETCH OF CORNER

Office of Clerk and Recorder, County of LINCOLN . This "corner

record" was filed for record on 230617 BOOK: CCR CC&R'S PAGE: 11743 Pages: 1

was noted on the cross-index pl: STATE OF MONTANA LINCOLN COUNTY
RECORDED: 01/05/2011 3:32 KOI: CC&R'S

book No. TAMMY D. LAUER CLERK AND RECORDER
FEE: \$0.00 BY: Laurie Lauer Deputy
TO: CARSTENS LAND SURVEYING P.O. BOX 1374, POLSON, MONTANA

Cross Index No. T-09 T. 28N R. 27W PMM

Adopted July 1, 1981, Montana Board of Professional Engineers & Land Surveyors

Sec. 28

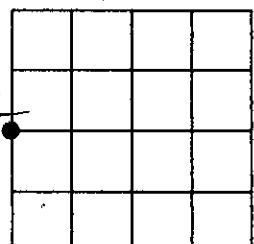

• corner this sheet