

# CERTIFIED CORNER RECORDATION

Corner S.C. Secs. 7 & 18 T. 28N R. 27W P.M., MT Lincoln County

I. 1891 G.L.O. Record by Newton Orr: A point about 300 feet below last sec. cor., set a limestone, 15x10x7 ins., 10 ins. in the ground, for cor. to secs. 7,12,13 and 18, mkd. with 2 notches on the N. and 4 notches on the S. edges. Established four bearing trees.

1902 Retracement Survey Record by Burton S. Adams et. al.: The cor. for secs. 7,12,13 and 18, which is a stone 10x7, 5 ins. above ground, mkd. and witnessed as described by the surveyor general, as this cor. will hereafter refer to secs. 7 and 18 only, I efface the marks from the S.W. and N.W. bearing trees.

1970 B.L.M. Record by Joseph E. French: The cor. of secs. 7 and 18, on the W. bdy. of the Tp., monumented with a limestone, 15x10x5 ins., firmly set, mkd. with 2 notches on the N. and 4 notches on the S. edges, and witnessed by the remains of the original bearing trees. At the corner point, set an iron post, 30 ins. long, 2 1/2 ins. diam., 24 ins. in the ground, with a brass cap, mkd. as shown.

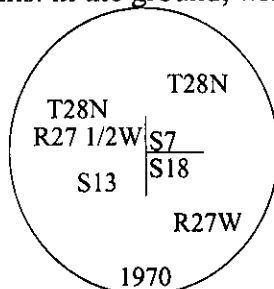

Established two new bearing trees and bury the original stone alongside the iron post.

II. Found a 2 1/2 in. diam. iron pipe, firmly set, protruding 6.5 ins. above the ground, with a 3 1/4 in. diam. brass cap, mkd. as shown, and witnessed by the remains of the original bearing trees and the B.L.M. bearing trees.

from which:

- A larch, 8 ins. diam., bears N11°E, 53.5 ft. dist., with visible scribe. (BLM-record)
- A down pine snag, 8 ins. diam., bears S26°E, 18.5 ft. dist., with visible scribe. (GLO-record)
- A larch, 9 ins. diam., bears S87°E, 30.4 ft. dist., with visible scribe. (BLM-record)
- A larch, 18 ins. diam., bears N30°W, 47.0 ft. dist., with visible face. (GLO-record)

III. Set one 6 ft. galvanized steel guard post, East, 3.0 ft. dist. of the corner, with Property Boundary and Land Survey Monument decals attached.

Painted bearing trees and attached Land Survey Monument and Bearing Tree signs.

Magnetic Declination: 20° East

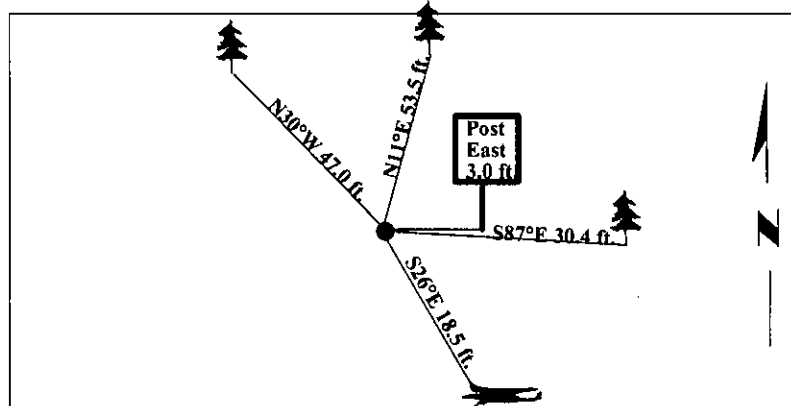

SKETCH OF CORNER

## CERTIFICATION

I. Mark Federman

certify the information shown herein is true and correct.

*Mark Federman*

I. Steven A. Boyer

certify that this Corner Record correctly represents work performed by me or under my direction in compliance with the "Corner Recordation Act" (70-22-101, et seq., M.C.A.)

*Steven A. Boyer*

Signature of Surveyor & Seal

Date: 6/15/98

Reg. No.: 9750LS

Employer: U.S. FOREST SERVICE

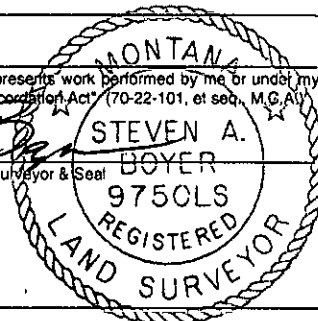

Sec. 18

Office of Clerk and Recorder, County of Lincoln. This "corner record" was filed for record on 10-6-98 and was noted on the cross-index plat and is assigned page No. 10231 in book No. \_\_\_\_\_.

*Coral M. Cummings*  
County Official

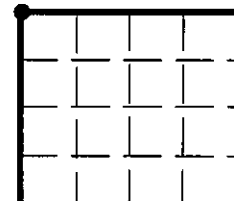

• - corner this sheet

Cross Index No. J-01

T. 28N R. 27W P.M., MT