

INSTRUCTIONS

1. Original and/or subsequent record used to evaluate the corner position.
2. Description of evidence found, note discrepancies in the record, state method of establishing lost or obliterated corners.
3. Description of monument and accessories set to perpetuate the corner position.
4. Sketch of corner, show all pertinent data which can best be shown in a sketch example, corner marking, topography ties, position of accessories, etc.
5. Certification must be signed and sealed by Land Surveyor registered in the State of Montana.
6. Fill in Cross Index & Section Diagram at bottom of sheet.

CERTIFIED CORNER RECORDATION

Corner of Secs. 13, 14, 23 & 24 T. 28 N., R. 27 1/2 W., Lincoln County

I. 1902 G.L.O. record by B. S. Adams and W. E. Weeks: Set a stone monument and marked four bearing trees.

1978 B.L.M. remonumentation record by L. A. Christiansen: "The cor. of secs. 13, 14, 23 and 24, monumented with a limestone, 18x10x8 ins., firmly set 12 ins. in the ground, mkd. with 1 notch on E. and 3 notches on S. edges, and witnessed by the original bearing trees:

- A larch, 12 ins. diam., bears N43° E, 39 lks. dist., with overgrown blaze. (record: N40 1/2° E).
- A pine, 12 ins. diam., bears S37 1/2° E, 27 lks. dist., marked T28N R27 1/2W S24 BT (record: S39 1/4° E).
- A pine, 14 ins. diam., bears S62° W, 43 lks. dist., marked T28N R27 1/2W S23 BT.
- A pine, 14 ins. diam., bears N65 3/4° W, 20 lks. dist., marked T28N R27 1/2W S14 BT.

At the corner point; set an iron post, 30 ins. long, 2 1/2 ins. diam., 22 ins. in the ground, with brass cap mkd.

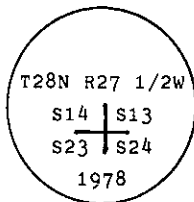

Bury the original stone alongside and raise a flat mound of stone, 3 ft. diam., around the iron post."

II. Found a 2 1/2 ins. diam. iron pipe, 12 ins. above ground with rock collar and B.L.M. 3 1/4 ins. diam. brass cap marked as shown above; from which

- A larch, 13 ins. diam., bears N40° E, 25.9 ft. (39 lks.) dist., healed face.
- A pine stump, 9 ins. diam., bears S39° E, 18.6 ft. (28 lks.) dist., mkd. 28 27 1/2 S24 BT on log laying alongside.
- A downed pine, 11 ins. diam., bears S62° W, 28.4 ft. (43 lks.) dist., mrk. T28N R27 1/2 S23 BT.
- A downed pine, 14 ins. diam., bears N66° W, 13.2 ft. (20 lks.) dist., scribe face down.

III. Established three new bearing trees:

- A larch, 12 ins. diam., bears S28° E, 32.9 ft. dist., mkd. T28N R27 1/2W S24 BT.
- A fir, 10 ins. diam., bears S32° W, 6.1 ft. dist., mkd. T28N R27 1/2W S23 BT.
- A fir, 16 ins. diam., bears N22° W, 22.0 ft. dist., mkd. T28N R27 1/2W S14 BT.

Painted red bands around the bearing trees and attached Land Survey Monument and Bearing Tree signs. Set a 6 ft. galvanized steel guard post with Land Survey Marker and Property Boundary decals, West, 4.3 ft.

Magnetic Declination: 20° East

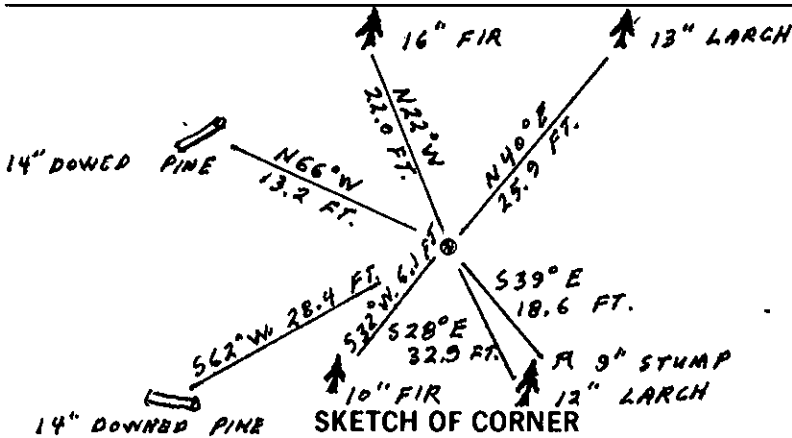

CERTIFICATION  
 I, Thomas A. Hommel certify the information shown herein is true and correct.  
 Signature Ground Party Chief  
 I, Ronald A. Pearson certify that this Corner Record correctly represents work performed by me or under my direction in compliance with the "Corner Recordation Act" (70-22-101, et seq., M.C.A.)  
 Signature of Surveyor & Seal  
 Date: 7/22/92 Reg. No. 9008 LS  
 Employer: U.S. FOREST SERVICE

Office of Clerk and Recorder, County of Lincoln. This "corner record" was filed for record on 8-13-92 was noted on the cross-index plat and is assigned page No. 5088, in book No. Coral M. Cummings

County Official

Sec. 13

N-21 28 N 27 1/2 W  
 Cross Index No. T. R. PMM

• - corner this sheet