

## INSTRUCTIONS

1. Original and/or subsequent record used to evaluate the corner position.
2. Description of evidence found, note discrepancies in the record, state method of establishing lost or obliterated corners.
3. Description of monument and accessories set to perpetuate the corner position.
4. Sketch of corner, show all pertinent data which can best be shown in a sketch example, corner marking, topography ties, position of accessories, etc.
5. Certification must be signed and sealed by Land Surveyor registered in the State of Montana.
6. Fill in Cross Index & Section Diagram at bottom of sheet.

## CERTIFIED CORNER RECORDATION

Corner 1/4 of Secs. 25 & 26 T. 28 N. R. 27 1/2 W. P.M.M. Lincoln County

I. 1902 G.L.O. record by B. S. Adams and W. B. Weeks: Marked a rock in place and marked two bearing trees.

1978 B.L.M. remonumentation record by L. A. Christiansen: "The 1/4 cor. of secs. 25 and 26, monumented with a rock in place, 20x12x5 ins. above ground, mkd. with an (x) at the cor. point, and 1/4 on the W. face, and witnessed by the original bearing trees:

A pine, 12 ins. diam., bears S43° E, 11 lks. dist., mkd. 1/4 S25 BT (Record: S46 1/2° E).

A fir, 20 ins. diam., bears N52° W, 8 lks. dist., with an overgrown blaze. (Record: N48 3/4° W)

At the corner point; set a brass tablet, 3 1/4 ins. diam., 3 1/2 in. stem, in solid rock, with top mkd.

T28N R27 1/2W  
1/4  
S26 S25  
1978

Raise a flat mound of stone, 3 ft. diam., around the brass tablet."

II. Found 3 1/4 ins. diam. B.L.M. brass tablet loose and laying on the ground; from which

A downed pine, 11 ins. diam., bears S46° E, 7.3 ft. (11 lks.) dist., mkd. 1/4 S2 BT.

A fir, 22 ins. diam., bears N50° W, 5.3 ft. (8 lks.) dist., healed face.

III. Set by distance - distance intersection from found bearing trees; a 2 1/2 ins. diam. aluminum pipe, 30 ins. long, 19 ins. in the ground with 3 1/4 ins. diam. aluminum cap, marked as shown:

T28N R27 1/2W  
1/4  
S26 S25  
9008LS  
1992

from which (marked one new bearing tree):

A pine, 11 ins. diam., bears S78° E, 11.1 ft. dist., mkd. 1/4 S25 BT.

Painted red bands around the bearing trees and attached Land Survey Monument and Bearing Tree signs.

Raise a collar of stone around aluminum monument.

Set a 6 ft. galvanized steel guard post with Land Survey Marker and Property Boundary decals, West, 2.5 ft.

Magnetic Declination: 20° East

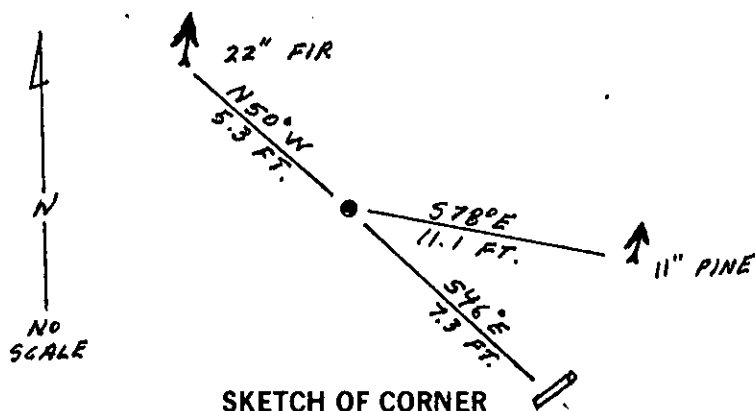

SKETCH OF CORNER

## CERTIFICATION

I, Thomas A. Hommes  
certify the information shown herein is true and correct.

Signature Ground Party Chief

Ronald A. Pearson

I, Ronald A. Pearson  
certify that this Corner Record correctly represents work performed by me or under my direction in compliance with the "Corner Recordation Act" (70-22-101, et seq., M.C.A.)

Signature of Surveyor & Seal

Date: 7/22/92 Reg. No. 9008 LS

Employer: U.S. FOREST SERVICE

Office of Clerk and Recorder, County of Lincoln. This "corner record" was filed for record on 8-13-92 was noted on the cross-index plat and is assigned page No. 5086, in book No. Corral M. Chambers

County Official

T-21

28 N 27 1/2 W

Cross Index No. \_\_\_\_\_ T. \_\_\_\_\_ R. \_\_\_\_\_ PMM

Sec25

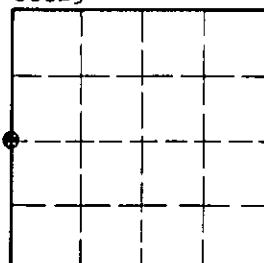

• - corner this sheet