

INSTRUCTIONS

1. Original and/or subsequent record used to evaluate the corner position.
2. Description of evidence found, note discrepancies in the record, state method of establishing lost or obliterated corners.
3. Description of monument and accessories set to perpetuate the corner position.
4. Sketch of corner, show all pertinent data which can best be shown in a sketch example, corner marking, topography ties, position of accessories, etc.
5. Certification must be signed and sealed by Land Surveyor registered in the State of Montana.
6. Fill in Cross Index & Section Diagram at bottom of sheet.

CERTIFIED CORNER RECORDATION

Corner 1/4 of Secs. 14 & 23 T. 28 N. R. 27 1/2 W. P.M.M. Lincoln County

I. 1902 G.L.O. record by B. S. Adams and W. B. Weeks: Set a stone monument and marked two bearing trees.

1978 B.L.M. remonumentation record by L. A. Christiansen: "The 1/4 cor. of secs. 14 and 23, monumented with a limestone, 15x12x4 ins. loosely set 10 ins. in the ground, mkd. 1/4 on the N. face, and witnessed by the original bearing trees:

A pine, 12 ins. diam., bears S2 1/2° W, 16 lks. dist., mkd. 1/4 S23 BT.

A pine, 7 ins. diam., bears N84° W, 28 lks. dist., mkd. 1/4 S14 BT. (Record: N48° W)

At the corner point; set an iron post, 30 ins. long, 2 1/2 ins. diam., 22 ins. in the ground, with brass cap mkd.

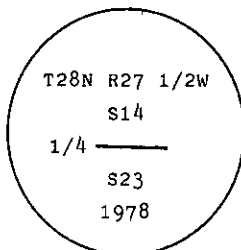

Bury the original stone alongside and raise a flat mound of stone, 2 1/2 ft. diam., around the iron post.

II. Found a 2 1/2 ins. diam. iron pipe, 10 ins. above ground with rock collar, 3 1/4 ins. diam. B.L.M. brass cap, mkd. as shown above; from which

A dead pine, 11 ins. diam., bears S2 1/2° W, 10.9 ft. (16 lks.) dist., mkd. 1/4 S23 BT

A downed pine, 7 ins. diam., bears N84° W, 18.5 ft. (28 lks.) dist., mkd. 1/4 S14 BT.

III. Established two new bearing trees:

A fir, 7 ins. diam., bears S12° W, 19.6 ft. dist., mkd. 1/4 S23 BT.

A fir, 7 ins. diam., bears N83° W, 29.0 ft. dist., mkd. 1/4 S14 BT.

Painted red bands around the bearing trees and attached Land Survey Monument and Bearing Tree signs.

Set a 6 ft. galvanized steel guard post with Land Survey Marker and Property Boundary decals, East, 3.6 ft.

Magnetic Declination: 20° East

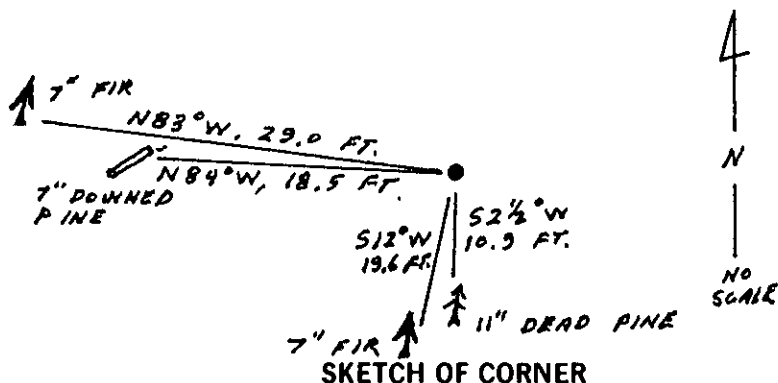

CERTIFICATION

I, Thomas A. Hommel
certify the information shown herein is true and correct.

Signature Ground Party Chief
Ronald A. Pearson

I, Ronald A. Pearson
certify that this Corner Record correctly represents work performed by me or under my direction in compliance with the "Corner Recordation Act" (70-22-101 et seq., M.C.A.)

Signature of Surveyor & Seal
Ronald A. Pearson

Date: 7/22/92 Reg. No. 9008 LS

Employer: U.S. FOREST SERVICE

Office of Clerk and Recorder, County of Lincoln. This "corner record" was filed for record on 8-13-92 was noted on the cross-index plat and is assigned page No. 5082, in book No.

N-19 28 N 27 1/2 W
Cross Index No. T. R. PMM

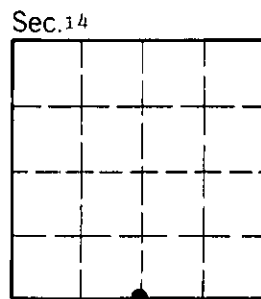

• - corner this sheet