

INSTRUCTIONS

1. Original and/or subsequent record used to evaluate the corner position.
2. Description of evidence found, note discrepancies in the record, state method of establishing lost or obliterated corners.
3. Description of monument and accessories set to perpetuate the corner position.
4. Sketch of corner, show all pertinent data which can best be shown in a sketch example, corner marking, topography ties, position of accessories, etc.
5. Certification must be signed and sealed by Land Surveyor registered in the State of Montana.
6. Fill in Cross Index & Section Diagram at bottom of sheet.

CERTIFIED CORNER RECORDATION

Corner 1/4 of Secs. 13 & 24 T. 28 N. R. 27 1/2 W. P.M.M. Lincoln County

I. 1902 G.L.O. record by B. S. Adams and W. B. Weeks: Set a stone monument and marked two bearing trees.

1970 B.L.M. remonumentation record by J. E. French: "The 1/4 cor. of secs. 13 and 24, monumented with a limestone, 15x12x10 ins. loosely set, mkd. 1/4 on the N. face, and witnessed by the original bearing trees:

A stump hole, bears S26 1/4° W, 83 lks. dist., with a fallen fir, 20 ins. diam., mkd.
with an overgrown blaze, lying alongside.
A larch, 24 ins. diam., bears N4 1/4° W, 42 lks. dist., mkd. 1/4 S BT.

At the corner point; set an iron post, 30 ins. long, 2 1/2 ins. diam., 24 ins. in the ground,
with brass cap mkd.

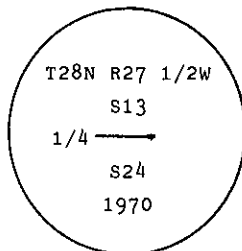

from which a new bearing tree:

A fir, 11 ins. diam., bears S69 1/2° E, 18 lks. dist., mkd. 1/4 S24 BT.

Bury the original stone alongside the iron post.

II. Found a 2 1/2 ins. diam. iron pipe, 6 ins. above ground with rock collar and 3 1/4 ins. diam.
B.L.M. brass cap, mkd. as shown above; from which

A larch, 26 ins. diam., bears N4° W, 27.9 ft. (42 lks.) dist., visible scribe. (G.L.O.)
A fir, 12 ins. diam., bears S69° E, 11.8 ft. (18 lks.) dist., mkd. 1/4 S24 BT. (B.L.M.)
A downed fir, 24 ins. diam., bears S26° W, 54.8 ft. (83 lks.) dist., scribe face down. (G.L.O.)

III. Painted red bands around the bearing trees and attached Land Survey Monument and Bearing Tree signs.

Set a 6 ft. galvanized steel guard post with Land Survey Marker and Property Boundary decals,
South, 3 ft.

Magnetic Declination: 20° East

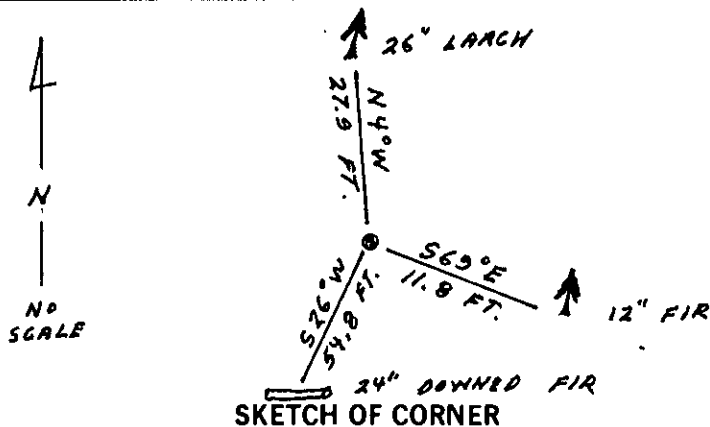

CERTIFICATION

I, Thomas A. Hommel
certify the information shown herein is true and correct.

Signature Ground Party Chief

I, Ronald A. Pearson
certify that this Corner Record correctly represents work performed
by me or under my direction in compliance with the "Corner
Recordation Act" (70-22-101, et seq., M.C.A.)

Signature of Surveyor & Seal

Date: 7/22/92 Reg. No. 9008 LS

Employer: U.S. FOREST SERVICE

Office of Clerk and Recorder, County of Lincoln. This "corner
record" was filed for record on 8-13-92
was noted on the cross-index plat and is assigned page No. 5081, in
book No. Coral M. Cummings

County Official

N-23

28 N 27 1/2 W

Cross Index No. T. R. PMM

Sec.13

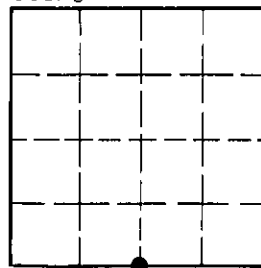

• - corner this sheet