

CERTIFIED CORNER RECORDATION

CORNER NE1/16 SEC. 24 , T. 28N , R. 27 1/2W , P.M.M., LINCOLN COUNTY

RECORD: NONE

FOUND: NOTHING.

MAINTENANCE: REMOVED BRUSH AND TREE LIMBS FROM CORNER AREA AND SET 5/8"X24" REBAR WITH YPC, FROM WHICH;
 24" LARCH BEARS N48°E 8.40' SCRIBED RM.
 SET 5 FOOT STEEL POSTS 2 FEET SOUTH AND 2 FEET WEST OF CORNER.
 ATTACHED BY TAG'S AND PAINTED 6" BAND ON BT.

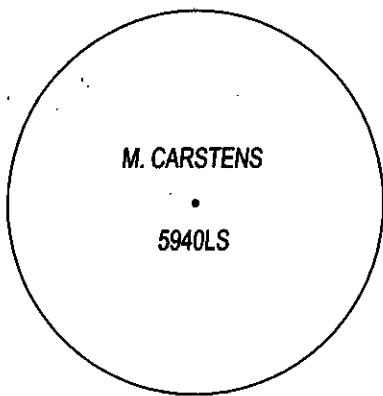
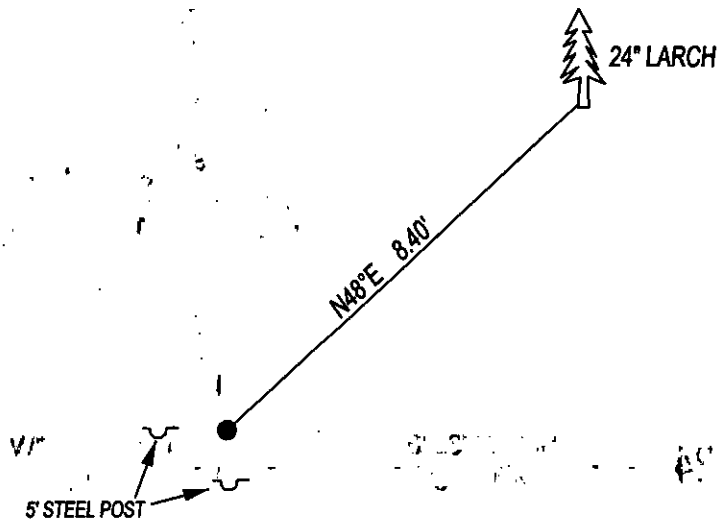

SKETCH OF CORNER

CERTIFICATION

I, DAN CROFT
 CERTIFY THE INFORMATION SHOWN HEREIN IS TRUE AND CORRECT.

SIGNATURE GROUND PARTY CHIEF

I, MARC J. CARSTENS
 CERTIFY THAT THIS CORNER RECORD CORRECTLY REPRESENTS WORK
 PERFORMED BY ME OR UNDER MY DIRECTION IN COMPLIANCE WITH THE
 "CORNER RECORDATION ACT" (70-22-101, ET SEQ., M.C.A.)



 SIGNATURE OF SURVEYOR & SEAL

07-26-13

DATE

CARSTENS SURVEYING

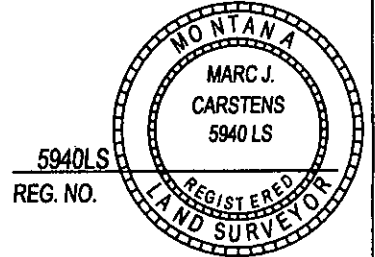
EMPLOYER

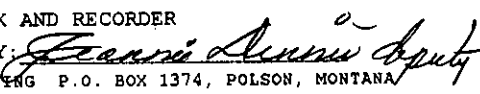

OFFICE OF CLERK AND RECORDER, COUNTY OF LINCOLN
 THIS "CORNER RECORD" WAS FILED FOR RECOI 246498 BOOK: CCR CC&R'S PAGE: 12060 Pages: 2
 WAS NOTED ON TH STATE OF MONTANA LINCOLN COUNTY
 AND IS ASSIGNED PAGE NO. _____, IN BOC RECORDED: 07/30/2013 11:00 KOI: CC&R'S

COUNTY OFFICIAL
 TAMY D. LAUER CLERK AND RECORDER
 FEE: \$0.00 BY: 
 FOR: CARSTENS LAND SURVEYING P.O. BOX 1374, POLSON, MONTANA

CROSS INDEX NO. O-24 T. 28N , R. 27 1/2W , P.M.M.

ADOPTED JULY 1, 1981, MONTANA BOARD OF PROFESSIONAL ENGINEERS & LAND SURVEYORS

SEC. 24

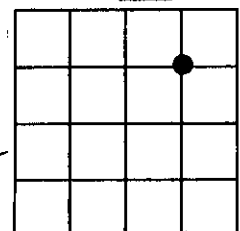

● CORNER THIS SHEET

