

STATE OF MONTANA LINCOLN COUNTY
RECORDED: 12/17/2004 8:33 KOI: CC&R'S
CORAL M. CUMMINGS CLERK AND RECORDER
FEE: \$0.00 BY: _____
TO: FILED

CERTIFIED CORNER RECORDATION

Corner NW cor. S 36 T 28 N. R. 27 1/2 W. P.M.M. LINCOLN County

I. Record: 1902 - GLO survey by Burton S. Adams and Wm. C. Weeks, set a limestone 18x10x6 ins., 12 ins. in the ground, marked with 1 notch on the South edge and 1 notch on the East edges from which:

- A Larch, 20 ins. diam., bears N62°45'E. 5 lks. (3.30 ft), mkd. T28N R271/2W S25 BT.
- A Fir, 10 ins. diam., bears S51°E. 33 lks. (21.78 ft), mkd. T28N R271/2W S36 BT.
- A Fir, 20 ins. diam. bears S7°45'W. 77 lks. (50.82 ft), mkd. T28N R271/2W S35 BT.
- A Fir, 12 ins. diam., bears N66°30'W. 20 links (13.20 ft), mkd. T28N R271/2W S26 BT.

1978 BLM Remoumention by Christiasen: Set an iron post, 30 ins. long, 2 1/2 ins. diam., 22 ins. in the ground, with brass cap mkd. as shown below from which:

- A pine, 14 ins. diam., bears N.4°E., 65 lks. dist., mkd. T28 R271/2W S25 BT.
- A fir, 7 ins., diam., bears S. 54°E., 58 lks., dist., mkd. T28 R271/2W S36 BT.
- A fir, 10 ins. diam., bears S. 33°W., 16 lks., dist., mkd. T28 R271/2W S35 BT.

II. Found: A 3 1/4 diam. BLM brass cap on a 2 1/2 in. diam. iron pipe firmly set from which:

- A pine, 16 ins. diam., bears N.4°E., 42.90 ft. with visible scribing.
- A fir, 12 ins. diam., bears S.54°E., 38.28 ft. dist. with visible scribing.
- A fir, 12 ins. diam., bears S.33°W., 10.56 ft. dist. with visible scribing.
- A Larch stump, 22 ins. diam., bears N.62°E., 33.66 ft. dist. with overgrown face.
- A fir snag, 30 ins. diam., bears S.7°W., 50.82 ft. dist. with overgrown face.

III. Perpetuation:

Painted faces and 6 in. wide red bands to all bearing trees and attached bearing tree and Land Survey Monument signs.

Magnetic declination: 20° East assumed

Equipment used: Hand compass and loggers tape

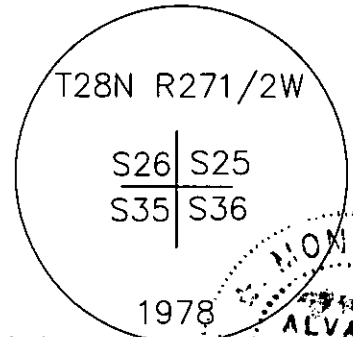

Kootenai Surveyors Inc., 314 California Av., Libby, MT. 59923 (406) 293-4354

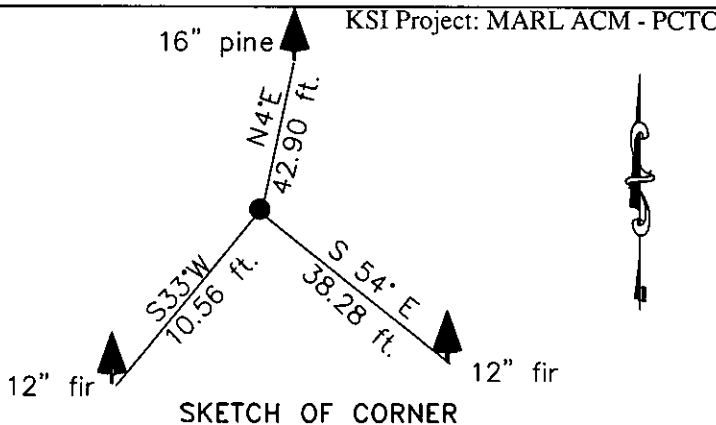

CERTIFICATION
 I, Doug Schuhknecht
 certify the information shown herein is true and correct.
 Signature Ground Party Chief
 I, Alvah F. Hughes
 certify that this Corner Record correctly represents work performed by me or under my direction in compliance with the "Corner Recordation Act" (70-22-101, et seq., M.C.A.)
 Signature of Surveyor & Seal
 Date: 12/1/2004 Reg. No. 7322-LS
 Employer: Kootenai Surveyors Inc.

Office of Clerk and Recorder, County of Lincoln This "corner

record" was filed for recor
was noted on the cross-ir
book No. _____

181332 BOOK: CCR CC&R'S PAGE: 10728 Pages: 1
 STATE OF MONTANA LINCOLN COUNTY
 RECORDED: 12/17/2004 8:33 KOI: CC&R'S
 CORAL M. CUMMINGS CLERK AND RECORDER
 FEE: \$0.00 BY: Cornie Dennis
 TO: FILED

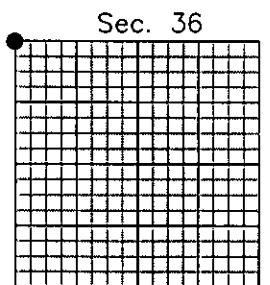

Cross Index No. V 21 T. 28 R. 271/2W P.M., MT