

# CERTIFIED CORNER RECORDATION

Corner C.C. Secs. 12 & 13 T. 28N R. 27 1/2W P.M., MT Lincoln County

- I. 1902 G.L.O. Record by Burton S. Adams et. al.: Intersect E. bdy. of Tp., 1.68 chs., N0°14'W of the cor. of secs. 7 and 18, heretofore described, set a limestone, 15x10x8 ins., 10 ins. in the ground, for closing corner of secs. 12 and 13, mkd. "C.C." on W., with 4 grooves on S. and 2 grooves on the N. faces. Established two bearing trees.

1970 Certified Corner Recordation by Stanley J. Skousen, 2532-S: For the closing corner, common to secs. 12 and 13, found original stone, firmly set, mkd. as described in the surveyor general, and witnessed by the original bearing trees. Established one new bearing tree, mkd. with an "RM".

1978 B.L.M. Remonumentation Record by Larry Christiansen et. al.: The closing cor. of secs. 12 and 13, on the E. bdy. of the Tp., monumented with a granite stone, 15x10x8 ins., firmly set 10 ins. in the ground, mkd. with 2 grooves on the N. and 4 grooves on the S., and "CC" on the W. faces. and witnessed by the original bearing trees and the reference monument established by the Forest Service in 1970. At the corner point, set an iron poost, 30 ins. long, 2 1/2 ins. diam., 22 ins. in the ground, with brass cap mkd. as shown.

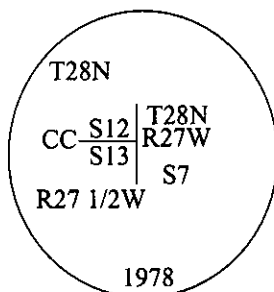

Buried the original stone alongside the iron post.

- II. Found a 2 1/2 in. diam. iron pipe, firmly set, protruding 1.2 ft. above the ground, with a 3 1/4 in. diam. brass cap, mkd. as shown, and witnessed by the remains of the original bearing trees and the reference monument set in 1970.

from which:

- A down pine, 11 ins. diam., bears S41°W, 52.8 ft. dist., with visible scribe. (GLO-record)
- A larch, 10 ins. diam., bears S83°W, 18.4 ft. dist., with visible scribe. (1970-record)
- A larch, 16 ins. diam., bears N75°W, 26.4 ft. dist., with visible scribe. (GLO-record)

- III. Set one 6 ft. galvanized steel guard post, North, 3.0 ft. dist. of the corner, with Property Boundary and Land Survey Monument decals attached.  
Painted bearing trees and attached Land Survey Monument and Bearing Tree signs.

Magnetic Declination: 20° East

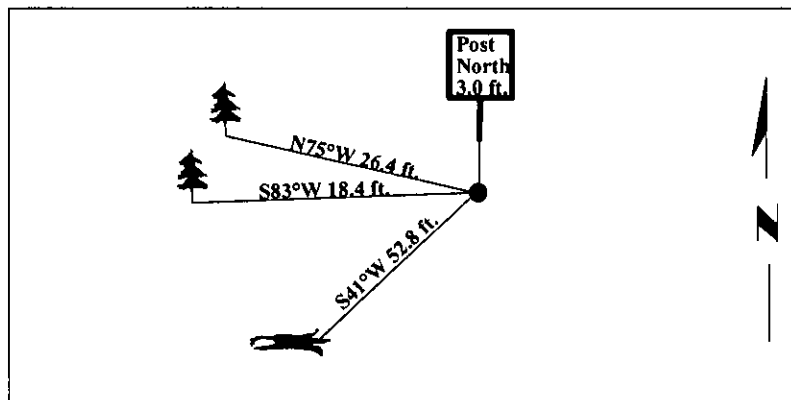

SKETCH OF CORNER

## CERTIFICATION

I, Mark Federman  
certify the information shown herein is true and correct.

I, Steven A. Boyer  
certify that this Corner Record correctly represents work performed by me or under my direction in compliance with the "Corner Recordation Act" (70-22-101, et seq., M.C.A.)

Steven A. Boyer  
Signature of Surveyor & Seal

Date: 6/15/98

Reg. No.: 9750LS

Employer: U.S. FOREST SERVICE

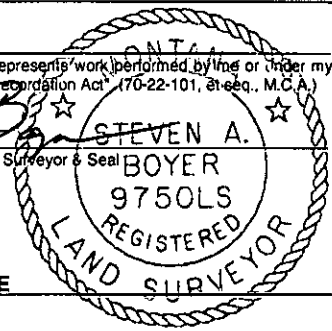

Sec. 13

Office of Clerk and Recorder, County of Lincoln. This "corner record" was filed for record on 10-6-98 and was noted on the cross-index plat and is assigned page No. 10233 in book No. \_\_\_\_\_.

Coral M. Cumming By RLB  
County Official

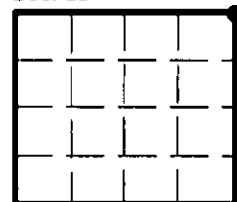

● - corner this sheet

# CERTIFIED CORNER RECORDATION

Corner C.C. Secs. 1 & 12 T. 28N R. 27 1/2W P.M., MT Lincoln County

- I. 1902 G.L.O. Record by Burton S. Adams et. al.: Intersect E. bdy. of Tp., 2.64 chs., N. of the cor. of secs. 6 and 7, heretofore described, set a granite stone, 20x10x8 ins., 15 ins. in the ground, for closing corner of secs. 1 and 12, mkd. "C.C." on W., with 5 grooves on the S. and 1 groove on the N. faces. Established two bearing trees.

1978 B.L.M. Remonumentation Record by Larry Christiansen et. al.: The closing cor. of secs. 1 and 12, on the E. bdy. of the Tp., monumented with a granite stone, 20x10x8 ins., firmly set, 15 ins. in the ground, mkd. with 1 groove on the N. and 5 grooves on the S., and "CC" on the W. faces. and witnessed by the original bearing trees. At the corner point, set an iron post, 30 ins. long, 2 1/2 ins. diam., 22 ins. in the ground, with brass cap mkd. as shown.

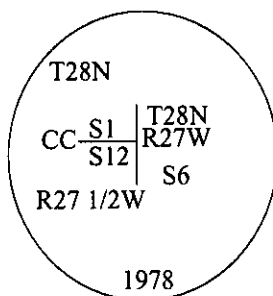

Buried the original stone alongside and raise a flat mound of stone, 3.0 ft. diam., around the iron post.

- II. Found a 2 1/2 in. diam. iron pipe, firmly set, protruding 5 ins. above the ground, with a 3 1/4 in. diam. brass cap, mkd. as shown, and witnessed by the original bearing trees.

from which:

A fir, 22 ins. diam., bears S70°W, 50.8 ft. dist., with a healed face. (GLO-record)

A fir, 25 ins. diam., bears N64 1/2°W, 29.0 ft. dist., with a healed face. (GLO-record)

- III. Painted bearing trees and attached Land Survey Monument and Bearing Tree signs.

Magnetic Declination: 20° East

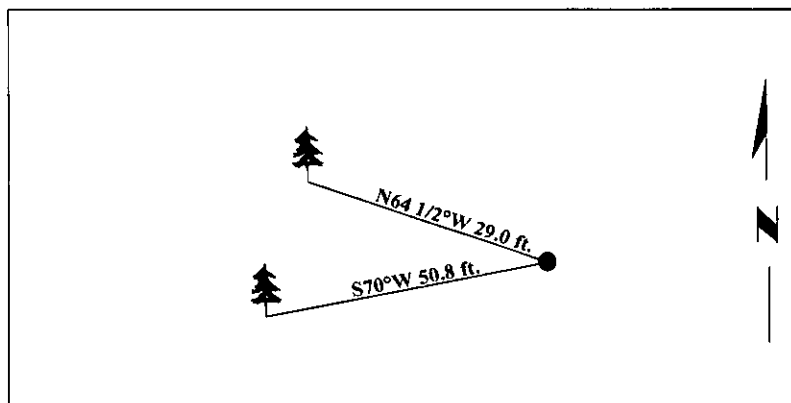

SKETCH OF CORNER

## CERTIFICATION

I. Mark Federman

certify the information shown herein is true and correct.

*Mark Federman*

I. Steven A. Boyer

certify that this Corner Record correctly represents work performed by me or under my direction in compliance with the "Corner Recordation Act" (70-22-101, et seq., M.C.A.)

*Steven A. Boyer*

Signature of Surveyor & Seal

Date: 6/15/98

Reg. No.: 9750LS

Employer: U.S. FOREST SERVICE

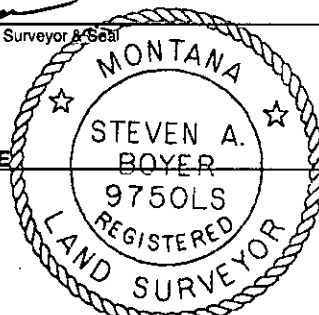

Sec. 12

Office of Clerk and Recorder, County of Lincoln. This "corner record" was filed for record on 10-6-98 and was noted on the cross-index plat and is assigned page No. 10233 in book No. \_\_\_\_\_

*Coral M. Cummings by RLB*  
County Official

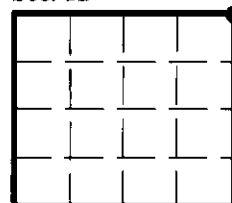

• - corner this sheet