

# CERTIFIED CORNER RECORDATION

Corner **MS 7682 COR. 1** Sec. 2 T. 27N R. 31W P.M., MT. Lincoln County  
**MS 8993 COR. 2**

I. 1905 Original Mineral Survey No. 7682 by Nimrod E. Jenkins: Cor. No. 1. Set a post 4 ft. long, 4 ins. square, 2 ft. in the ground scribed 1-7682, from which:

A blazed tamarack, 14 ins. diam., bears N 80°E, 9.8 ft. dist., scribed 1-7682 B.T.  
A blazed pine, 24 ins. diam., bears S 33°E, 23.0 ft. dist., scribed 1-7682 B.T.

1909 Original Mineral Survey No. 8993 by Arthur B. Lee et al: Cor. No. 2, identical with the S.E. Loc. Cor. and Cor. No. 1 of Mineral Survey No. 7682 Eldorado Placer. A tamarack post, 4 ft. long, 4 ins. sq., 2 ft. in the ground with a mound of earth, scribed 2-8993.

A blazed tamarack, 12 ins. diam., bears S 20°W, 15.8 ft. dist., scribed B.T. 2-8993.  
A blazed cedar, 8 ins. diam., bears N 30°W, 11.9 ft. dist., scribed B.T. 2-8993.

II. Found the remains of the original bearing trees, however no evidence of original corner post was found.

A down dead larch, 10 ins. diam., bears N 70°E, 9.3 ft. dist., face visible, no scribe marks (rec. N80°E, ).  
A pine, 24 ins. diam., bears S 33°E, 23.0 ft. dist., visible scribe.  
A larch, 12 ins. diam., bears S 30°W, 15.2 ft. dist., visible scribe. (rec. S20°W, 15.8 ft. dist.).  
A cedar stump, 16 ins. diam., bears N 46°W, 11.9 ft. dist., no visible scribe. (rec. N30°W, ).

III. Reestablished the corner by distance-distance intersection from the remains of the original bearing trees. Set a 2 1/2 in. diam., 30 in. long alum pipe, 21 ins. in the ground, with a 3 1/4 in. diam. alum. cap mkd. as shown.

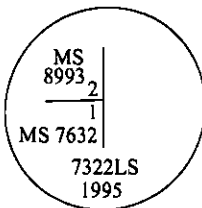

Established two new bearing trees:

A fir, 8 ins. diam., bears S 62°E, 17.2 ft. dist., mkd. 1-7682 B T.  
A fir, 7 ins. diam., bears S 3°E, 18.4 ft. dist., mkd. 1-7682 B T.

Painted red bands around the bearing trees and attached Land Survey Monument and Bearing Tree signs.

Magnetic Declination: 20° East.

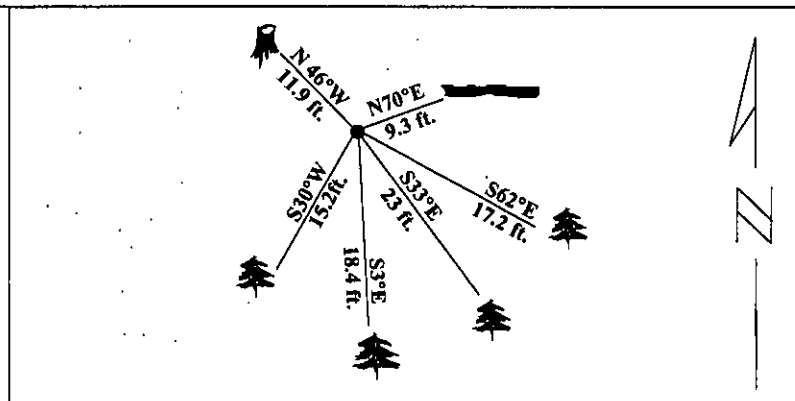

SKETCH OF CORNER

CERTIFICATION	
I. <u>Thomas M. Hommel</u>	certify the information shown herein is true and correct.
<i>Thomas M. Hommel</i>	
Signature Ground Party Chief	
I. <u>Alvah F. Hughes</u>	certify that this Corner Record correctly represents work performed by me or under my direction in compliance with the "Corner Recordation Act" (70-12101, et seq., M.C.A.)
<i>Alvah F. Hughes</i>	
Signature of Surveyor & Seal	
Date: <u>1/17/96</u>	
Reg. No.: <u>7322LS</u>	
Employer: <u>U.S. FOREST SERVICE</u>	

Office of Clerk and Recorder, County of LINCOLN. This "corner record" was filed for record on JULY 25, 1997 was noted on the cross-index plat and is assigned page No. 9684 in book No. CORAL M. CUMMINGS By DLR

County Official

Sec. 1

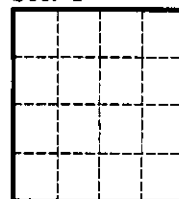

• - corner this sheet

Cross Index No Cor. 1 M.S. 7682 & 2 M.S. 8993 T. 27N R. 31W P.M.