

INSTRUCTIONS

1. Original and/or subsequent record used to evaluate the corner position.
2. Description of evidence found, note discrepancies in the record, state method of establishing lost or obliterated corners.
3. Description of monument and accessories set to perpetuate the corner position.
4. Sketch of corner, show all pertinent data which can best be shown in a sketch example, corner marking, topography ties, position of accessories, etc.
5. Certification must be signed and sealed by Land Surveyor registered in the State of Montana.
6. Fill in Cross Index & Section Diagram at bottom of sheet.

CERTIFIED CORNER RECORDATION

Corner No. 8 JOHNSTONE PLACER T. 27 N. R. 31 W. P.M.M. Lincoln County
M.S. No. 8797 unsurveyed

Record No. 1 Mineral Survey No. 8797 by Arthur B. Young, March 1908
Set a Fir post 4" square, 4 ft. long, 1 1/2 ft. deep,
scribed 8-8797, raised a mound of earth and stone around
post.
Blazed Fir 18" dia., scribed BT 8-8797, bears
S. 42°30' W., 58.6 ft.
Blazed Fir 16" dia., scribed BT 8-8797, bears
S. 34°15' E., 63.3 ft.

Record No. 2 Certified Land Corner Recordation, by Stanley J. Skousen,
Surveyor and A. R. Trenkle, Party Chief, Nov. 1970, filed
April 20, 1971.

Found rotted remains of original corner post.
Found 20" Fir snag, bears S. 43°30' W. 58.6 ft. with all
scribing visible.
Found 16" Fir down and rotted, bears S. 34°15' E. 63.3 ft.

Set a 2" dia. galv. iron pipe, 24" in the ground at the
exact center point of the original wooden post, with
brass cap stamped:

(new BT) Spruce 6" dia., bears S. 68 $\frac{1}{2}$ ° W., 13.1 ft., mrkd RM
(new BT) D. Fir 8" dia., bears N. 64 $\frac{1}{2}$ ° W., 15.8 ft., mrkd RM

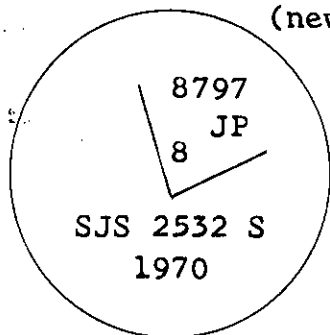

Found Found corner as monumented and restored and reported by
Skousen, April 1971 recordation (Record No. 2)

I visited and used this corner in my surveying on
September 28, 1989.

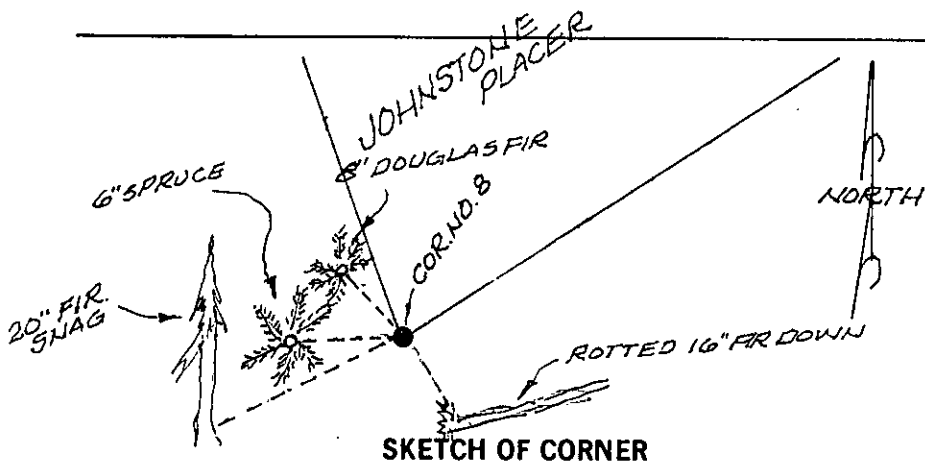

SKETCH OF CORNER

CERTIFICATION	
1. Richard C. Skinner	certify the information shown herein is true and correct.
Signature Ground Party Officer	
1. Robert A. Brown	certify that this Corner Record correctly represents work performed by me or under my direction in compliance with the Montana Corner Recordation Act" (70-22-101, et seq., M.C.A.)
Signature of Surveyor & Seal	
Date: 2/6/90	Reg. No. 10009 LS
Employer: Skinner & Associates	

Office of Clerk and Recorder, County of Lincoln. This "corner
record" was filed for record on Feb 28, 1990

was noted on the cross-index plat and is assigned page No. 4228, in
book No. _____

Janet BT Signed by Bill Smith
County Official

Sec.				

Cross Index No. _____ T. _____ R. _____ P.M.M.

• - corner this sheet